



RC2-A(P)-Z Series

RC2-A(P)-Z Series Screw Compressor



RC2-A (P) -Z Series Compressor

Product Description

Hanbell RC-A(P)-Z series compressor is developed with High-efficient water cooling system and suitable for low medium temperature working conditions such as freeze, refrigeration, ocean fishing, cold chain logistics, ice-making system etc.



Now whole series have over 20 models with the capacity range from 98 m³/h to 929 m³/h. This technical data only contains RC2-A(P)Z design features, model specifications, operating range, configuration list, suction and discharge connector, performance data, appearance chart; if you need the information about design, installation, maintenance, accessories, application system and basic troubleshooting, please read Hanbell RC2-A(P)-Z Technical Manual.

Nomenclature

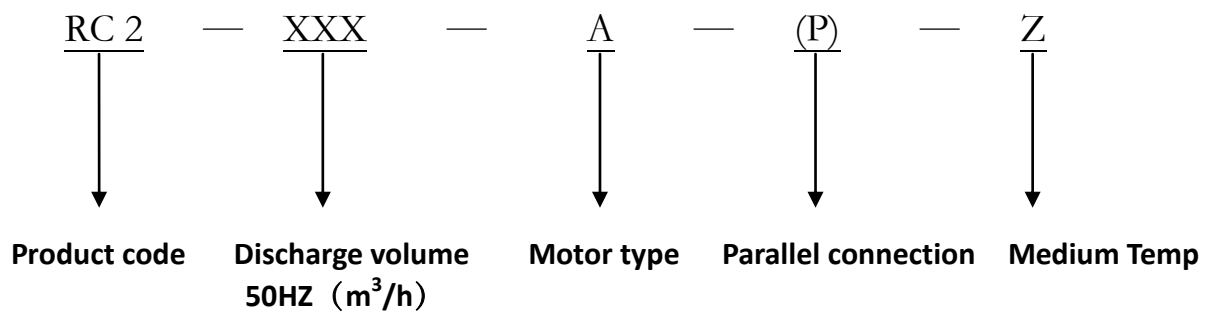

Product Feature

Patent rotor

HANBELL high-efficient rotor profile with 5:6 gear ratio has obtained several international patent in China/Europe/USA/Japan.



Long life-time bearing

Long life-time bearings can provide more stable and longer time operation.



High-efficient motor

With low-loss silicon steel core, motor cooling channel, refrigerant diversion design; the compressor can ensure the motor operate stably and high-efficiently in harsh conditions for a long time.

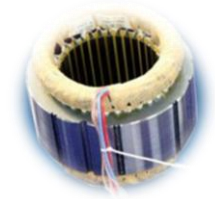

Back-office protection module

Based on original protection module INT69, INT69HBY Diagnose is updated with protection for anti-phase and phase-loss, new fault record function; which can protect the compressor more comprehensively.



Technology of parallel connection

According to the demand, customer can choose to single machine or multi-machine parallel connection



Specification

Model	Compressor					Motor					Fuel quantity	Oil heater	Strength test (air pressure)	Weight
	Discharge volume 50Hz m ³ /h	Rotation speed 50Hz r/min	Vi	Capacity control (%)	Lubrication	Type	Start model	Voltage (V) 50Hz	Insulation level	Protection	L	W	kg/cm ² G	kg
RC2-100-A(P)-Z	98	2950	3.0	33/66/100%	Differential pressure type	3-phase 2-pole AC asynchronous motor	Y-Δ	380	Level F	PTC , Temp sensor and protection module for anti-phase and phase-loss	7	300	35	275
RC2-140-A(P)-Z	137										7			280
RC2-180-A(P)-Z	180										7			320
RC2-200-A(P)-Z	193			8							420			
RC2-230-A(P)-Z	230			14							540			
RC2-260-A(P)-Z	257			14							545			
RC2-300-A(P)-Z	293			16							590			
RC2-310-A(P)-Z	308			14							575			
RC2-340-A(P)-Z	339			16							600			
RC2-370-A(P)-Z	366			16							610			
RC2-410-A(P)-Z	407			15							730			
RC2-470-A(P)-Z	471			18							800			
RC2-510-A(P)-Z	508			20							760			
RC2-550-A(P)-Z	549			23							820			
RC2-580-A(P)-Z	583			20							805			
RC2-620-A(P)-Z	619			23							850			
RC2-710-A(P)-Z	713			23							1099			
RC2-790-A(P)-Z	791			28							1140			
RC2-830-A(P)-Z	825			28							1150			
RC2-930-A(P)-Z	929			28							1180			

Performance Form (Without ECO)

RC2-100AZ, R22								
Saturated Discharge Temp °C	Saturated Suction Temp °C	-25	-20	-15	-10	-5	0	5
30	Refrigerating capacity (kW)	32.2	40.4	50.2	61.4	74.6	89.9	107.5
	Power (kW)	15.7	16.4	17.1	17.8	18.4	19.0	19.4
	Current(A)	29.5	30.5	31.4	32.4	33.2	34.0	34.6
	COP	2.053	2.465	2.935	3.456	4.053	4.741	5.539
35	Refrigerating capacity (kW)	30.1	37.9	47.1	58.1	70.6	85.2	102.1
	Power (kW)	17.1	17.9	18.7	19.4	20.1	20.7	21.2
	Current(A)	31.5	32.5	33.6	34.6	35.6	36.5	37.2
	COP	1.754	2.116	2.524	2.994	3.515	4.115	4.807
40	Refrigerating capacity (kW)	27.7	35.1	43.8	54.1	66.4	80.3	96.4
	Power (kW)	18.7	19.5	20.4	21.2	22	22.7	23.3
	Current(A)	33.7	34.8	36	37.2	38.3	39.3	40.3
	COP	1.479	1.795	2.151	2.555	3.023	3.542	4.139
45	Refrigerating capacity (kW)	24.6	32.1	40.3	50.0	61.6	74.8	90.4
	Power (kW)	20.5	21.3	22.2	23.1	24.0	24.8	25.6
	Current(A)	36.1	37.4	38.7	40.0	41.3	42.6	43.7
	COP	1.203	1.502	1.811	2.161	2.563	3.012	3.538
50	Refrigerating capacity (kW)	22.1	28.2	36.5	45.6	56.5	69.0	83.6
	Power (kW)	22.3	23.3	24.3	25.3	26.3	27.2	28.0
	Current(A)	38.8	40.2	41.7	43.3	44.7	46.2	47.5
	COP	0.992	1.211	1.501	1.804	2.152	2.538	2.984

RC2-140AZ, R22								
Saturated Discharge Temp °C	Saturated Suction Temp °C	-25	-20	-15	-10	-5	0	5
30	Refrigerating capacity (kW)	44.6	55.9	69.3	84.9	103.1	124.2	148.5
	Power (kW)	20.7	21.7	22.6	23.5	24.3	25.1	25.6
	Current(A)	39.2	40.5	41.7	43.0	44.1	45.1	45.9
	COP	2.151	2.580	3.068	3.612	4.236	4.956	5.790
35	Refrigerating capacity (kW)	41.7	52.4	65.1	80.2	97.6	117.8	141.0
	Power (kW)	22.7	23.6	24.6	25.6	26.6	27.4	28.1
	Current(A)	41.8	43.2	44.6	45.9	47.2	48.4	49.4
	COP	1.839	2.216	2.642	3.130	3.675	4.301	5.025
40	Refrigerating capacity (kW)	38.4	48.6	60.7	74.9	91.7	110.9	133.2
	Power (kW)	24.8	25.8	26.9	28	29	30	30.8
	Current(A)	44.7	46.2	47.8	49.3	50.8	52.1	53.3
	COP	1.553	1.882	2.253	2.674	3.16	3.702	4.327
45	Refrigerating capacity (kW)	34.9	44.5	55.8	69.2	85.2	103.4	124.9
	Power (kW)	27.0	28.2	29.4	30.6	31.7	32.8	33.8
	Current(A)	47.9	49.6	51.3	53.1	54.8	56.4	57.8
	COP	1.291	1.577	1.899	2.263	2.683	3.151	3.698
50	Refrigerating capacity (kW)	30.7	40.0	50.6	63.2	78.2	95.4	115.6
	Power (kW)	29.5	30.8	32.1	33.4	34.7	35.9	37.0
	Current(A)	51.5	53.3	55.3	57.3	59.2	61.1	62.9
	COP	1.041	1.298	1.576	1.891	2.254	2.657	3.123

RC2-180AZ, R22								
Saturated Discharge Temp℃	Saturated Suction Temp℃	-25	-20	-15	-10	-5	0	5
30	Refrigerating capacity (kW)	58.7	73.7	91.0	111.4	135.3	163.0	194.9
	Power (kW)	26.0	27.2	28.4	29.5	30.5	31.5	32.2
	Current(A)	50.9	52.4	53.9	55.4	56.8	58.1	59.1
	COP	2.254	2.710	3.208	3.777	4.429	5.182	6.054
35	Refrigerating capacity (kW)	54.9	68.9	85.9	105.3	128.1	154.6	185.1
	Power (kW)	28.4	29.7	30.9	32.2	33.3	34.4	35.2
	Current(A)	54.0	55.7	57.4	59.0	60.6	62.1	63.3
	COP	1.929	2.322	2.775	3.272	3.842	4.497	5.254
40	Refrigerating capacity (kW)	50.7	64	79.8	98.4	120.4	145.6	174.8
	Power (kW)	31.1	32.4	33.8	35.2	36.4	37.6	38.6
	Current(A)	57.6	59.4	61.3	63.1	65	66.6	68.1
	COP	1.63	1.973	2.36	2.799	3.304	3.871	4.524
45	Refrigerating capacity (kW)	46.1	58.6	73.5	91.1	112.3	136.2	163.9
	Power (kW)	33.9	35.4	36.9	38.4	39.9	41.2	42.4
	Current(A)	61.5	63.5	65.6	67.8	69.8	71.8	73.6
	COP	1.358	1.655	1.990	2.371	2.817	3.305	3.866
50	Refrigerating capacity (kW)	40.4	52.7	66.6	83.2	102.8	125.4	151.9
	Power (kW)	37.0	38.6	40.3	41.9	43.6	45.1	46.5
	Current(A)	65.8	68.1	70.5	72.9	75.3	77.6	79.7
	COP	1.092	1.365	1.654	1.982	2.360	2.781	3.268

RC2-200AZ, R22								
Saturated Discharge Temp℃	Saturated Suction Temp℃	-25	-20	-15	-10	-5	0	5
30	Refrigerating capacity (kW)	63.0	78.9	97.8	119.7	145.4	175.1	209.4
	Power (kW)	28.6	29.9	31.2	32.5	33.6	34.6	35.4
	Current(A)	54.3	56.0	57.7	59.4	61.0	62.4	63.5
	COP	2.198	2.636	3.132	3.687	4.324	5.059	5.910
35	Refrigerating capacity (kW)	58.8	74.0	91.9	113.1	137.6	166.1	198.9
	Power (kW)	31.3	32.7	34.1	35.4	36.7	37.8	38.8
	Current(A)	57.8	59.7	61.6	63.5	65.3	66.9	68.3
	COP	1.880	2.265	2.699	3.195	3.751	4.390	5.129
40	Refrigerating capacity (kW)	54.3	68.7	85.6	105.7	129.4	156.5	187.8
	Power (kW)	34.2	35.7	37.2	38.7	40.1	41.4	42.5
	Current(A)	61.8	63.9	66	68.2	70.2	72.1	73.7
	COP	1.588	1.924	2.302	2.731	3.226	3.779	4.417
45	Refrigerating capacity (kW)	49.4	62.8	78.8	97.7	120.2	146.3	176.1
	Power (kW)	37.4	39.0	40.6	42.3	43.9	45.3	46.7
	Current(A)	66.3	68.6	71.0	73.4	75.7	77.9	79.9
	COP	1.321	1.612	1.940	2.312	2.740	3.227	3.775
50	Refrigerating capacity (kW)	43.4	56.5	71.5	89.2	110.4	134.7	163.2
	Power (kW)	40.7	42.5	44.3	46.2	47.9	49.6	51.2
	Current(A)	71.1	73.7	76.4	79.2	81.9	84.5	86.9
	COP	1.064	1.329	1.612	1.933	2.302	2.713	3.189

RC2-230AZ, R22								
Saturated Discharge Temp℃	Saturated Suction Temp℃	-25	-20	-15	-10	-5	0	5
30	Refrigerating capacity (kW)	78.3	98.3	121.4	148.7	180.6	217.5	260.1
	Power (kW)	34.3	35.9	37.4	38.9	40.3	41.5	42.5
	Current(A)	64.8	66.9	69.1	71.3	73.3	75.0	76.5
	COP	2.282	2.742	3.246	3.822	4.482	5.243	6.126
35	Refrigerating capacity (kW)	73.3	92.0	114.6	140.5	170.9	206.3	247.1
	Power (kW)	37.5	39.2	40.8	42.4	44.0	45.3	46.5
	Current(A)	69.3	71.6	74.1	76.4	78.7	80.7	82.5
	COP	1.953	2.351	2.808	3.311	3.888	4.551	5.317
40	Refrigerating capacity (kW)	67.7	85.5	106.5	131.4	160.7	194.4	233.3
	Power (kW)	41	42.8	44.6	46.4	48.1	49.6	51
	Current(A)	74.3	76.9	79.6	82.3	84.9	87.2	89.3
	COP	1.651	1.998	2.389	2.834	3.344	3.917	4.578
45	Refrigerating capacity (kW)	61.6	78.3	98.1	121.6	149.8	181.7	218.8
	Power (kW)	44.8	46.7	48.7	50.7	52.6	54.3	55.9
	Current(A)	79.9	82.8	85.8	88.8	91.7	94.5	96.9
	COP	1.376	1.677	2.015	2.400	2.851	3.345	3.913
50	Refrigerating capacity (kW)	54.0	70.5	89.0	111.1	137.3	167.5	202.8
	Power (kW)	48.8	51.0	53.1	55.3	57.5	59.5	61.3
	Current(A)	86.0	89.3	92.6	96.0	99.3	102.5	105.3
	COP	1.107	1.384	1.676	2.007	2.390	2.815	3.307

RC2-260AZ, R22								
Saturated Discharge Temp℃	Saturated Suction Temp℃	-25	-20	-15	-10	-5	0	5
30	Refrigerating capacity (kW)	84.3	105.9	130.8	160.1	194.4	234.3	280.1
	Power (kW)	37.5	39.1	40.8	42.5	44.0	45.3	46.3
	Current(A)	69.2	71.6	74.1	76.5	78.7	80.7	82.3
	COP	2.250	2.705	3.203	3.771	4.422	5.173	6.044
35	Refrigerating capacity (kW)	78.8	99.1	123.0	151.3	184.1	222.2	266.1
	Power (kW)	40.9	42.7	44.5	46.3	48.0	49.5	50.7
	Current(A)	74.2	76.9	79.6	82.2	84.7	87.0	88.9
	COP	1.925	2.318	2.761	3.267	3.836	4.490	5.245
40	Refrigerating capacity (kW)	72.8	92	114.7	141.4	173.1	209.3	251.3
	Power (kW)	44.7	46.7	48.7	50.6	52.5	54.2	55.6
	Current(A)	79.9	82.8	85.8	88.7	91.6	94.2	96.5
	COP	1.627	1.97	2.356	2.795	3.299	3.865	4.517
45	Refrigerating capacity (kW)	66.2	84.2	105.6	130.9	161.4	195.7	235.6
	Power (kW)	48.9	51.0	53.1	55.3	57.4	59.3	61.0
	Current(A)	86.1	89.3	92.6	95.9	99.2	102.2	104.9
	COP	1.355	1.652	1.987	2.367	2.813	3.300	3.860
50	Refrigerating capacity (kW)	58.1	75.8	95.8	119.5	147.8	180.3	218.4
	Power (kW)	53.3	55.6	58.0	60.4	62.7	64.9	66.9
	Current(A)	92.9	96.4	100.1	103.9	107.5	111.0	114.2
	COP	1.091	1.363	1.652	1.979	2.357	2.777	3.262

RC2-300AZ, R22								
Saturated Discharge Temp℃	Saturated Suction Temp℃	-25	-20	-15	-10	-5	0	5
30	Refrigerating capacity (kW)	99.5	124.8	154.1	188.7	229.1	276.1	330.1
	Power (kW)	42.5	44.4	46.3	48.2	49.9	51.4	52.6
	Current(A)	77.8	80.6	83.4	86.1	88.7	90.9	92.7
	COP	2.342	2.810	3.327	3.917	4.594	5.374	6.278
35	Refrigerating capacity (kW)	93.1	116.9	145.4	178.3	216.9	261.8	313.6
	Power (kW)	46.4	48.5	50.5	52.5	54.4	56.1	57.5
	Current(A)	83.6	86.6	89.7	92.7	95.6	98.2	100.3
	COP	2.005	2.412	2.878	3.394	3.985	4.664	5.449
40	Refrigerating capacity (kW)	86.1	108.6	135.3	167.3	203.9	246.6	296.1
	Power (kW)	50.8	53	55.2	57.4	59.5	61.4	63.1
	Current(A)	90	93.3	96.7	100.1	103.4	106.4	109
	COP	1.696	2.051	2.451	2.915	3.427	4.015	4.692
45	Refrigerating capacity (kW)	78.4	99.5	124.7	154.4	190.1	230.6	277.6
	Power (kW)	55.4	57.8	60.3	62.7	65.1	67.3	69.2
	Current(A)	97.1	100.8	104.6	108.4	112.0	115.5	118.6
	COP	1.414	1.721	2.068	2.462	2.922	3.428	4.010
50	Refrigerating capacity (kW)	68.7	89.7	113.2	141.1	174.4	212.6	257.5
	Power (kW)	60.5	63.1	65.8	68.5	71.1	73.6	75.9
	Current(A)	104.8	108.9	113.2	117.4	121.6	125.6	129.2
	COP	1.136	1.422	1.721	2.060	2.451	2.887	3.391

RC2-310AZ, R22								
Saturated Discharge Temp℃	Saturated Suction Temp℃	-25	-20	-15	-10	-5	0	5
30	Refrigerating capacity (kW)	105.1	131.8	162.8	199.3	242.1	291.7	348.8
	Power (kW)	45.2	47.2	49.3	51.2	53.1	54.6	55.9
	Current(A)	81.7	84.7	87.8	90.7	93.5	95.9	97.9
	COP	2.325	2.791	3.304	3.890	4.563	5.338	6.236
35	Refrigerating capacity (kW)	98.3	123.5	153.7	188.4	229.2	276.6	331.3
	Power (kW)	49.4	51.6	53.8	55.9	57.9	59.7	61.2
	Current(A)	88.0	91.2	94.5	97.8	100.9	103.7	106.0
	COP	1.990	2.395	2.859	3.371	3.958	4.633	5.412
40	Refrigerating capacity (kW)	90.9	114.7	142.9	176.8	215.5	260.6	312.8
	Power (kW)	54	56.3	58.7	61.1	63.3	65.3	67.1
	Current(A)	94.9	98.5	102.1	105.8	109.3	112.5	115.2
	COP	1.684	2.036	2.434	2.895	3.404	3.988	4.66
45	Refrigerating capacity (kW)	82.8	105.1	131.7	163.1	200.9	243.7	293.3
	Power (kW)	59.0	61.5	64.1	66.7	69.2	71.6	73.6
	Current(A)	102.5	106.5	110.5	114.6	118.6	122.3	125.6
	COP	1.404	1.709	2.054	2.445	2.902	3.405	3.983
50	Refrigerating capacity (kW)	72.6	94.7	119.6	149.0	184.2	224.6	272.0
	Power (kW)	64.3	67.1	70.0	72.9	75.7	78.3	80.8
	Current(A)	110.8	115.2	119.8	124.3	128.8	133.1	137.0
	COP	1.128	1.411	1.708	2.045	2.434	2.867	3.368

RC2-340AZ, R22								
Saturated Discharge Temp °C	Saturated Suction Temp °C	-25	-20	-15	-10	-5	0	5
30	Refrigerating capacity (kW)	117.1	146.8	181.3	221.9	269.5	324.8	388.3
	Power (kW)	49.3	51.5	53.7	55.9	57.9	59.6	61.0
	Current(A)	89.8	93.1	96.3	99.5	102.5	105.1	107.3
	COP	2.376	2.850	3.374	3.972	4.659	5.450	6.367
35	Refrigerating capacity (kW)	109.6	137.6	171.1	209.8	255.2	308.0	368.9
	Power (kW)	53.9	56.2	58.6	61.0	63.1	65.1	66.8
	Current(A)	96.6	100.1	103.7	107.2	110.6	113.6	116.1
	COP	2.035	2.447	2.919	3.442	4.041	4.730	5.526
40	Refrigerating capacity (kW)	101.4	127.8	159.2	196.8	239.9	290.1	348.3
	Power (kW)	58.9	61.4	64	66.6	69	71.3	73.2
	Current(A)	104.1	107.9	111.9	115.8	119.6	123.1	126.1
	COP	1.722	2.081	2.487	2.956	3.475	4.072	4.758
45	Refrigerating capacity (kW)	92.4	117.2	146.8	181.7	223.7	271.3	326.6
	Power (kW)	64.3	67.1	69.9	72.8	75.5	78.0	80.3
	Current(A)	112.3	116.6	121.0	125.4	129.7	133.7	137.3
	COP	1.437	1.748	2.099	2.498	2.963	3.477	4.067
50	Refrigerating capacity (kW)	80.9	105.7	133.3	166.1	205.2	250.2	303.7
	Power (kW)	70.1	73.2	76.3	79.5	82.5	85.4	88.1
	Current(A)	121.3	126.1	131.0	136.0	140.8	145.5	149.7
	COP	1.154	1.444	1.747	2.090	2.487	2.929	3.449

RC2-370AZ, R22								
Saturated Discharge Temp °C	Saturated Suction Temp °C	-25	-20	-15	-10	-5	0	5
30	Refrigerating capacity (kW)	126.1	158.1	195.2	239.0	290.3	349.8	418.2
	Power (kW)	53.5	55.9	58.3	60.6	62.8	64.7	66.2
	Current(A)	96.0	99.6	103.2	106.7	110.0	112.9	115.2
	COP	2.358	2.829	3.349	3.943	4.624	5.410	6.320
35	Refrigerating capacity (kW)	118.0	148.2	184.3	226.0	274.8	331.7	397.3
	Power (kW)	58.5	61.0	63.6	66.1	68.5	70.6	72.4
	Current(A)	103.4	107.3	111.3	115.2	118.8	122.1	124.9
	COP	2.019	2.428	2.897	3.416	4.011	4.695	5.485
40	Refrigerating capacity (kW)	109.1	137.6	171.5	212	258.4	312.5	375.1
	Power (kW)	63.9	66.7	69.5	72.2	74.9	77.3	79.4
	Current(A)	117.7	115.9	120.3	124.6	128.8	132.6	135.9
	COP	1.708	2.065	2.468	2.934	3.45	4.042	4.723
45	Refrigerating capacity (kW)	99.4	126.2	158.0	195.7	240.9	292.2	351.7
	Power (kW)	69.8	72.8	75.9	78.9	81.9	84.7	87.1
	Current(A)	120.8	125.5	130.3	135.1	139.8	144.2	148.2
	COP	1.425	1.734	2.083	2.479	2.941	3.451	4.037
50	Refrigerating capacity (kW)	87.1	113.7	143.5	178.9	221.0	269.4	327.1
	Power (kW)	76.1	79.4	82.8	86.2	89.6	92.7	95.6
	Current(A)	130.7	135.9	141.3	146.7	152.1	157.2	161.9
	COP	1.145	1.432	1.733	2.074	2.468	2.907	3.423

RC2-410AZ, R22								
Saturated Discharge Temp℃	Saturated Suction Temp℃	-25	-20	-15	-10	-5	0	5
30	Refrigerating capacity (kW)	137.1	171.9	212.3	259.9	315.6	380.3	454.7
	Power (kW)	58.9	61.6	64.2	66.8	69.2	71.3	72.9
	Current(A)	103.7	107.5	111.4	115.2	118.9	122.0	124.6
	COP	2.325	2.791	3.304	3.890	4.563	5.338	6.236
35	Refrigerating capacity (kW)	128.2	161.0	200.4	245.7	298.8	360.6	432.0
	Power (kW)	64.4	67.2	70.1	72.9	75.5	77.8	79.8
	Current(A)	111.7	115.9	120.3	124.6	128.7	132.4	135.5
	COP	1.990	2.395	2.859	3.371	3.958	4.633	5.412
40	Refrigerating capacity (kW)	118.5	149.5	186.3	230.5	280.9	339.8	407.9
	Power (kW)	70.4	73.4	76.6	79.6	82.5	85.2	87.5
	Current(A)	120.7	125.4	130.3	135.2	139.9	144.2	148
	COP	1.684	2.036	2.434	2.895	3.404	3.988	4.66
45	Refrigerating capacity (kW)	107.9	137.1	171.7	212.7	261.9	317.7	382.4
	Power (kW)	76.9	80.2	83.6	87.0	90.3	93.3	96.0
	Current(A)	130.9	136.1	141.6	147.1	152.5	157.5	162.0
	COP	1.404	1.709	2.054	2.445	2.902	3.405	3.983
50	Refrigerating capacity (kW)	94.6	123.5	155.9	194.3	240.2	292.9	354.7
	Power (kW)	83.9	87.5	91.3	95.0	98.7	102.1	105.3
	Current(A)	142.0	147.9	154.1	160.3	166.4	172.2	177.5
	COP	1.128	1.411	1.708	2.045	2.434	2.867	3.368

RC2-470AZ, R22								
Saturated Discharge Temp℃	Saturated Suction Temp℃	-25	-20	-15	-10	-5	0	5
30	Refrigerating capacity (kW)	166.5	208.8	257.8	315.6	383.3	461.9	552.2
	Power (kW)	70.6	73.8	76.9	80.0	82.8	85.3	87.3
	Current(A)	123.9	128.5	133.2	137.8	142.2	146.0	149.1
	COP	2.359	2.831	3.351	3.945	4.627	5.413	6.324
35	Refrigerating capacity (kW)	155.8	195.6	243.3	298.4	362.9	438.0	524.6
	Power (kW)	77.1	80.5	83.9	87.3	90.4	93.2	95.6
	Current(A)	133.5	138.6	143.8	149.0	154.0	158.4	162.2
	COP	2.020	2.430	2.899	3.418	4.014	4.698	5.488
40	Refrigerating capacity (kW)	144.1	181.7	226.4	279.9	341.2	412.6	495.3
	Power (kW)	84.3	88	91.7	95.3	98.8	102	104.8
	Current(A)	144.4	150.1	155.9	161.8	167.4	172.6	177.1
	COP	1.709	2.066	2.47	2.936	3.452	4.044	4.726
45	Refrigerating capacity (kW)	131.3	166.6	208.7	258.4	318.1	385.8	464.4
	Power (kW)	92.1	96.0	100.1	104.2	108.1	111.7	115.0
	Current(A)	156.6	162.9	169.5	176.1	182.5	188.6	194.0
	COP	1.426	1.735	2.084	2.480	2.943	3.453	4.039
50	Refrigerating capacity (kW)	115.0	150.2	189.5	236.2	291.8	355.8	431.9
	Power (kW)	100.4	104.8	109.3	113.8	118.2	122.3	126.1
	Current(A)	170.0	177.1	184.5	192.0	199.3	206.2	212.6
	COP	1.145	1.433	1.734	2.076	2.469	2.908	3.425

RC2-510AZ, R22								
Saturated Discharge Temp℃	Saturated Suction Temp℃	-25	-20	-15	-10	-5	0	5
30	Refrigerating capacity (kW)	174.2	218.2	269.5	329.9	400.7	482.8	577.2
	Power (kW)	72.2	75.5	78.7	81.8	84.8	87.3	89.3
	Current(A)	130.8	135.2	139.7	144.2	148.4	152.1	155.1
	COP	2.412	2.892	3.424	4.031	4.727	5.530	6.461
35	Refrigerating capacity (kW)	163.1	204.6	254.3	311.9	379.3	457.8	548.3
	Power (kW)	78.9	82.4	85.9	89.3	92.5	95.4	97.8
	Current(A)	140.0	144.9	150.0	155.0	159.8	164.2	167.9
	COP	2.066	2.484	2.962	3.493	4.101	4.800	5.607
40	Refrigerating capacity (kW)	150.9	190.2	236.8	292.6	356.6	431.3	517.7
	Power (kW)	86.3	90	93.8	97.5	101.1	104.4	107.2
	Current(A)	150.6	156.1	161.8	167.5	173	178.1	182.6
	COP	1.749	2.113	2.525	2.999	3.527	4.132	4.828
45	Refrigerating capacity (kW)	137.5	174.5	218.3	270.3	332.5	403.3	485.5
	Power (kW)	94.2	98.3	102.4	106.6	110.6	114.3	117.6
	Current(A)	162.4	168.6	175.0	181.5	187.9	193.9	199.2
	COP	1.460	1.775	2.131	2.536	3.007	3.528	4.127
50	Refrigerating capacity (kW)	120.4	157.4	198.4	247.1	305.2	372.1	451.5
	Power (kW)	102.7	107.2	111.8	116.4	120.9	125.1	129.0
	Current(A)	175.5	182.5	189.8	197.2	204.5	211.5	217.8
	COP	1.172	1.468	1.774	2.123	2.525	2.973	3.499

RC2-550AZ, R22								
Saturated Discharge Temp℃	Saturated Suction Temp℃	-25	-20	-15	-10	-5	0	5
30	Refrigerating capacity (kW)	192.6	241.3	298.0	364.9	443.1	533.9	638.4
	Power (kW)	81.3	84.9	88.6	92.1	95.4	98.2	100.5
	Current(A)	143.4	148.6	154.0	159.2	164.2	168.5	172.1
	COP	2.370	2.843	3.365	3.962	4.647	5.436	6.351
35	Refrigerating capacity (kW)	180.2	226.2	281.3	344.9	419.5	506.3	606.4
	Power (kW)	88.8	92.7	96.6	100.5	104.1	107.3	110.0
	Current(A)	154.3	160.1	166.1	172.0	177.6	182.7	187.0
	COP	2.029	2.440	2.911	3.433	4.031	4.718	5.511
40	Refrigerating capacity (kW)	166.7	210.1	261.8	323.6	394.4	477	572.6
	Power (kW)	97.1	101.2	105.5	109.8	113.8	117.5	120.7
	Current(A)	166.7	173.2	179.9	186.6	193	198.9	204.1
	COP	1.717	2.076	2.48	2.948	3.466	40.61	4.746
45	Refrigerating capacity (kW)	151.8	192.7	241.3	298.8	367.7	446.0	536.9
	Power (kW)	106.0	110.6	115.3	119.9	124.4	128.6	132.4
	Current(A)	180.6	187.9	195.4	202.9	210.3	217.2	223.4
	COP	1.433	1.743	2.093	2.491	2.955	3.467	4.056
50	Refrigerating capacity (kW)	133.0	173.7	219.1	273.1	337.4	411.3	499.3
	Power (kW)	115.6	120.6	125.8	131.0	136.0	140.8	145.2
	Current(A)	195.9	204.1	212.5	221.1	229.5	237.5	244.8
	COP	1.151	1.440	1.742	2.085	2.480	2.921	3.440

RC2-580AZ, R22								
Saturated Discharge Temp℃	Saturated Suction Temp℃	-25	-20	-15	-10	-5	0	5
30	Refrigerating capacity (kW)	208.6	261.3	322.7	395.1	479.8	578.1	691.3
	Power (kW)	86.9	90.8	94.8	98.5	102.0	105.1	107.6
	Current(A)	151.6	157.4	163.2	169.0	174.4	179.2	183.1
	COP	2.399	2.877	3.405	4.009	4.702	5.501	6.427
35	Refrigerating capacity (kW)	195.2	245.0	304.6	373.5	454.3	548.2	656.7
	Power (kW)	95.0	99.2	103.4	107.5	111.4	114.8	117.7
	Current(A)	163.6	170.0	176.5	183.0	189.1	194.7	199.4
	COP	2.055	2.471	2.946	3.474	4.079	4.774	5.577
40	Refrigerating capacity (kW)	180.6	227.7	283.6	350.4	427.1	516.5	620
	Power (kW)	103.9	108.3	112.9	117.4	121.7	125.7	129.1
	Current(A)	177.2	184.3	191.6	198.9	205.9	212.3	218
	COP	1.739	2.102	2.511	2.984	3.508	4.11	4.803
45	Refrigerating capacity (kW)	164.6	208.8	261.4	323.6	398.2	483.0	581.4
	Power (kW)	113.4	118.3	123.3	128.3	133.1	137.6	141.6
	Current(A)	192.4	200.3	208.5	216.7	224.7	232.1	238.8
	COP	1.452	1.765	2.120	2.522	2.991	3.509	4.105
50	Refrigerating capacity (kW)	144.2	188.3	237.5	295.9	365.5	445.5	540.7
	Power (kW)	123.7	129.1	134.6	140.2	145.6	150.7	155.3
	Current(A)	209.1	217.9	227.1	236.4	245.4	254.0	261.9
	COP	1.165	1.459	1.764	2.111	2.511	2.957	3.481

RC2-620AZ, R22								
Saturated Discharge Temp℃	Saturated Suction Temp℃	-25	-20	-15	-10	-5	0	5
30	Refrigerating capacity (kW)	216.6	271.4	335.1	410.3	498.3	600.4	717.9
	Power (kW)	90.9	95.0	99.1	103.1	106.7	109.9	112.5
	Current(A)	159.7	165.6	171.7	177.6	183.2	188.1	192.1
	COP	2.381	2.856	3.381	3.981	4.669	5.462	6.381
35	Refrigerating capacity (kW)	202.7	254.4	316.3	387.8	471.7	569.3	681.9
	Power (kW)	99.4	103.7	108.1	112.4	116.5	120.1	123.1
	Current(A)	172.1	178.6	185.4	192.0	198.4	204.1	209.0
	COP	2.039	2.452	2.925	3.449	4.050	4.740	5.538
40	Refrigerating capacity (kW)	187.5	236.4	294.4	363.9	443.5	536.4	643.9
	Power (kW)	108.6	113.3	118.1	122.8	127.3	131.5	135
	Current(A)	186.1	193.4	200.9	208.5	215.7	222.4	228.2
	COP	1.726	2.096	2.493	2.962	3.483	4.08	4.768
45	Refrigerating capacity (kW)	170.8	216.8	271.4	336.0	413.5	501.5	603.7
	Power (kW)	118.6	123.7	129.0	134.2	139.3	144.0	148.1
	Current(A)	201.8	209.9	218.4	226.9	235.2	243.0	249.9
	COP	1.440	1.752	2.104	2.503	2.969	3.484	4.075
50	Refrigerating capacity (kW)	149.6	195.4	246.5	307.1	379.5	462.6	561.5
	Power (kW)	129.4	135.0	140.8	146.6	152.3	157.6	162.5
	Current(A)	219.0	228.2	237.7	247.3	256.8	265.7	273.9
	COP	1.156	1.448	1.751	2.095	2.492	2.935	3.456

RC2-710AZ, R22								
Saturated Discharge Temp℃	Saturated Suction Temp℃	-25	-20	-15	-10	-5	0	5
30	Refrigerating capacity (kW)	252.4	316.1	390.3	477.9	580.3	699.2	836.1
	Power (kW)	103.7	108.4	113.0	117.5	121.7	125.4	128.3
	Current(A)	184.8	191.1	197.5	203.8	209.7	215.0	219.2
	COP	2.434	2.917	3.453	4.066	4.768	5.578	6.517
35	Refrigerating capacity (kW)	236.3	296.5	368.4	451.7	549.4	663.1	794.2
	Power (kW)	113.3	118.3	123.3	128.2	132.8	137.0	140.4
	Current(A)	197.9	204.9	212.0	219.1	225.9	232.0	237.2
	COP	2.085	2.507	2.987	3.523	4.136	4.841	5.656
40	Refrigerating capacity (kW)	218.7	275.6	343.1	423.8	516.5	624.7	749.9
	Power (kW)	123.9	129.2	134.7	140.1	145.2	149.9	154
	Current(A)	212.8	220.6	228.6	236.7	244.5	251.8	258.1
	COP	1.766	2.133	2.548	3.025	3.557	4.167	4.87
45	Refrigerating capacity (kW)	199.4	252.8	316.4	391.6	481.6	584.1	703.1
	Power (kW)	135.3	141.1	147.1	153.1	158.8	164.2	168.9
	Current(A)	229.5	238.3	247.4	256.7	265.7	274.3	282.0
	COP	1.474	1.792	2.151	2.559	3.033	3.558	4.162
50	Refrigerating capacity (kW)	174.5	228.1	287.5	358.1	442.2	539.0	653.9
	Power (kW)	147.5	153.9	160.5	167.2	173.6	179.7	185.3
	Current(A)	248.1	258.1	268.5	279.1	289.7	299.8	309.1
	COP	1.183	1.482	1.791	2.142	2.547	2.999	3.530

RC2-790AZ, R22								
Saturated Discharge Temp℃	Saturated Suction Temp℃	-25	-20	-15	-10	-5	0	5
30	Refrigerating capacity (kW)	271.7	340.2	420.1	514.3	624.6	752.6	899.9
	Power (kW)	111.8	116.8	121.9	126.8	131.3	135.2	138.4
	Current(A)	199.1	205.9	212.8	219.6	226.0	231.7	236.3
	COP	2.429	2.911	3.446	4.058	4.759	5.567	6.504
35	Refrigerating capacity (kW)	254.3	319.1	396.5	486.2	591.3	713.7	854.8
	Power (kW)	122.2	127.6	133.0	138.3	143.3	147.7	151.4
	Current(A)	213.3	220.8	228.5	236.2	243.5	250.1	255.7
	COP	2.081	2.501	2.982	3.516	4.128	4.832	5.645
40	Refrigerating capacity (kW)	235.3	296.6	369.3	456.1	555.9	672.4	807.1
	Power (kW)	133.6	139.4	145.2	151.1	156.6	161.7	166.1
	Current(A)	229.4	237.7	246.4	255.2	263.6	271.4	278.3
	COP	1.762	2.128	2.542	3.019	3.55	4.159	4.86
45	Refrigerating capacity (kW)	214.6	272.1	340.5	421.4	518.4	628.7	756.8
	Power (kW)	145.9	152.2	158.6	165.1	171.3	177.0	182.2
	Current(A)	247.4	256.9	266.7	276.7	286.5	295.8	304.1
	COP	1.471	1.788	2.146	2.553	3.027	3.551	4.154
50	Refrigerating capacity (kW)	187.8	245.5	309.4	385.3	475.9	580.1	703.8
	Power (kW)	159.1	166.0	173.1	180.3	187.2	193.8	199.8
	Current(A)	267.5	278.2	289.5	301.0	312.4	323.3	333.4
	COP	1.181	1.479	1.787	2.138	2.542	2.993	3.523

RC2-830AZ, R22								
Saturated Discharge Temp℃	Saturated Suction Temp℃	-25	-20	-15	-10	-5	0	5
30	Refrigerating capacity (kW)	295.6	370.3	457.2	559.8	679.8	819.1	979.4
	Power (kW)	122.1	127.6	133.1	138.4	143.3	147.6	151.1
	Current(A)	216.9	224.3	231.9	239.4	246.4	252.6	257.7
	COP	2.420	2.901	3.435	4.044	4.743	5.548	6.482
35	Refrigerating capacity (kW)	276.7	347.3	431.6	529.1	643.6	776.7	930.4
	Power (kW)	133.5	139.3	145.2	151.0	156.5	161.3	165.4
	Current(A)	232.5	240.7	249.2	257.6	265.6	272.8	279.0
	COP	2.073	2.493	2.971	3.504	4.114	4.815	5.625
40	Refrigerating capacity (kW)	256.1	3.227	401.9	496.4	605.1	731.8	878.5
	Power (kW)	145.9	152.2	158.6	165	171	176.6	181.4
	Current(A)	250.1	259.3	268.8	278.4	287.6	296.2	303.7
	COP	1.755	2.121	2.533	3.009	3.538	4.145	4.844
45	Refrigerating capacity (kW)	233.5	296.1	370.5	458.7	564.2	684.3	823.7
	Power (kW)	159.3	166.2	173.3	180.3	187.0	193.3	199.0
	Current(A)	269.9	280.2	291.1	302.0	312.8	322.9	332.1
	COP	1.465	1.781	2.139	2.544	3.016	3.539	4.140
50	Refrigerating capacity (kW)	204.4	267.1	336.7	419.3	518.0	631.4	766.1
	Power (kW)	173.8	181.3	189.1	196.9	204.5	211.7	218.2
	Current(A)	291.9	303.7	316.0	328.7	341.1	353.1	364.2
	COP	1.176	1.473	1.781	2.130	2.533	2.983	3.511

RC2-930AZ, R22								
Saturated Discharge Temp℃	Saturated Suction Temp℃	-25	-20	-15	-10	-5	0	5
30	Refrigerating capacity (kW)	333.5	417.8	515.8	631.6	767.0	924.2	1105.1
	Power (kW)	138.0	144.2	150.4	156.4	162.0	166.8	170.7
	Current(A)	244.9	253.4	262.0	270.4	278.4	285.4	291.1
	COP	2.417	2.897	3.430	4.038	4.736	5.540	6.473
35	Refrigerating capacity (kW)	312.2	391.8	486.9	597.0	726.2	876.4	1049.7
	Power (kW)	150.8	157.4	164.1	170.6	176.8	182.3	186.9
	Current(A)	262.6	271.9	281.4	290.9	300.0	308.2	315.2
	COP	2.070	2.489	2.967	3.499	4.108	4.809	5.618
40	Refrigerating capacity (kW)	288.9	364.1	453.4	560.1	682.7	825.7	991.1
	Power (kW)	164.8	171.9	179.2	186.4	193.2	199.5	204.9
	Current(A)	282.5	292.9	303.7	314.5	324.9	334.6	343.1
	COP	1.753	2.118	2.53	3.005	3.533	4.139	4.837
45	Refrigerating capacity (kW)	263.4	334.0	418.0	517.5	636.5	772.0	929.3
	Power (kW)	180.0	187.8	195.7	203.7	211.3	218.4	224.8
	Current(A)	304.8	316.6	328.8	341.2	353.3	364.8	375.2
	COP	1.463	1.779	2.136	2.541	3.012	3.534	4.134
50	Refrigerating capacity (kW)	230.6	301.3	379.8	473.1	584.4	712.3	864.3
	Power (kW)	196.3	204.9	213.6	222.4	231.0	239.1	246.5
	Current(A)	329.7	343.1	357.0	371.3	385.4	399.0	411.5
	COP	1.174	1.471	1.778	2.127	2.529	2.979	3.506

Remark: The above performance data are in accordance with the latest selection software of Hanbell. The selection software may be updated without prior notice.

★ Please download HANBELL selection program to select the oil cooling data according to conditions

RC2-100AZ ~ 140AZ Drawing

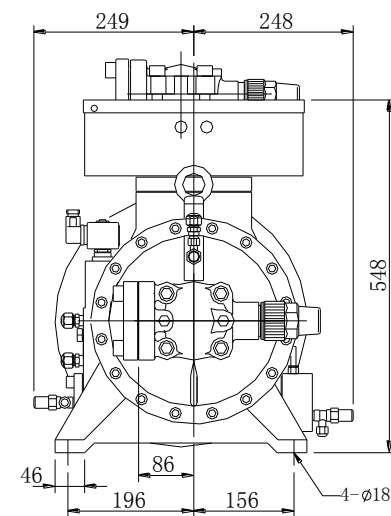
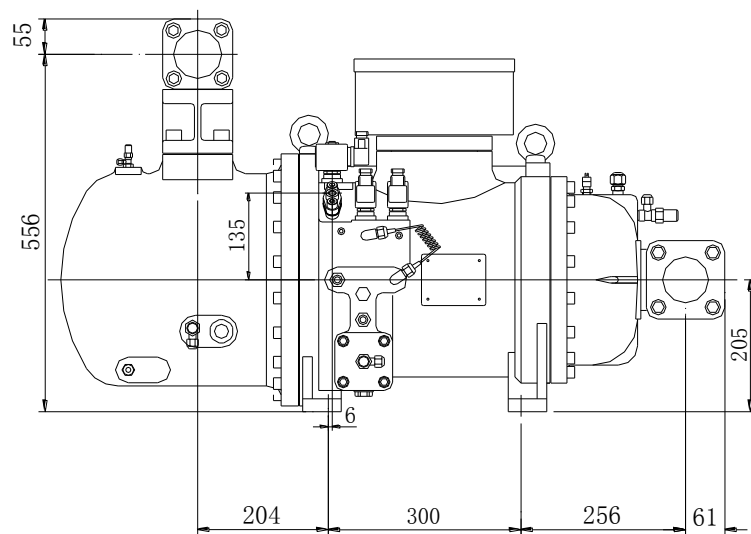
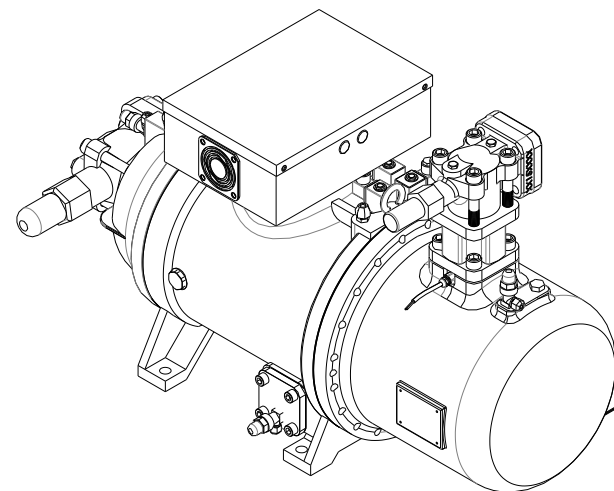
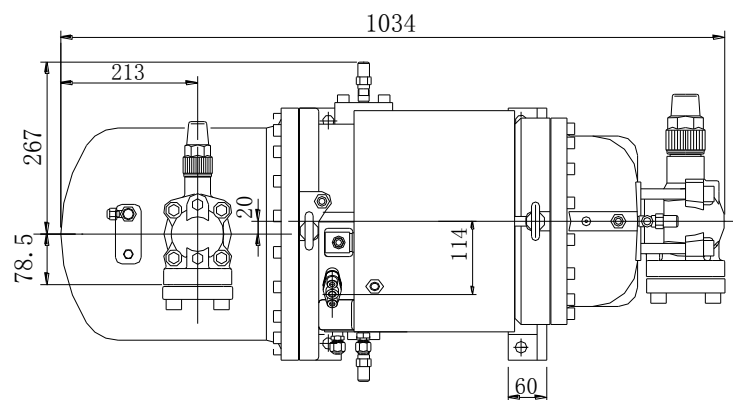

RC2-180AZ Drawing

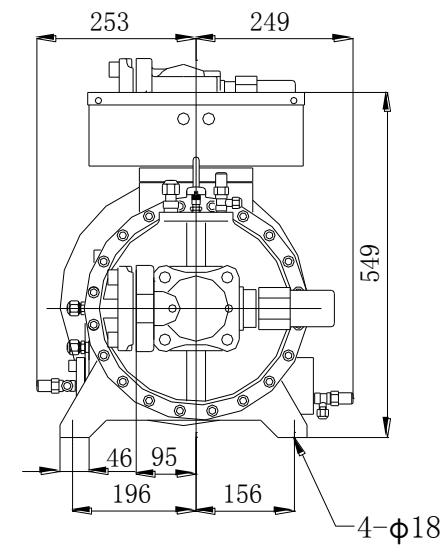
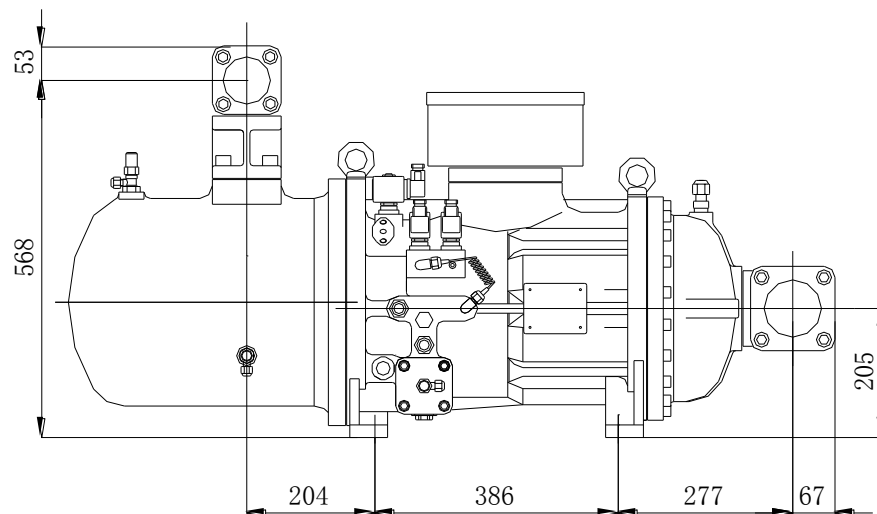
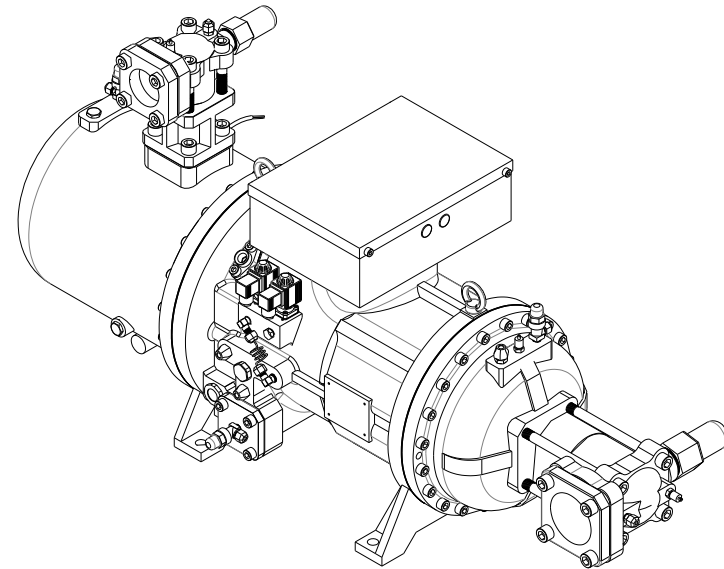
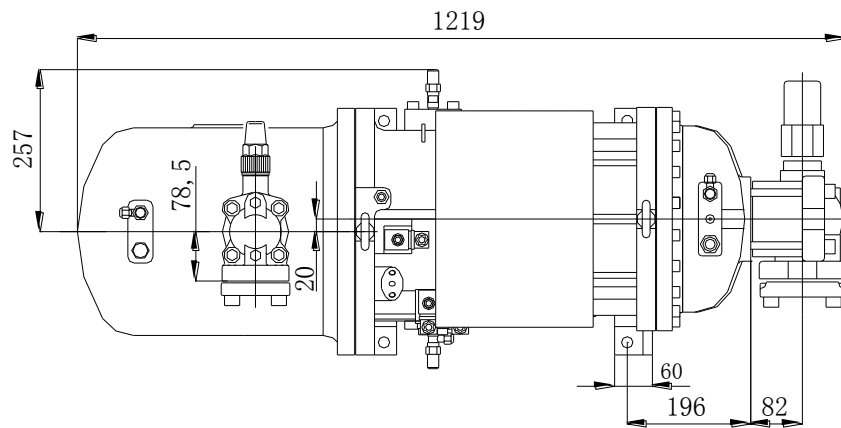

▲Dimension unit: mm

RC2-200AZ~620AZ Drawing (Horizontal suction port for 620)

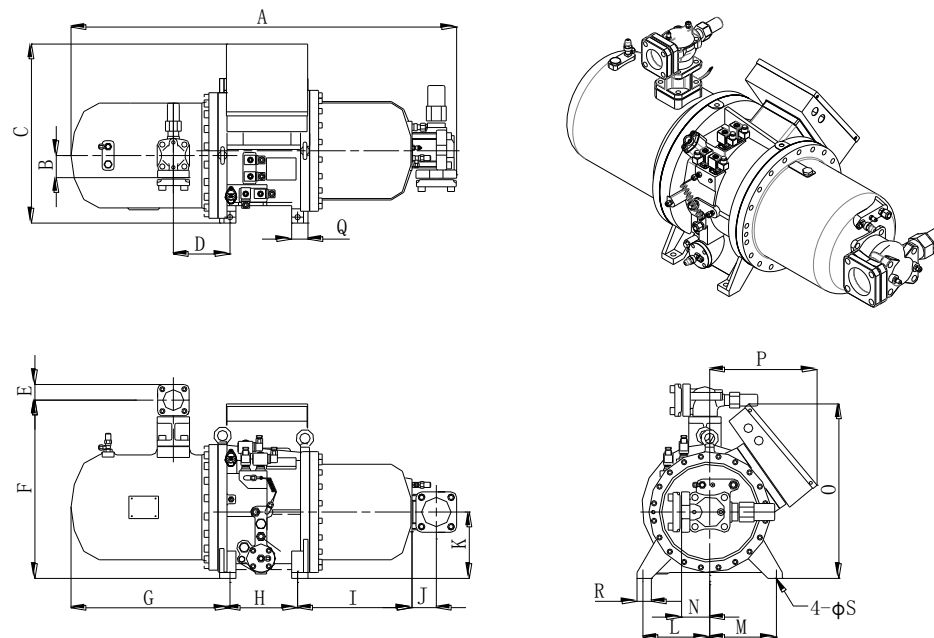

Model	RC2 -200AZ~620AZ Dimension (Horizontal suction port for 620)																		
	A	B	C	D	E	F	G	H	I	J	K	L	M	N	O	P	Q	R	S
RC2 -200AZ	1255	79	620	191	55	603	536	228	341	82	225	225	225	95	592	386	55	48	18
RC2 -230A & 260AZ	1399	86	682	202	61	674	567	251	399	97	257	240	240	107	622	386	55	48	18
RC2 -300AZ	1476	86	682	202	61	674	610	285	399	97	257	240	240	107	622	386	55	48	18
RC2 -310AZ	1484	86	682	202	61	674	610	251	444	97	257	240	240	107	622	386	55	48	18
RC2 -340A&370AZ	1550	96	682	202	67	704	610	285	447	103	257	240	240	132	622	386	55	48	18
RC2 -410AZ	1540	96	755	221	67	755	613	288	433	103	276	270	230	132	652	408	70	100	22
RC2 -470AZ	1621	96	755	221	67	755	661	320	433	103	276	270	230	132	652	408	70	100	22
RC2 -510AZ	1675	107	798	231	76	789	696	288	484	103	276	270	230	132	638	450	70	100	22
RC2 -550AZ	1724	107	798	236	76	800	720	320	477	103	280	270	230	132	642	450	70	100	22
RC2 -580AZ	1707	107	798	231	76	789	696	320	484	103	276	270	230	132	638	450	70	100	22
RC2 -620AZ	1904	107	798	236	76	800	720	320	525	220	280	270	230	161	642	450	70	100	22

▲Dimension unit: mm

RC2 -620AZ~930AZ Drawing (Vertical suction port for 620)

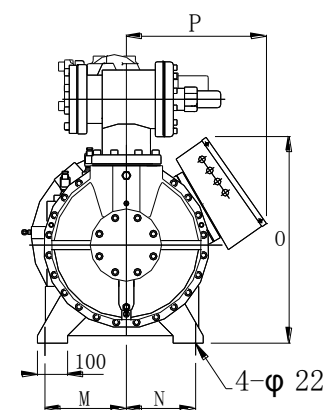
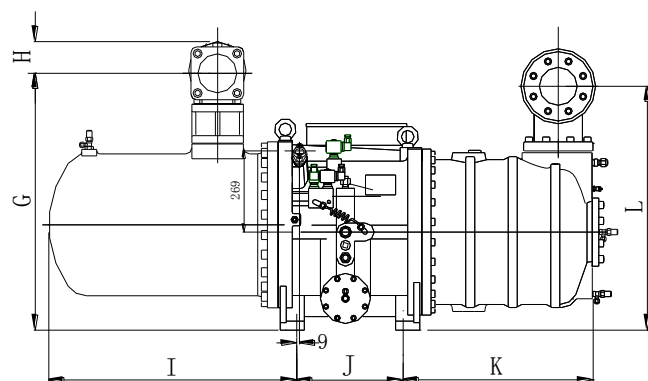
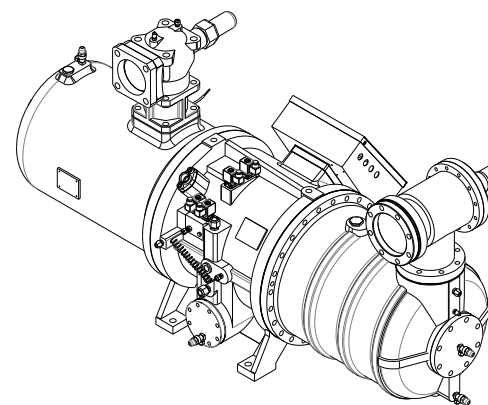
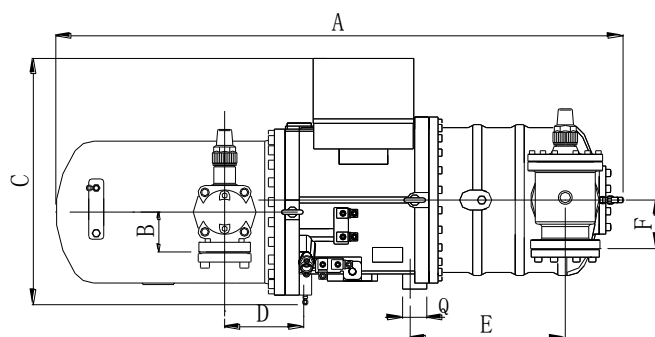

Model	RC2 -620AZ~930AZ External Parts Drawing (Vertical suction port for 620)																
	A	B	C	D	E	F	G	H	I	J	K	L	M	N	O	P	Q
RC2 -620AZ	1743	107	800	236	510	161	800	76	720	320	623	738	270	230	642	450	70
RC2 -710AZ	1883	130	812	263	515	161	851	105	822	353	628	808	270	230	682	465	80
RC2 -790AZ&830AZ	1970	130	812	263	515	161	851	105	822	418	628	808	270	230	682	465	80
RC2 -930AZ	2019	160	812	263	585	161	851	105	822	418	698	808	270	230	682	465	80

RC2-100AZ&140AZ Drawing

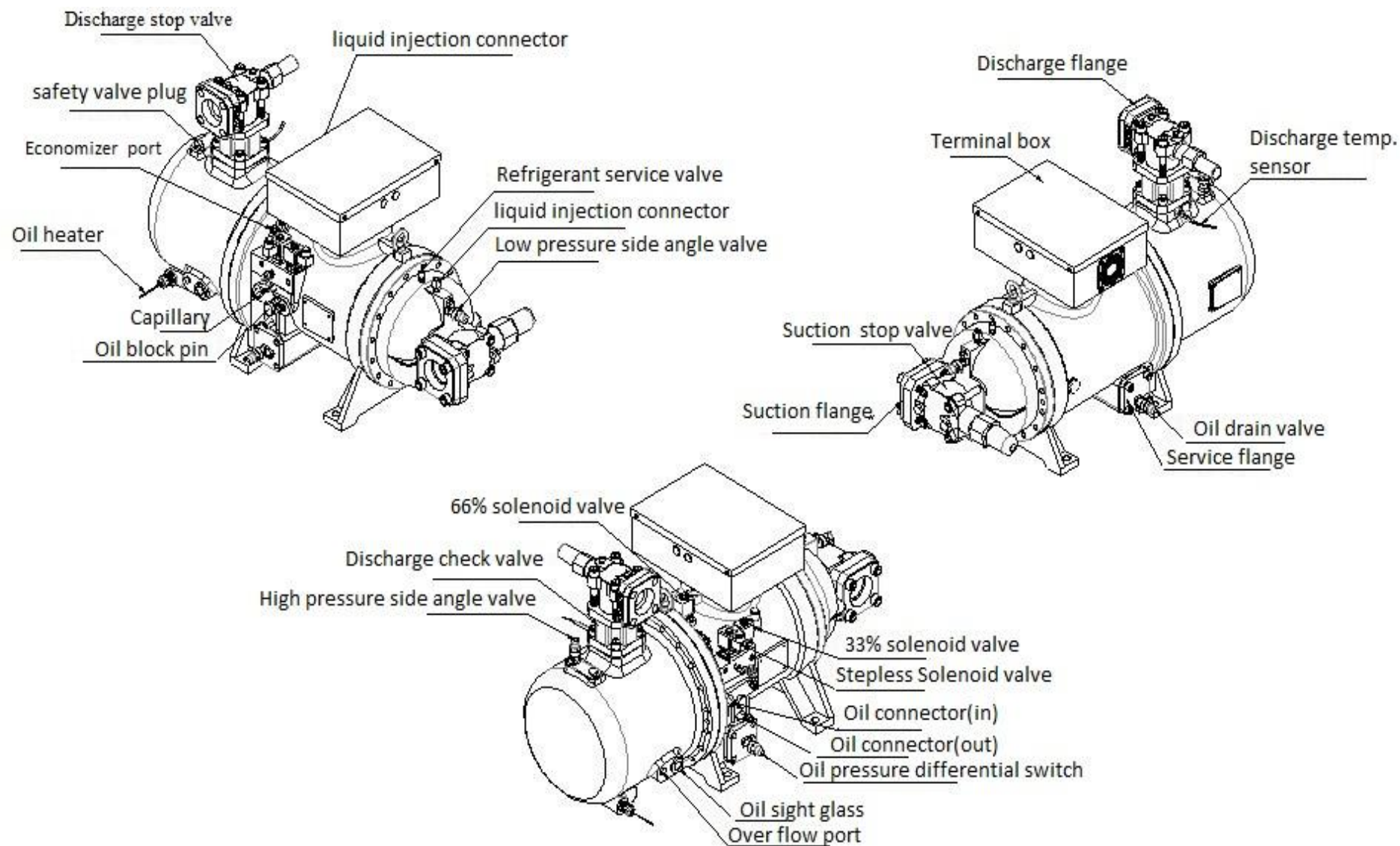

RC2-180AZ Drawing

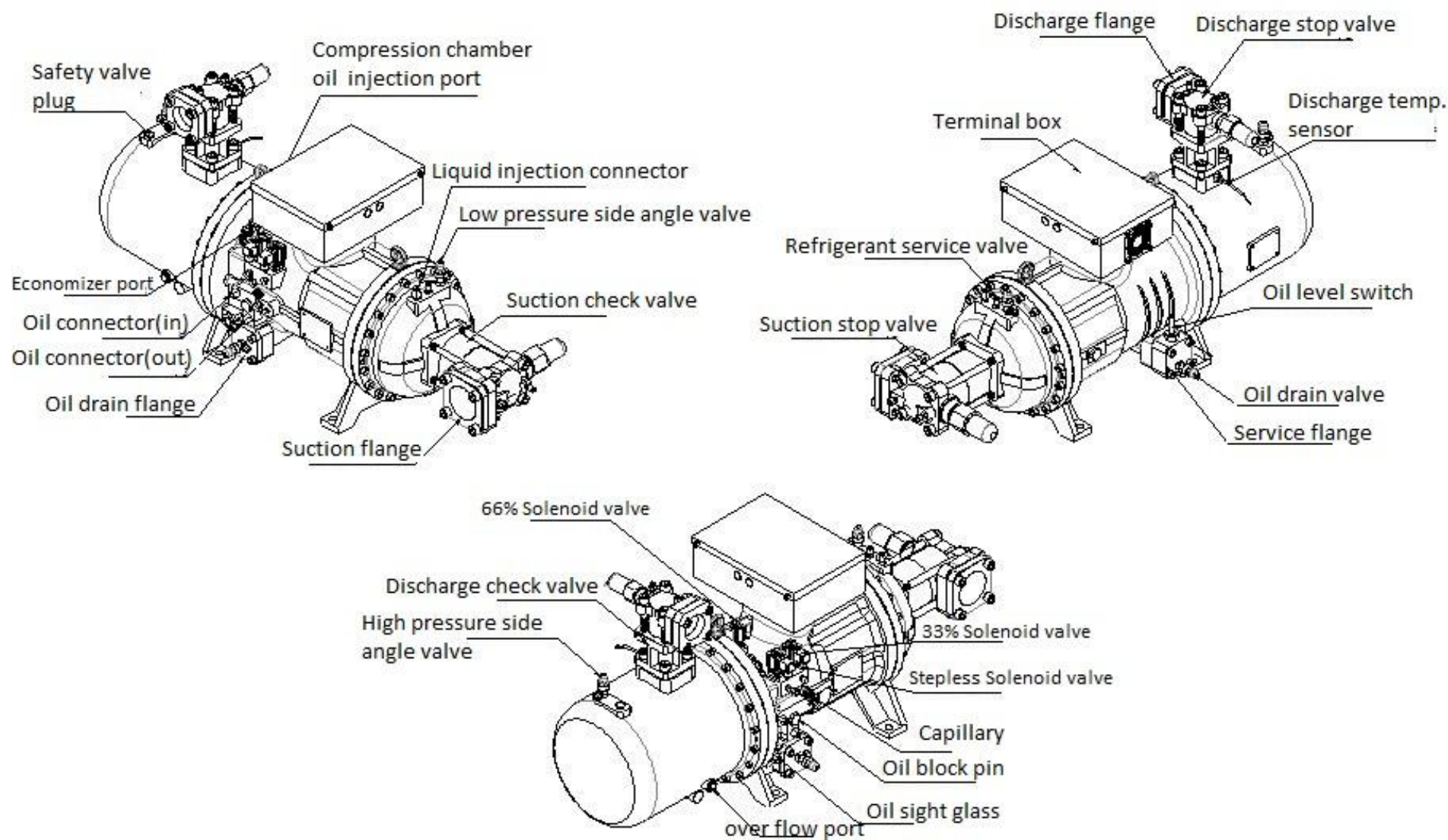

RC2-200AZ ~ 620AZ Drawing (Horizontal suction port for 620)

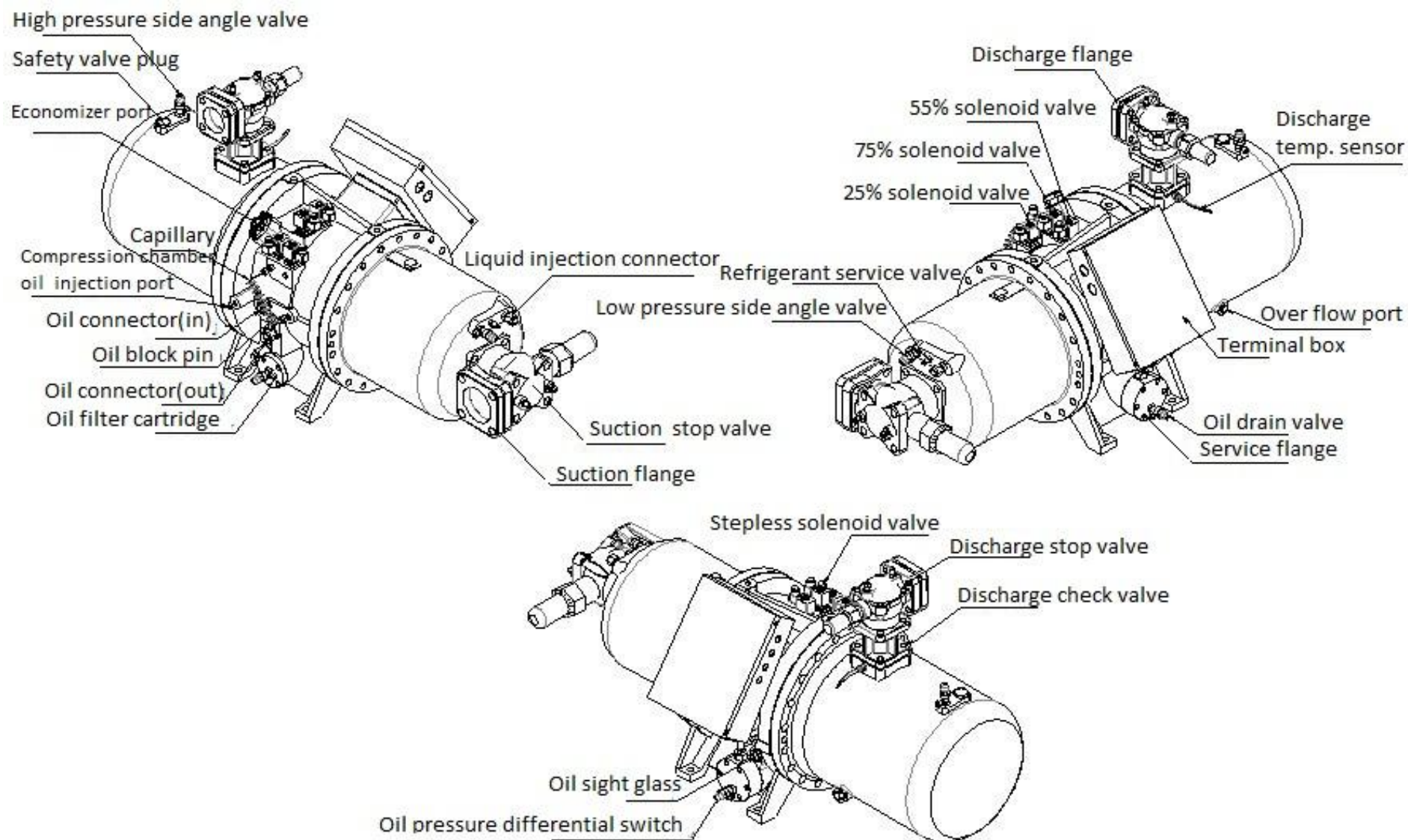

RC2-620AZ ~ 930AZ Drawing (Vertical suction port for 620)

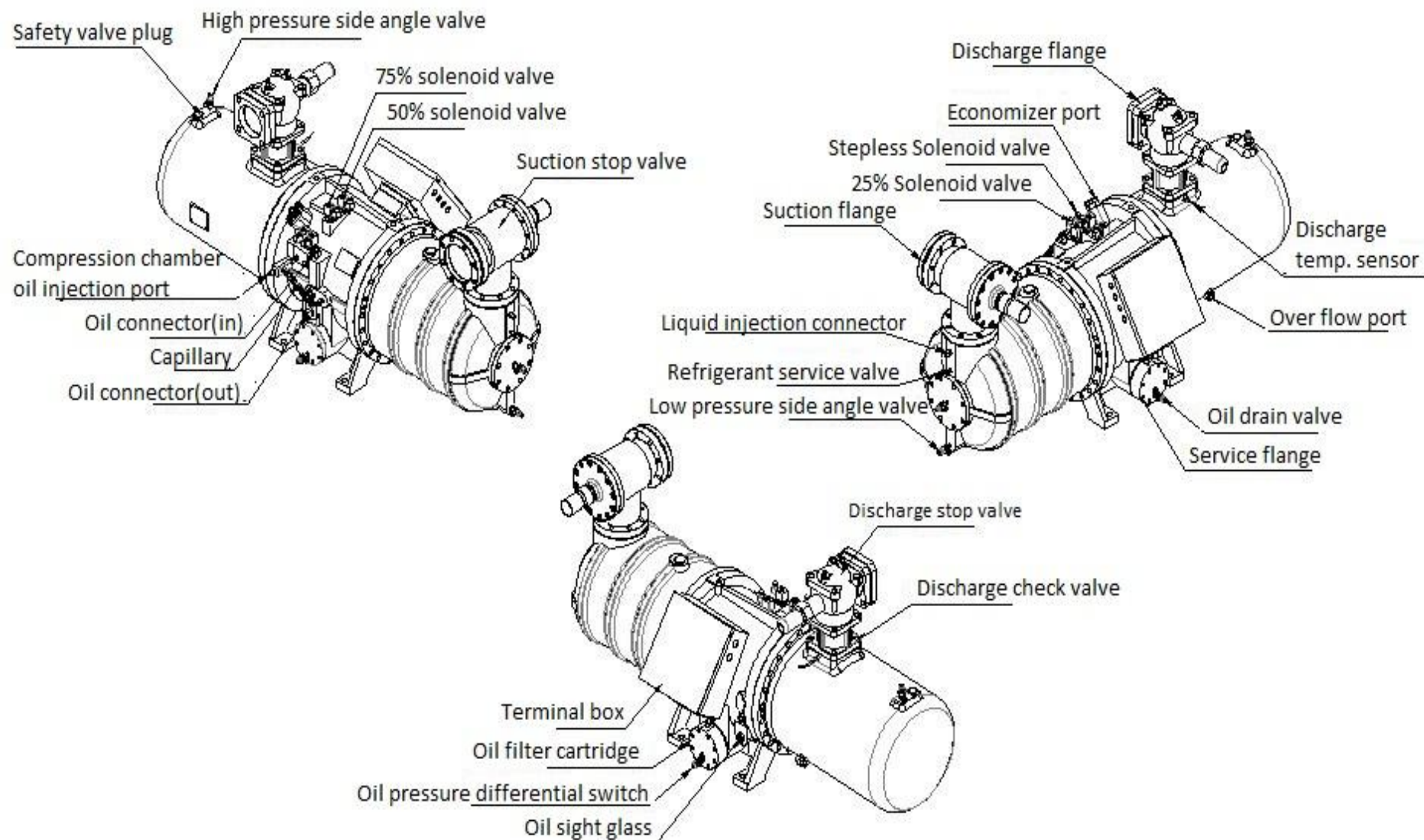

RC2-100APZ ~ 140APZ Drawing

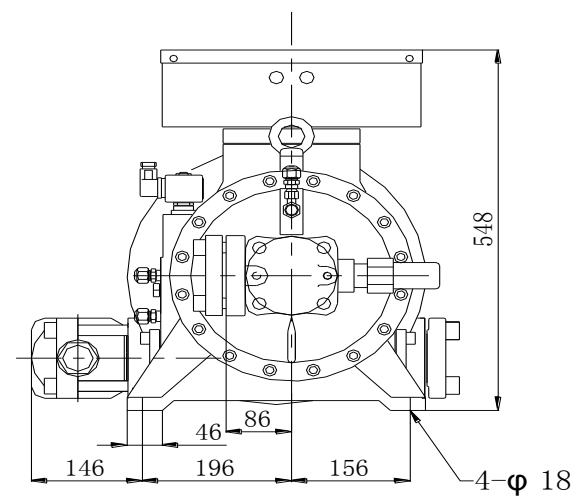
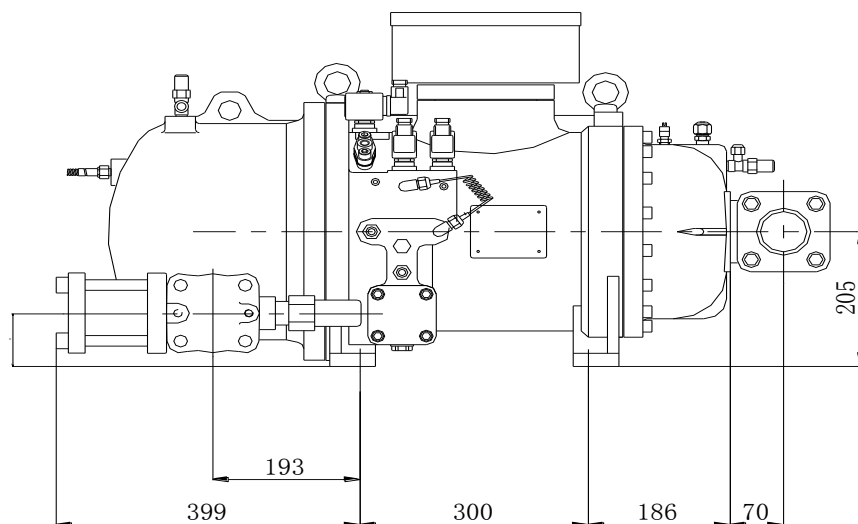
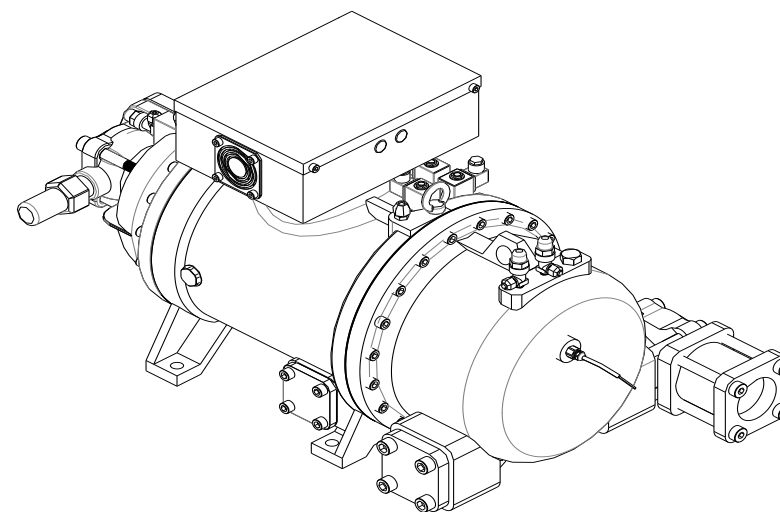
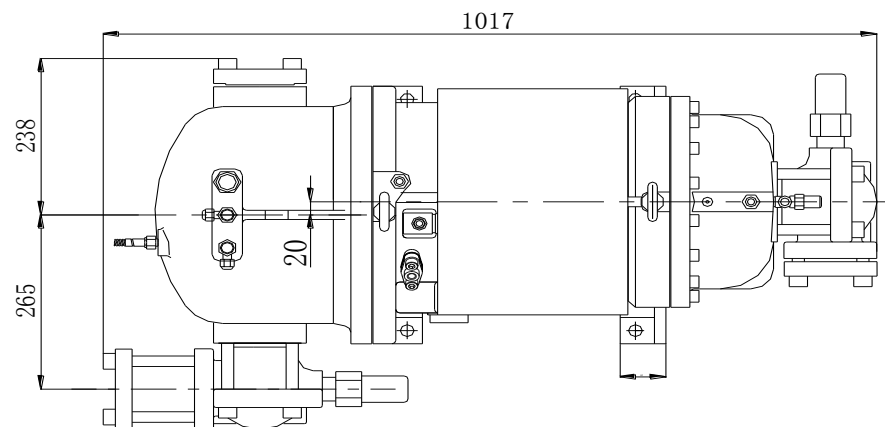

▲Dimension unit: mm

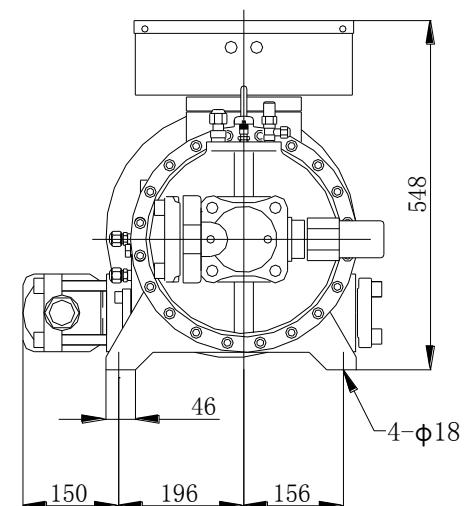
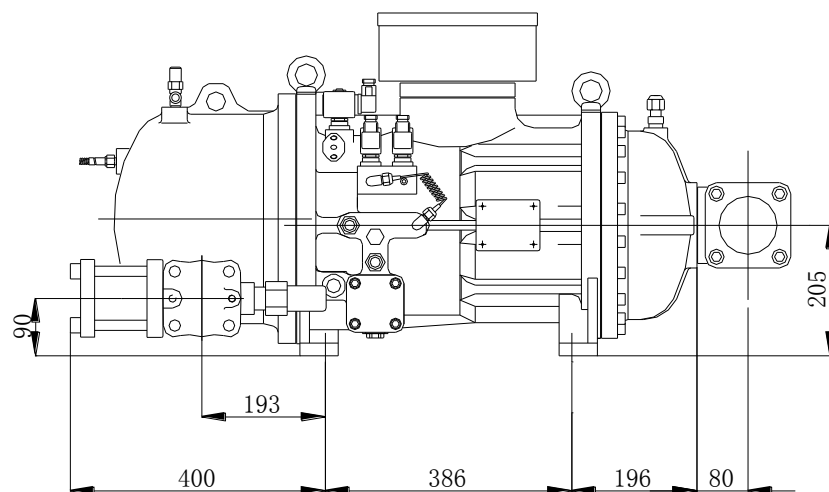
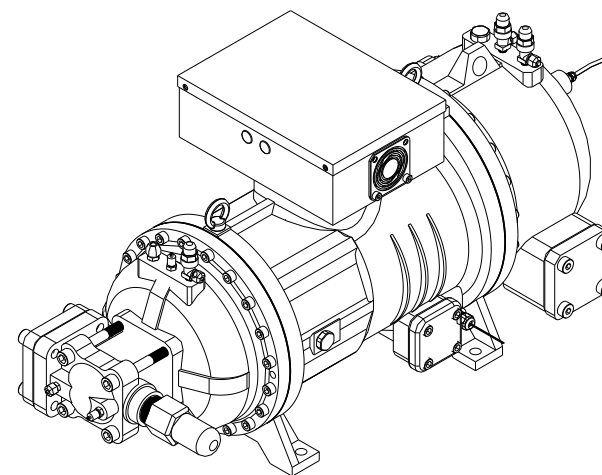
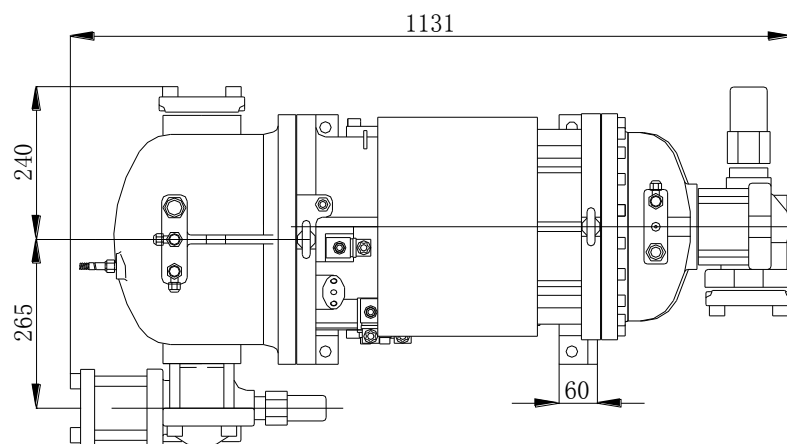
RC2-180APZ Drawing

▲Dimension unit: mm

RC2-200APZ~620APZ Drawing (Horizontal suction port for 620)

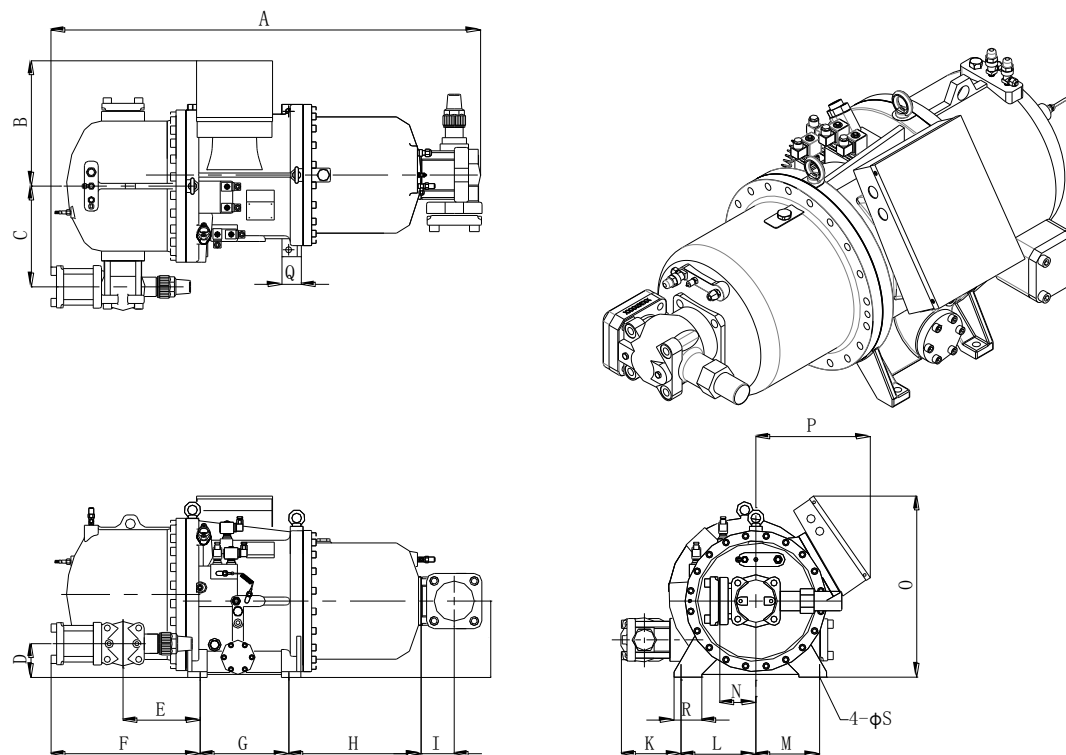

Model	RC2 -200APZ~620APZ external dimensions of horizontal discharge(Horizontal suction port for 620)																		
	A	B	C	D	E	F	G	H	I	J	K	L	M	N	O	P	Q	R	S
RC2 -200APZ	1143	375	283	103	218	408	228	341	82	225	135	225	225	96	592	362	51	48	18
RC2 -230/260APZ	1300	400	326	118	241	452	251	399	97	257	169	240	240	107	622	386	55	48	18
RC2 -300APZ	1334	400	326	118	241	452	285	399	97	257	169	240	240	107	622	386	55	48	18
RC2 -310APZ	1352	400	326	118	241	452	251	444	97	257	169	240	240	107	622	386	55	48	18
RC2 -340/370APZ	1407	400	326	118	241	452	285	447	103	257	169	240	240	132	622	386	55	48	18
RC2 -410APZ	1463	448	365	122	277	517	288	433	103	275	220	270	230	132	652	408	70	100	22
RC2 -470APZ	1496	448	365	122	277	517	320	433	103	275	220	270	230	132	652	408	70	100	22
RC2 -510A PZ	1515	490	365	122	277	517	288	484	103	275	220	270	230	132	638	450	70	100	22
RC2 -550APZ	1534	490	365	126	272	512	320	477	103	280	220	270	230	132	642	450	70	100	22
RC2 -580A PZ	1534	490	365	122	277	517	320	484	103	275	220	270	230	132	638	450	70	100	22
RC2 -620A PZ	1819	490	379	140	331	615	320	525	220	280	251	270	230	161	642	450	70	100	22

▲Dimension unit: mm

RC2 -620APZ~930APZ Drawing (Vertical suction port for 620)

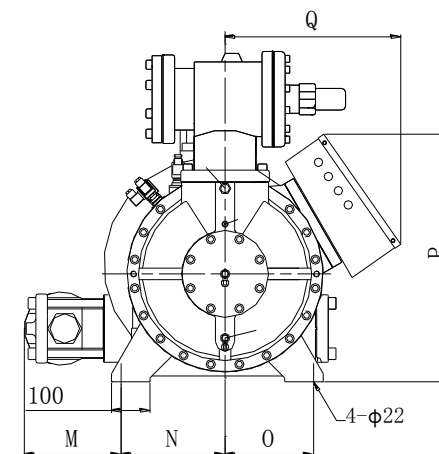
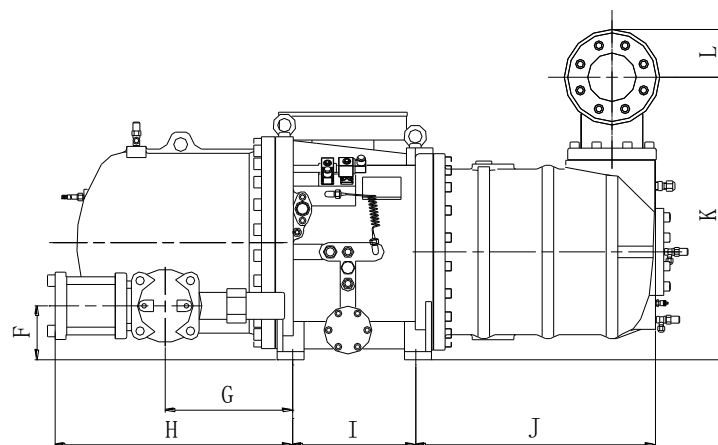
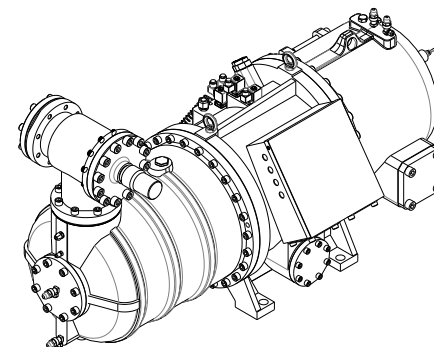
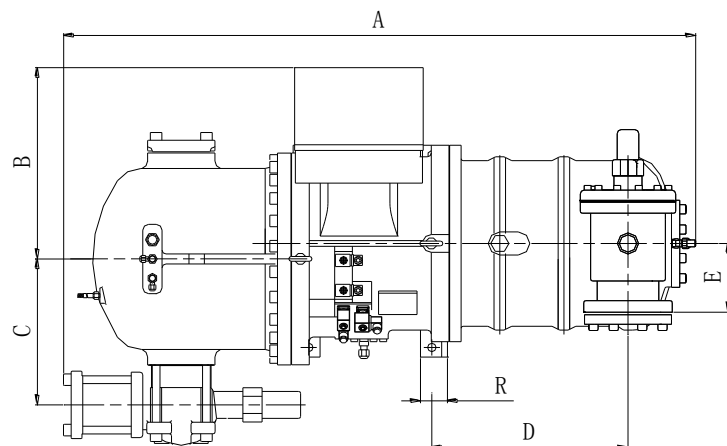

Model	RC2 -620APZ~930APZ External dimension of horizontal oil separator(vertical suction port)																	
	A	B	C	D	E	F	G	H	I	J	K	L	M	N	O	P	Q	R
RC2 -620APZ	1657	490	379	510	161	140	331	615	320	623	738	124	251	270	230	642	450	70
RC2 -710APZ	1710	505	379	515	161	185	346	630	353	628	808	124	250	270	230	682	465	80
RC2 -790/830APZ	1805	505	379	515	161	185	346	630	418	628	808	124	250	270	230	682	465	80
RC2 -930APZ	1852	509	379	585	161	185	346	630	418	698	808	124	250	270	230	682	465	80

▲Dimension unit: mm

RC2-100APZ&140APZ Drawing

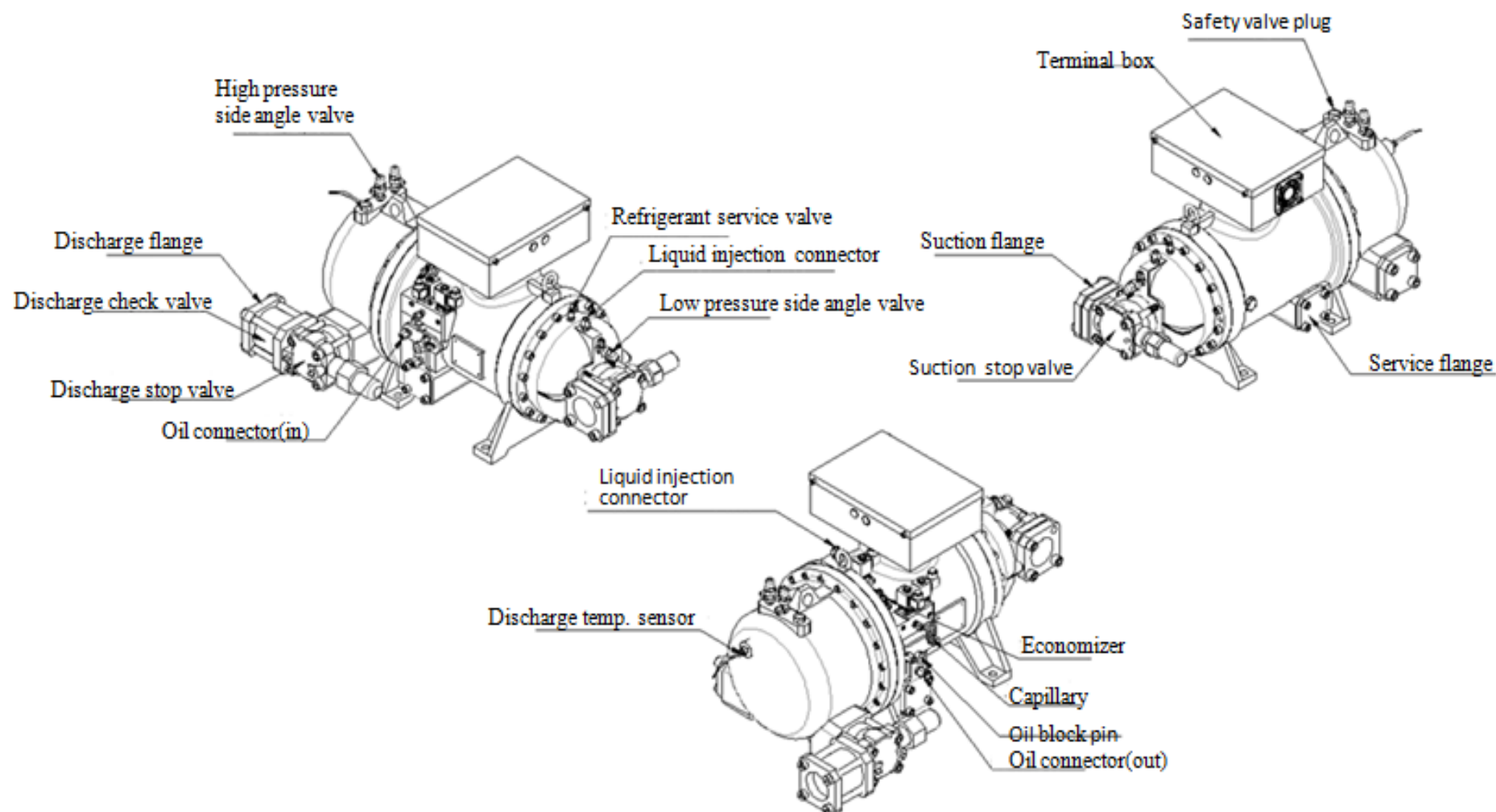

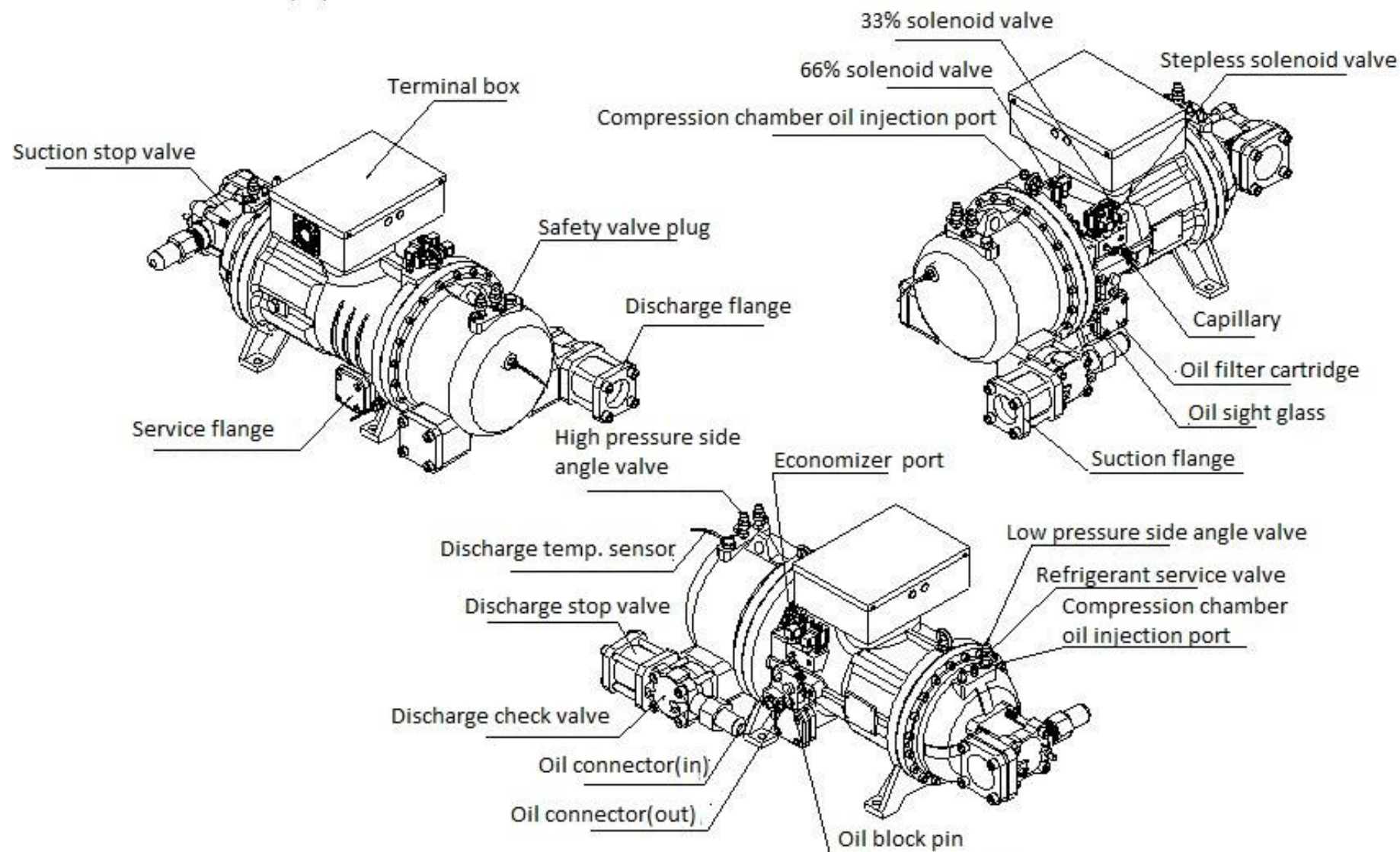
RC2-180APZ Drawing

RC2-200APZ ~620APZ Drawing (Horizontal suction port for 620)

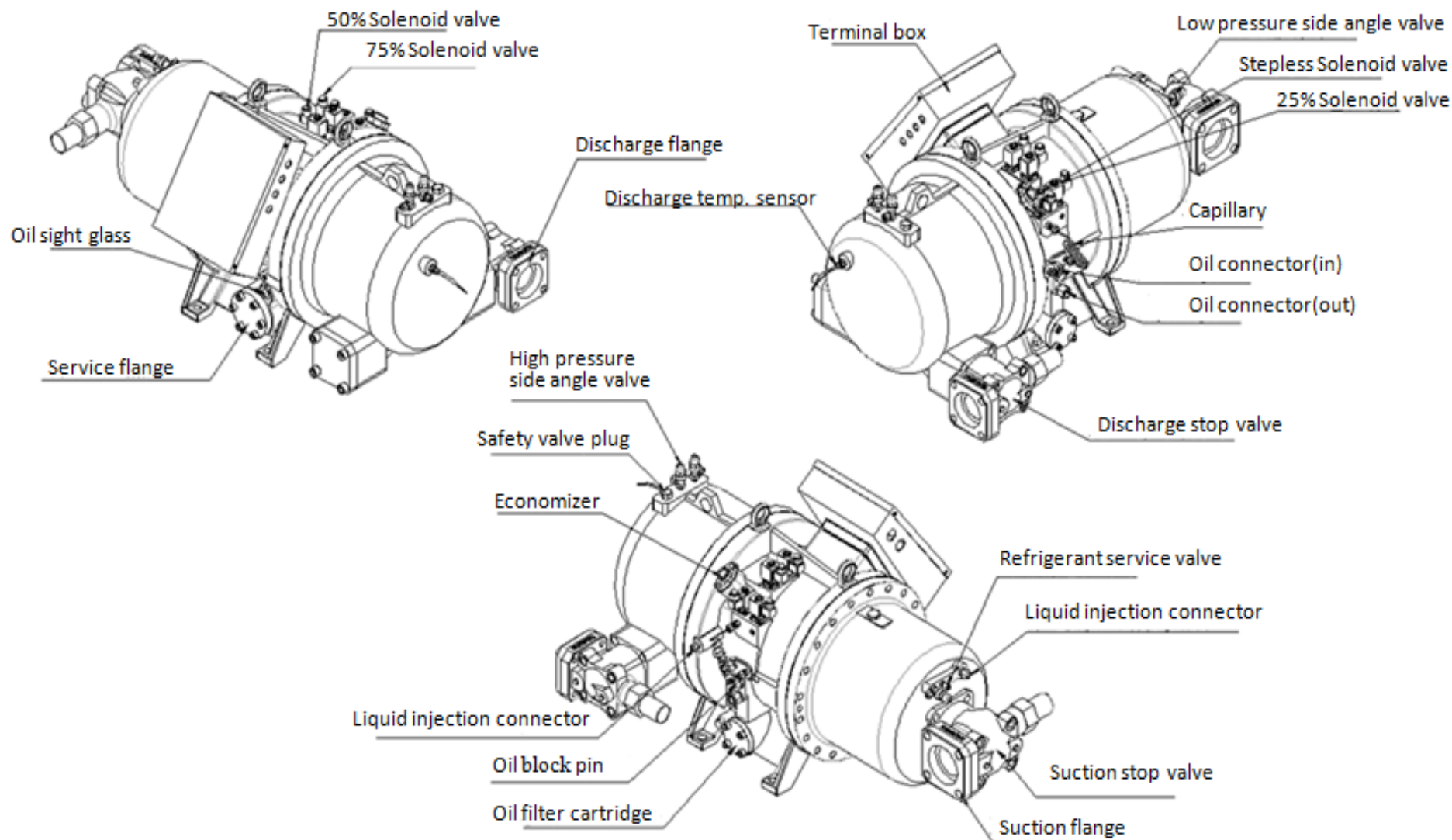

RC2-620APZ ~930APZ Drawing (Vertical suction port for 620)

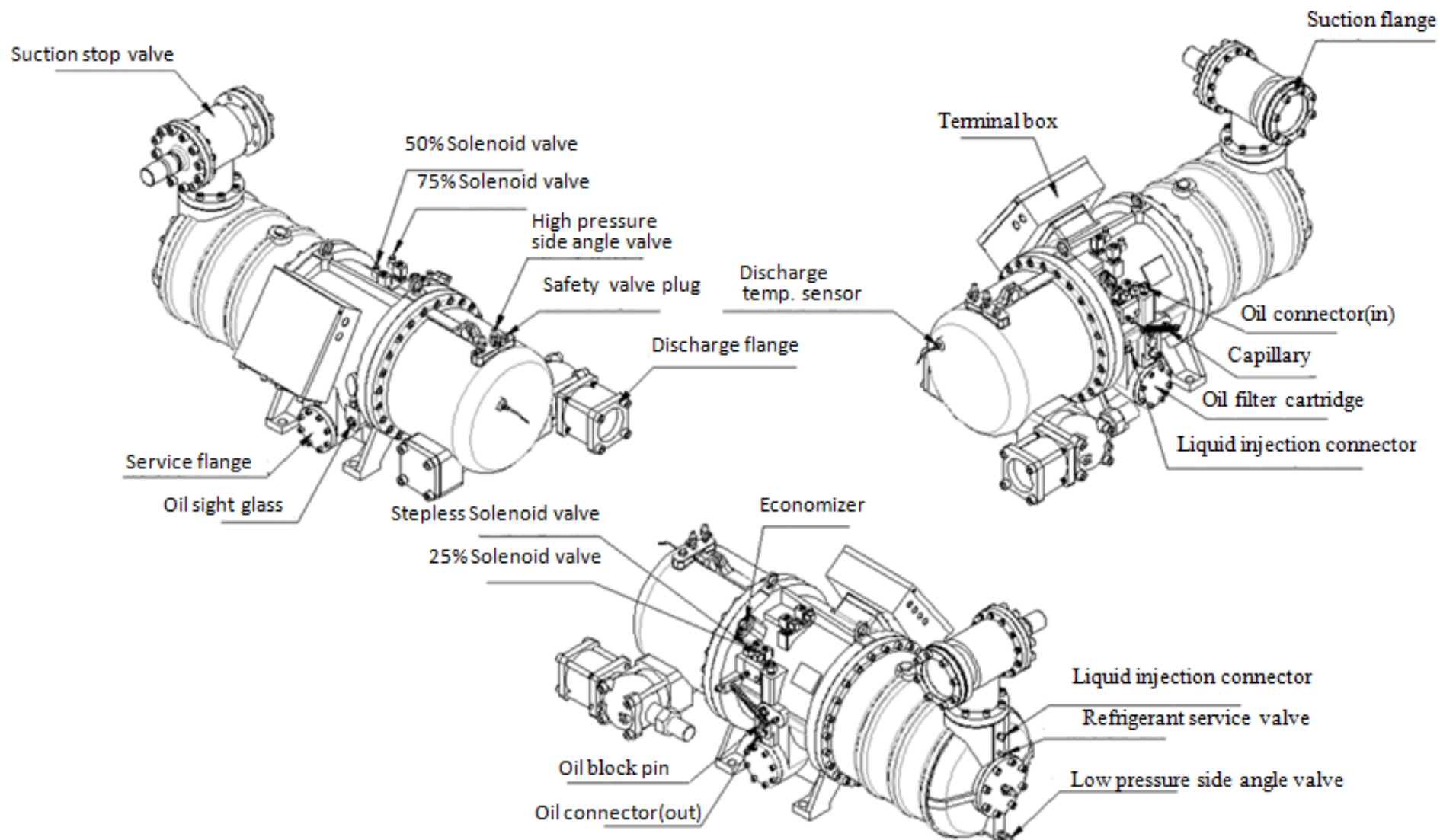

Specification of RC2 -100AZ~930AZ (standard oil separator) connector

Mode	Discharge flange	Cooper pipe	Steel pipe	Suction flange	Cooper pipe	Steel pipe	Economizer	Main return port	Oil injection port	Liquid injection connector
RC2 -100	1-1/2"	Φ42	Φ49.3	2"	Φ55	Φ61.3	5/8" Flare (16.1)	3/8"Flare (9.7)	3/8"Flare (9.7)	3/8"Flare (9.7)
RC2 -140	1-1/2"			2"			5/8" Flare (16.1)	3/8"Flare (9.7)	3/8"Flare (9.7)	3/8"Flare (9.7)
RC2 -180	1-1/2"			2-1/2"	Φ68	Φ77.2	5/8" Flare (16.1)	3/8"Flare (9.7)	3/8"Flare (9.7)	5/8"Flare (16)
RC2 -200	1-1/2"			2-1/2"			5/8" Flare (16.1)	5/8"Flare (16)	3/8"Flare (9.7)	5/8"Flare (16)
RC2 -230	2"	Φ55	Φ61.3	3"	Φ80.5	Φ90.2	5/8" Flare (16.1)	5/8"Flare (16)	3/8"Flare (9.7)	5/8"Flare (16)
RC2 -260	2"			3"			5/8" Flare (16.1)	5/8"Flare (16)	3/8"Flare (9.7)	5/8"Flare (16)
RC2 -300	2"			3"			7/8" Flare (22.4)	5/8"Flare (16)	3/8"Flare (9.7)	5/8"Flare (16)
RC2 -310	2"			3"			7/8" Flare (22.4)	5/8"Flare (16)	3/8"Flare (9.7)	5/8"Flare (16)
RC2 -340	2-1/2"	Φ68	Φ77.2	4"	Φ93	Φ110	7/8" Flare (22.4)	5/8"Flare (16)	3/8"Flare (9.7)	5/8"Flare (16)
RC2 -370	2-1/2"			4"			7/8" Flare (22.4)	5/8"Flare (16)	3/8"Flare (9.7)	5/8"Flare (16)
RC2 -410	2-1/2"			4"			7/8" Flare (22.4)	5/8"Flare (16)	3/8"Flare (9.7)	5/8"Flare (16)
RC2 -470	2-1/2"			4"			7/8" Flare (22.4)	5/8"Flare (16)	3/8"Flare (9.7)	5/8"Flare (16)
RC2 -510	3"	Φ80.5	Φ90.2	4"	Φ106	Φ135	7/8" Flare (22.4)	5/8"Flare (16)	3/8"Flare (9.7)	5/8"Flare (16)
RC2 -550	3"			4"			1-1/8" Flare (28.8)	5/8"Flare (16)	3/8"Flare (9.7)	5/8"Flare (16)
RC2 -580	3"			4"			1-1/8" Flare (28.8)	5/8"Flare (16)	3/8"Flare (9.7)	5/8"Flare (16)
RC2 -620	3"			5"			1-1/8" Flare (28.8)	5/8"Flare (16)	3/8"Flare (9.7)	5/8"Flare (16)
RC2 -710	4"	Φ93	Φ110	5"	Φ106	Φ135	1-1/8" Flare (28.8)	3/4"Flare (19.2)	3/8"Flare (9.7)	5/8"Flare (16)
RC2 -790	4"			5"			1-1/8" Flare (28.8)	3/4"Flare (19.2)	3/8"Flare (9.7)	5/8"Flare (16)
RC2 -830	4"			5"			1-1/8" Flare (28.8)	3/4"Flare (19.2)	3/8"Flare (9.7)	5/8"Flare (16)
RC2 -930	4"			5"			1-1/8" Flare (28.8)	3/4"Flare (19.2)	3/8"Flare (9.7)	5/8"Flare (16)

Specification of RC2 -100AZ~930AZ (Horizontal oil separator) connector

Mode	Discharge flange	Cooper pipe	Steel pipe	Suction flange	Cooper pipe	Steel pipe	Economizer	Main return port	Oil injection port	Liquid injection
RC2 -100P	2"	Φ55	Φ61.3	2"	Φ55	Φ61.3	5/8" Flare (16.1)	3/8"Flare (9.7)	3/8"Flare (9.7)	3/8"Flare (9.7)
RC2 -140P	2"			2"			5/8" Flare (16.1)	3/8"Flare (9.7)	3/8"Flare (9.7)	3/8"Flare (9.7)
RC2 -180P	2"			2-1/2"	Φ68	Φ77.2	5/8" Flare (16.1)	3/8"Flare (9.7)	3/8"Flare (9.7)	5/8"Flare (16)
RC2 -200P	2"			2-1/2"			5/8" Flare (16.1)	5/8"Flare (16)	3/8"Flare (9.7)	5/8"Flare (16)
RC2 -230P	2-1/2"	Φ68	Φ77.2	3"	Φ80.5	Φ90.2	5/8" Flare (16.1)	5/8"Flare (16)	3/8"Flare (9.7)	5/8"Flare (16)
RC2 -260P	2-1/2"			3"			5/8" Flare (16.1)	5/8"Flare (16)	3/8"Flare (9.7)	5/8"Flare (16)
RC2 -300P	2-1/2"			3"			7/8" Flare (22.4)	5/8"Flare (16)	3/8"Flare (9.7)	5/8"Flare (16)
RC2 -310P	2-1/2"			3"			7/8" Flare (22.4)	5/8"Flare (16)	3/8"Flare (9.7)	5/8"Flare (16)
RC2 -340P	2-1/2"			4"	Φ93	Φ110	7/8" Flare (22.4)	5/8"Flare (16)	3/8"Flare (9.7)	5/8"Flare (16)
RC2 -370P	2-1/2"			4"			7/8" Flare (22.4)	5/8"Flare (16)	3/8"Flare (9.7)	5/8"Flare (16)
RC2 -410P	3"	Φ80.5	Φ90.2	4"			7/8" Flare (22.4)	5/8"Flare (16)	3/8"Flare (9.7)	5/8"Flare (16)
RC2 -470P	3"			4"			7/8" Flare (22.4)	5/8"Flare (16)	3/8"Flare (9.7)	5/8"Flare (16)
RC2 -510P	3"			4"			7/8" Flare (22.4)	5/8"Flare (16)	3/8"Flare (9.7)	5/8"Flare (16)
RC2 -550P	3"			4"			1-1/8" Flare (28.8)	5/8"Flare (16)	3/8"Flare (9.7)	5/8"Flare (16)
RC2 -580P	3"			4"			1-1/8" Flare (28.8)	5/8"Flare (16)	3/8"Flare (9.7)	5/8"Flare (16)
RC2 -620P	4"	Φ93	Φ110	5"	Φ106	Φ135	1-1/8" Flare (28.8)	5/8"Flare (16)	3/8"Flare (9.7)	5/8"Flare (16)
RC2 -710P	4"			5"			1-1/8" Flare (28.8)	3/4"Flare (19.2)	3/8"Flare (9.7)	5/8"Flare (16)
RC2 -790P	4"			5"			1-1/8" Flare (28.8)	3/4"Flare (19.2)	3/8"Flare (9.7)	5/8"Flare (16)
RC2 -830P	4"			5"			1-1/8" Flare (28.8)	3/4"Flare (19.2)	3/8"Flare (9.7)	5/8"Flare (16)
RC2 -930P	4"			5"			1-1/8" Flare (28.8)	3/4"Flare (19.2)	3/8"Flare (9.7)	5/8"Flare (16)

Application Limits

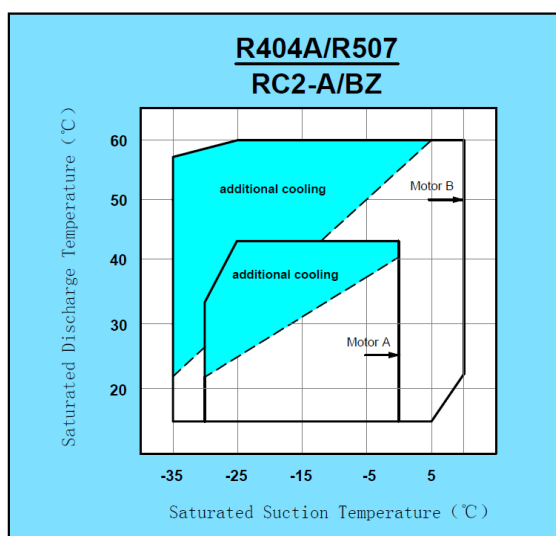
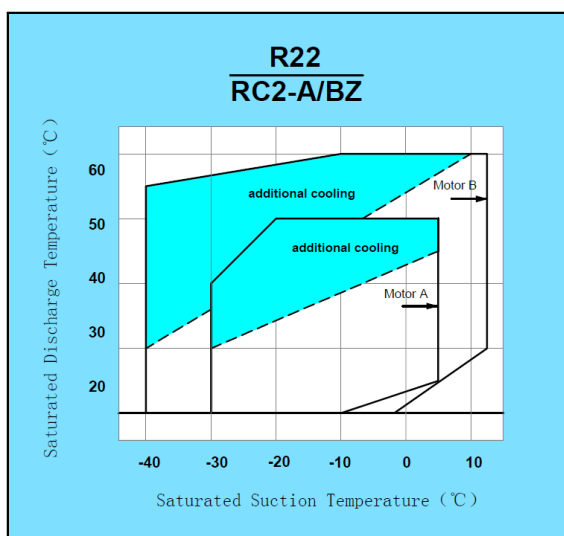

Official website



Official WeChat



Electronic Brochures



上海漢鐘精機股份有限公司
SHANGHAI HANBELL PRECISE MACHINERY CO., LTD.

No.8289, Tingfeng Road, Fengjing Area, Jinshan District, Shanghai, China

TEL: 021-57350280 FAX: 021-51368588

Service Line: 4007702158

P.C.: 201501

http: //www.hanbell.com.cn

SHANGHAI HANBELL PRECISE MACHINERY CO.,LTD.

JINAN BRANCH

No.4 Building, Liando U Valley International Enterprise Port, No. 2222, South Section of Yuqing Road, Changqing District, Jinan, Shandong Prov.

TEL: 0531-85060075 FAX: 0531-85060071

SHANGHAI HANBELL PRECISE MACHINERY CO.,LTD.

NANJING BRANCH

No.95, Gaohu Road, Jiangning District, Nanjing City

TEL: 025-52078091/1/3 FAX: 025-52078090

SHANGHAI HANBELL PRECISE MACHINERY CO.,LTD.

GUANGZHOU BRANCH

No.15 Wenkeng Road Lianwang Industrial Park, Guangzhou, Guangdong Prov.

TEL: 020-34721075 FAX: 020-3472325

SHANGHAI HANBELL PRECISE MACHINERY CO.,LTD.

CHONGQING BRANCH

Building A10, Dongben Industrial Park, No.18, Yu Ma Road, chayuan New District, Chongqing, China

TEL: 023-62611068 FAX: 023-62611069