



RC2-B(P)-Z Series

RC2-B(P)-Z Series Screw Compressor



RC2-B (P) -Z Series Compressor

Product Description

Hanbell RC-B(P)-Z series compressor is suitable for air cooling requirement of high-load working conditions such as freeze, refrigeration, ocean fishing, cold chain logistics, ice-making system etc.



Hanbell RC2-B(P)-Z series models have the most universal applicability which are suitable for wide range working condition including water-cooled and air-cooled. Now whole series have over 20 models with the capacity range from 98 m³/h to 929 m³/h. This technical data only contains RC2-BZ design features, model specifications, operating range, configuration list, suction and discharge interface, performance data, appearance chart; if you need the information about design, installation, maintenance, accessories, application system and basic troubleshooting, please read Hanbell RC2-B(P)-Z Technical Manual.

Nomenclature

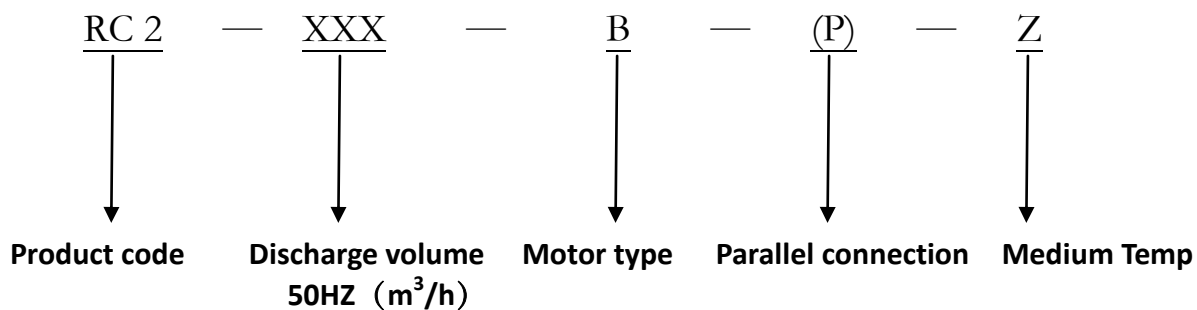

Product Feature

Patent rotor

HANBELL high-efficient rotor profile with 5:6 gear ratio has obtained several international patent in China/Europe/USA/Japan.



Long life-time bearing

Long life-time bearings can provide more stable and longer time operation.



High-efficient motor

With low-loss silicon steel core, motor cooling channel, refrigerant diversion design; the compressor can ensure the motor operate stably and high-efficiently in harsh conditions for a long time.

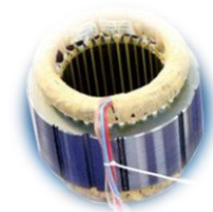

Back-office protection module

Based on original protection module INT69, INT69HBY Diagnose is updated with protection for anti-phase and phase-loss, new fault record function; which can protect the compressor more comprehensively.



Technology of parallel connection

According to the demand, customer can choose to single machine or multi-machine parallel connection



Model	Compressor					Motor					Fuel quantity	Oil heater	Strength test (air pressure)	Weight
	Discharge volume 50Hz m³/h	Rotation speed 50Hz r/min	Vi valve	Capacity control (%)	Lubrication	Type	Start model	Voltage (V) 50Hz	Insulation level	Protection	L	W	kg/cm²G	kg
RC2-100-B(P)-Z	98	2950	3.5	33/66/100%	Differential pressure type	3-phase 2-pole AC asynchronous motor	Y-Δ	380	Level F	PTC, Temp sensor and protection module for anti-phase and phase-loss	7	300	35	275
RC2-140-B(P)-Z	137										7			280
RC2-180-B(P)-Z	180										7			320
RC2-200-B(P)-Z	193			8							420			
RC2-230-B(P)-Z	230			14							540			
RC2-260-B(P)-Z	257			14							545			
RC2-300-B(P)-Z	293			16							590			
RC2-310-B(P)-Z	308			14							575			
RC2-340-B(P)-Z	339			16							600			
RC2-370-B(P)-Z	366			16							610			
RC2-410-B(P)-Z	407			15							730			
RC2-470-B(P)-Z	471			18							800			
RC2-510-B(P)-Z	508			20							760			
RC2-550-B(P)-Z	549			23							820			
RC2-580-B(P)-Z	583			20							805			
RC2-620-B(P)-Z	619			23							850			
RC2-710-B(P)-Z	713			23							1099			
RC2-790-B(P)-Z	791			28							1140			
RC2-830-B(P)-Z	825			28							1150			
RC2-930-B(P)-Z	929			28							1180			
RC2-1020-B(P)-Z	1017			40							1540			
RC2-1130-B(P)-Z	1122			40							1560			
RC2-1270-B(P)-Z	1268			53							2200			
RC2-1530-B(P)-Z	1539			53							2300			

Performance Form (Without ECO)

RC2-100B-Z,R22							
Saturated Discharge Temp℃	Saturated Suction Temp℃	-40	-30	-20	-10	0	10
30	Refrigerating capacity (kW)	14.4	25.3	40.4	61.4	89.9	127.6
	Power (kW)	13.9	15.0	16.4	17.8	19.0	19.7
	Current(A)	27.2	28.6	30.5	32.4	34.0	35.1
	COP	1.041	1.686	2.465	3.456	4.741	6.472
40	Refrigerating capacity (kW)	12.1	21.1	35.1	54.1	80.3	114.9
	Power (kW)	16.7	18.0	19.5	21.2	22.7	23.8
	Current(A)	30.9	32.6	34.8	37.2	39.3	41.0
	COP	0.728	1.174	1.795	2.555	3.542	4.830
50	Refrigerating capacity (kW)	13.3	23.5	37.9	58.1	85.2	121.4
	Power (kW)	15.2	16.4	17.9	19.4	20.7	21.6
	Current(A)	28.9	30.5	32.5	34.6	36.5	37.8
	COP	0.875	1.429	2.116	2.994	4.115	5.611
60	Refrigerating capacity (kW)	--	--	--	35.1	56.2	84.4
	Power (kW)	--	--	--	30.0	32.5	34.6
	Current(A)	--	--	--	50.7	54.7	58.3
	COP	--	--	--	1.168	1.732	2.438

RC2-140B-Z,R22							
Saturated Discharge Temp℃	Saturated Suction Temp℃	-40	-30	-20	-10	0	10
30	Refrigerating capacity (kW)	20.0	35.1	55.9	84.9	124.2	176.2
	Power (kW)	18.3	19.8	21.7	23.5	25.1	26.1
	Current(A)	36.1	38.1	40.5	43.0	45.1	46.5
	COP	1.092	1.769	2.580	3.612	4.956	6.765
40	Refrigerating capacity (kW)	16.9	29.2	48.6	74.9	110.9	158.7
	Power (kW)	22.0	23.7	25.8	28.0	30.0	31.4
	Current(A)	41.0	43.3	46.2	49.3	52.1	54.3
	COP	0.765	1.231	1.882	2.674	3.702	5.049
50	Refrigerating capacity (kW)	13.4	23.8	40.0	63.2	95.4	139.3
	Power (kW)	26.3	28.3	30.8	33.4	35.9	38.0
	Current(A)	46.8	49.7	53.3	57.3	61.1	64.4
	COP	0.509	0.842	1.298	1.891	2.657	3.665
60	Refrigerating capacity (kW)	--	--	--	48.7	77.9	116.7
	Power (kW)	--	--	--	39.7	42.9	45.7
	Current(A)	--	--	--	67.1	72.3	77.0
	COP	--	--	--	1.225	1.816	2.552

RC2-180B-Z,R22							
Saturated Discharge Temp℃	Saturated Suction Temp℃	-40	-30	-20	-10	0	10
30	Refrigerating capacity (kW)	26.4	46.2	73.7	111.4	163.0	231.3
	Power (kW)	23.0	24.9	27.2	29.5	31.5	32.7
	Current(A)	47.1	49.5	52.4	55.4	58.1	59.8
	COP	1.146	1.855	2.710	3.777	5.182	7.073
40	Refrigerating capacity (kW)	22.3	39.5	64.0	98.4	145.6	208.3
	Power (kW)	27.7	29.8	32.4	35.2	37.6	39.5
	Current(A)	53.0	55.8	59.4	63.1	66.6	69.3
	COP	0.804	1.323	1.973	2.799	3.871	5.279
50	Refrigerating capacity (kW)	17.7	31.4	52.7	83.2	125.4	182.8
	Power (kW)	33.0	35.5	38.6	41.9	45.1	47.7
	Current(A)	60.1	63.6	68.1	72.9	77.6	81.5
	COP	0.537	0.884	1.365	1.982	2.781	3.831
60	Refrigerating capacity (kW)	--	--	--	65.5	102.6	153.4
	Power (kW)	--	--	--	49.9	53.9	57.4
	Current(A)	--	--	--	84.8	91.1	96.8
	COP	--	--	--	1.314	1.904	2.672

RC2-200B-Z,R22							
Saturated Discharge Temp℃	Saturated Suction Temp℃	-40	-30	-20	-10	0	10
30	Refrigerating capacity (kW)	28.3	49.6	78.9	119.7	175.1	248.6
	Power (kW)	25.3	27.4	29.9	32.5	34.6	36.0
	Current(A)	50.0	52.7	56.0	59.4	62.4	64.3
	COP	1.116	1.808	2.636	3.687	5.059	6.905
40	Refrigerating capacity (kW)	23.8	42.2	68.7	105.7	156.5	223.8
	Power (kW)	30.5	32.8	35.7	38.7	41.4	43.4
	Current(A)	56.7	59.9	63.9	68.2	72.1	75.1
	COP	0.783	1.288	1.924	2.731	3.779	5.154
50	Refrigerating capacity (kW)	18.9	33.7	56.5	89.2	134.7	196.4
	Power (kW)	36.3	39.1	42.5	46.2	49.6	52.5
	Current(A)	64.7	68.7	73.7	79.2	84.5	89.0
	COP	0.522	0.861	1.329	1.933	2.713	3.741
60	Refrigerating capacity (kW)	--	--	--	68.7	110.0	164.7
	Power (kW)	--	--	--	54.9	59.3	63.2
	Current(A)	--	--	--	92.7	99.9	106.4
	COP	--	--	--	1.253	1.857	2.607

RC2-230B-Z,R22							
Saturated Discharge Temp℃	Saturated Suction Temp℃	-40	-30	-20	-10	0	10
30	Refrigerating capacity (kW)	35.2	61.7	98.3	148.7	217.5	308.8
	Power (kW)	30.4	32.9	35.9	38.9	41.5	43.1
	Current(A)	59.4	62.8	66.9	71.3	75.0	77.5
	COP	1.161	1.879	2.742	3.822	5.243	7.158
40	Refrigerating capacity (kW)	29.7	52.7	85.5	131.4	194.4	278.0
	Power (kW)	36.5	39.3	42.8	46.4	49.6	52.0
	Current(A)	67.9	71.9	76.9	82.3	87.2	90.9
	COP	0.815	1.341	1.998	2.834	3.917	5.342
50	Refrigerating capacity (kW)	23.7	42.0	70.5	111.1	167.5	244.0
	Power (kW)	43.5	46.8	51.0	55.3	59.5	62.9
	Current(A)	78.0	83.0	89.3	96.0	102.5	107.9
	COP	0.544	0.896	1.384	2.007	2.815	3.877
60	Refrigerating capacity (kW)	--	--	--	87.6	137.0	204.8
	Power (kW)	--	--	--	65.8	71.0	75.7
	Current(A)	--	--	--	112.3	120.8	128.4
	COP	--	--	--	1.332	1.929	2.705

RC2-260B-Z,R22							
Saturated Discharge Temp℃	Saturated Suction Temp℃	-40	-30	-20	-10	0	10
30	Refrigerating capacity (kW)	37.9	66.4	105.9	160.1	234.3	332.5
	Power (kW)	33.1	35.9	39.1	42.5	45.3	47.1
	Current(A)	63.2	66.9	71.6	76.5	80.7	83.4
	COP	1.144	1.852	2.705	3.771	5.173	7.062
40	Refrigerating capacity (kW)	32.0	56.7	92.0	141.4	209.3	299.4
	Power (kW)	39.8	42.9	46.7	50.6	54.2	56.8
	Current(A)	72.6	77.2	82.8	88.7	94.2	98.3
	COP	0.803	1.321	1.970	2.795	3.865	5.271
50	Refrigerating capacity (kW)	25.4	45.1	75.8	119.5	180.3	262.7
	Power (kW)	47.4	51.1	55.6	60.4	64.9	68.7
	Current(A)	83.9	89.5	96.4	103.9	111.0	117.0
	COP	0.536	0.883	1.363	1.979	2.777	3.825
60	Refrigerating capacity (kW)	--	--	--	94.2	147.4	220.5
	Power (kW)	--	--	--	71.8	77.5	82.6
	Current(A)	--	--	--	122.0	131.4	139.9
	COP	--	--	--	1.312	1.901	2.668

RC2-300B-Z,R22							
Saturated Discharge Temp℃	Saturated Suction Temp℃	-40	-30	-20	-10	0	10
30	Refrigerating capacity (kW)	44.8	78.5	124.8	188.7	276.1	391.8
	Power (kW)	37.6	40.7	44.4	48.2	51.4	53.4
	Current(A)	70.8	75.2	80.6	86.1	90.9	94.0
	COP	1.192	1.929	2.810	3.917	5.374	7.335
40	Refrigerating capacity (kW)	37.9	67.1	108.6	167.3	246.6	352.8
	Power (kW)	45.2	48.7	53.0	57.4	61.4	64.4
	Current(A)	81.7	86.9	93.3	100.1	106.4	111.0
	COP	0.837	1.379	2.051	2.915	4.015	5.475
50	Refrigerating capacity (kW)	30.1	53.4	89.7	141.1	212.6	309.6
	Power (kW)	53.8	58.0	63.1	68.5	73.6	77.9
	Current(A)	94.6	101.0	108.9	117.4	125.6	132.4
	COP	0.560	0.920	1.422	2.060	2.887	3.974
60	Refrigerating capacity (kW)	--	--	--	111.5	174.1	260.1
	Power (kW)	--	--	--	81.4	88.0	93.8
	Current(A)	--	--	--	138.1	148.9	158.7
	COP	--	--	--	1.369	1.979	2.774

RC2-310B-Z,R22							
Saturated Discharge Temp℃	Saturated Suction Temp℃	-40	-30	-20	-10	0	10
30	Refrigerating capacity (kW)	47.3	82.9	131.8	199.3	291.7	414.0
	Power (kW)	40.0	43.3	47.2	51.2	54.6	56.8
	Current(A)	74.2	78.9	84.7	90.7	95.9	99.2
	COP	1.183	1.915	2.791	3.890	5.338	7.286
40	Refrigerating capacity (kW)	40.0	70.9	114.7	176.8	260.6	372.8
	Power (kW)	48.1	51.8	56.3	61.1	65.3	68.5
	Current(A)	86.0	91.6	98.5	105.8	112.5	117.5
	COP	0.831	1.368	2.036	2.895	3.988	5.438
50	Refrigerating capacity (kW)	31.8	56.4	94.7	149.0	224.6	327.1
	Power (kW)	57.2	61.7	67.1	72.9	78.3	82.9
	Current(A)	99.9	106.8	115.2	124.3	133.1	140.5
	COP	0.556	0.914	1.411	2.045	2.867	3.947
60	Refrigerating capacity (kW)	--	--	--	117.7	183.9	274.7
	Power (kW)	--	--	--	86.6	93.6	99.7
	Current(A)	--	--	--	146.6	158.4	169.1
	COP	--	--	--	1.359	1.965	2.755

RC2-340B-Z,R22							
Saturated Discharge Temp℃	Saturated Suction Temp℃	-40	-30	-20	-10	0	10
30	Refrigerating capacity (kW)	52.8	92.4	146.8	221.9	324.8	460.9
	Power (kW)	43.6	47.2	51.5	55.9	59.6	62.0
	Current(A)	81.7	86.8	93.1	99.5	105.1	108.7
	COP	1.210	1.958	2.850	3.972	5.450	7.439
40	Refrigerating capacity (kW)	44.6	79.1	127.8	196.8	290.1	415.0
	Power (kW)	52.4	56.5	61.4	66.6	71.3	74.8
	Current(A)	94.4	100.4	107.9	115.8	123.1	128.5
	COP	0.851	1.401	2.081	2.956	4.072	5.552
50	Refrigerating capacity (kW)	35.5	62.9	105.7	166.1	250.2	364.2
	Power (kW)	62.4	67.3	73.2	79.5	85.4	90.4
	Current(A)	109.5	116.9	126.1	136.0	145.5	153.4
	COP	0.569	0.935	1.444	2.090	2.929	4.030
60	Refrigerating capacity (kW)	--	--	--	131.3	204.9	306.0
	Power (kW)	--	--	--	94.4	102.0	108.8
	Current(A)	--	--	--	160.1	172.7	184.2
	COP	--	--	--	1.391	2.009	2.814

RC2-370B-Z,R22							
Saturated Discharge Temp℃	Saturated Suction Temp℃	-40	-30	-20	-10	0	10
30	Refrigerating capacity (kW)	56.8	99.5	158.1	239.0	349.8	496.4
	Power (kW)	47.3	51.2	55.9	60.6	64.7	67.2
	Current(A)	87.0	92.6	99.6	106.7	112.9	116.8
	COP	1.200	1.943	2.829	3.943	5.410	7.384
40	Refrigerating capacity (kW)	48.0	85.1	137.6	212.0	312.5	447.0
	Power (kW)	56.9	61.3	66.7	72.2	77.3	81.1
	Current(A)	101.1	107.7	115.9	124.6	132.6	138.6
	COP	0.844	1.389	2.065	2.934	4.042	5.511
50	Refrigerating capacity (kW)	38.2	67.7	113.7	178.9	269.4	392.3
	Power (kW)	67.7	73.0	79.4	86.2	92.7	98.1
	Current(A)	117.6	125.8	135.9	146.7	157.2	166.0
	COP	0.564	0.927	1.432	2.074	2.907	4.000
60	Refrigerating capacity (kW)	--	--	--	141.3	220.6	329.6
	Power (kW)	--	--	--	102.5	110.7	118.0
	Current(A)	--	--	--	173.4	187.6	200.6
	COP	--	--	--	1.379	1.993	2.793

RC2-410B-Z,R22							
Saturated Discharge Temp℃	Saturated Suction Temp℃	-40	-30	-20	-10	0	10
30	Refrigerating capacity (kW)	61.7	108.1	171.9	259.9	380.3	539.8
	Power (kW)	52.1	56.4	61.6	66.8	71.3	74.1
	Current(A)	94.1	100.1	107.5	115.2	122.0	126.4
	COP	1.183	1.915	2.791	3.890	5.338	7.286
40	Refrigerating capacity (kW)	52.1	92.4	149.5	230.5	339.8	486.0
	Power (kW)	62.7	67.5	73.4	79.6	85.2	89.4
	Current(A)	109.1	116.3	125.4	135.2	144.2	151.0
	COP	0.831	1.368	2.036	2.895	3.988	5.438
50	Refrigerating capacity (kW)	41.5	73.5	123.5	194.3	292.9	426.5
	Power (kW)	74.6	80.4	87.5	95.0	102.1	108.1
	Current(A)	127.3	136.5	147.9	160.3	172.2	182.2
	COP	0.556	0.914	1.411	2.045	2.867	3.947
60	Refrigerating capacity (kW)	--	--	--	153.4	239.7	358.2
	Power (kW)	--	--	--	112.9	122.0	130.0
	Current(A)	--	--	--	190.4	205.8	219.6
	COP	--	--	--	1.359	1.965	2.755

RC2-470B-Z,R22							
Saturated Discharge Temp℃	Saturated Suction Temp℃	-40	-30	-20	-10	0	10
30	Refrigerating capacity (kW)	75.0	131.3	208.8	315.6	461.9	655.5
	Power (kW)	62.4	67.6	73.8	80.0	85.3	88.7
	Current(A)	112.4	119.6	128.5	137.8	146.0	151.3
	COP	1.201	1.944	2.831	3.945	5.413	7.389
40	Refrigerating capacity (kW)	63.4	112.4	181.7	279.9	412.6	590.2
	Power (kW)	75.1	80.9	88.0	95.3	102.0	107.0
	Current(A)	130.4	139.1	150.1	161.8	172.6	180.8
	COP	0.844	1.390	2.066	2.936	4.044	5.515
50	Refrigerating capacity (kW)	50.5	89.4	150.2	236.2	355.8	517.9
	Power (kW)	89.4	96.3	104.8	113.8	122.3	129.4
	Current(A)	152.3	163.4	177.1	192.0	206.2	218.2
	COP	0.565	0.928	1.433	2.076	2.908	4.002
60	Refrigerating capacity (kW)	--	--	--	186.6	291.3	435.2
	Power (kW)	--	--	--	135.2	146.1	155.7
	Current(A)	--	--	--	228.0	246.5	263.1
	COP	--	--	--	1.380	1.994	2.795

RC2-510B-Z,R22							
Saturated Discharge Temp℃	Saturated Suction Temp℃	-40	-30	-20	-10	0	10
30	Refrigerating capacity (kW)	78.5	137.5	218.2	329.9	482.8	685.2
	Power (kW)	63.9	69.1	75.5	81.8	87.3	90.8
	Current(A)	119.7	126.6	135.2	144.2	152.1	157.2
	COP	1.229	1.989	2.892	4.031	5.530	7.549
40	Refrigerating capacity (kW)	66.4	117.8	190.2	292.6	431.3	617.0
	Power (kW)	76.8	82.7	90.0	97.5	104.4	109.5
	Current(A)	137.1	145.5	156.1	167.5	178.1	186.2
	COP	0.864	1.424	2.113	2.999	4.132	5.634
50	Refrigerating capacity (kW)	53.0	93.6	157.4	247.1	372.1	541.4
	Power (kW)	91.5	98.5	107.2	116.4	125.1	132.4
	Current(A)	158.3	169.0	182.5	197.2	211.5	223.4
	COP	0.579	0.950	1.468	2.123	2.973	4.089
60	Refrigerating capacity (kW)	--	--	--	195.5	304.9	455.1
	Power (kW)	--	--	--	138.3	149.5	159.3
	Current(A)	--	--	--	233.3	252.0	268.6
	COP	--	--	--	1.413	2.040	2.857

RC2-550B-Z,R22							
Saturated Discharge Temp℃	Saturated Suction Temp℃	-40	-30	-20	-10	0	10
30	Refrigerating capacity (kW)	86.7	151.9	241.3	364.9	533.9	757.8
	Power (kW)	71.9	77.8	84.9	92.1	98.2	102.1
	Current(A)	130.3	138.4	148.6	159.2	168.5	174.6
	COP	1.206	1.952	2.843	3.962	5.436	7.420
40	Refrigerating capacity (kW)	73.3	130.0	210.1	323.6	477.0	682.3
	Power (kW)	86.4	93.1	101.2	109.8	117.5	123.2
	Current(A)	150.8	160.7	173.2	186.6	198.9	208.3
	COP	0.848	1.397	2.076	2.948	4.061	5.538
50	Refrigerating capacity (kW)	58.4	103.4	173.7	273.1	411.3	598.8
	Power (kW)	102.9	110.9	120.6	131.0	140.8	149.0
	Current(A)	175.8	188.4	204.1	221.1	237.5	251.1
	COP	0.568	0.932	1.440	2.085	2.921	4.019
60	Refrigerating capacity (kW)	--	--	--	215.8	336.9	503.1
	Power (kW)	--	--	--	155.7	168.2	179.3
	Current(A)	--	--	--	262.5	283.7	302.7
	COP	--	--	--	1.387	2.003	2.807

RC2-580B-Z,R22							
Saturated Discharge Temp℃	Saturated Suction Temp℃	-40	-30	-20	-10	0	10
30	Refrigerating capacity (kW)	94.0	164.6	261.3	395.1	578.1	820.6
	Power (kW)	76.9	83.2	90.8	98.5	105.1	109.3
	Current(A)	137.2	146.2	157.4	169.0	179.2	185.8
	COP	1.222	1.977	2.877	4.009	5.501	7.509
40	Refrigerating capacity (kW)	79.5	141.0	227.7	350.4	516.5	738.9
	Power (kW)	92.5	99.6	108.3	117.4	125.7	131.8
	Current(A)	159.8	170.7	184.3	198.9	212.3	222.5
	COP	0.859	1.416	2.102	2.984	4.110	5.604
50	Refrigerating capacity (kW)	63.4	112.0	188.3	295.9	445.5	648.3
	Power (kW)	110.1	118.6	129.1	140.2	150.7	159.4
	Current(A)	187.1	200.8	217.9	236.4	254.0	268.8
	COP	0.576	0.944	1.459	2.111	2.957	4.068
60	Refrigerating capacity (kW)	--	--	--	234.0	365.0	544.9
	Power (kW)	--	--	--	166.6	179.9	191.8
	Current(A)	--	--	--	281.0	303.8	324.3
	COP	--	--	--	1.405	2.028	2.841

RC2-620B-Z,R22							
Saturated Discharge Temp℃	Saturated Suction Temp℃	-40	-30	-20	-10	0	10
30	Refrigerating capacity (kW)	97.6	170.8	271.4	410.3	600.4	852.1
	Power (kW)	80.5	87.1	95.0	103.1	109.9	114.3
	Current(A)	144.9	154.1	165.6	177.6	188.1	194.9
	COP	1.213	1.962	2.856	3.981	5.462	7.455
40	Refrigerating capacity (kW)	82.5	146.3	236.4	363.9	536.4	767.3
	Power (kW)	96.7	104.2	113.3	122.8	131.5	137.9
	Current(A)	168.1	179.3	193.4	208.5	222.4	232.9
	COP	0.853	1.404	2.086	2.962	4.080	5.564
50	Refrigerating capacity (kW)	65.7	116.3	195.4	307.1	462.6	673.3
	Power (kW)	115.2	124.1	135.0	146.6	157.6	166.7
	Current(A)	196.3	210.5	228.2	247.3	265.7	281.1
	COP	0.571	0.937	1.448	2.095	2.935	4.038
60	Refrigerating capacity (kW)	--	--	--	242.8	378.9	565.8
	Power (kW)	--	--	--	174.2	188.2	200.6
	Current(A)	--	--	--	293.8	317.6	338.9
	COP	--	--	--	1.394	2.013	2.820

RC2-710B-Z,R22							
Saturated Discharge Temp℃	Saturated Suction Temp℃	-40	-30	-20	-10	0	10
30	Refrigerating capacity (kW)	116.4	199.2	316.1	477.9	699.2	992.4
	Power (kW)	91.7	99.3	108.4	117.5	125.4	130.3
	Current(A)	169.0	178.9	191.1	203.8	215.0	222.2
	COP	1.269	2.007	2.917	4.066	5.578	7.614
40	Refrigerating capacity (kW)	96.3	170.8	275.6	423.8	624.7	893.6
	Power (kW)	110.3	118.8	129.2	140.1	149.9	157.2
	Current(A)	193.8	205.6	220.6	236.7	251.8	263.3
	COP	0.873	1.438	2.133	3.025	4.167	5.683
50	Refrigerating capacity (kW)	76.8	135.7	228.1	358.1	539.0	784.1
	Power (kW)	131.3	141.5	153.9	167.2	179.7	190.1
	Current(A)	223.7	238.9	258.1	279.1	299.8	317.4
	COP	0.585	0.959	1.482	2.142	2.999	4.125
60	Refrigerating capacity (kW)	--	--	--	283.4	441.7	659.3
	Power (kW)	--	--	--	198.7	214.6	228.8
	Current(A)	--	--	--	332.0	360.0	385.1
	COP	--	--	--	1.427	2.058	2.882

RC2-790B-Z,R22							
Saturated Discharge Temp℃	Saturated Suction Temp℃	-40	-30	-20	-10	0	10
30	Refrigerating capacity (kW)	125.3	214.4	340.2	514.3	752.6	1068.1
	Power (kW)	98.9	107.0	116.8	126.8	135.2	140.6
	Current(A)	182.0	192.7	205.9	219.6	231.7	239.5
	COP	1.266	2.002	2.911	4.058	5.567	7.599
40	Refrigerating capacity (kW)	103.6	183.8	296.6	456.1	672.4	961.8
	Power (kW)	119.0	128.1	139.4	151.1	161.7	169.6
	Current(A)	208.7	221.6	237.7	255.2	271.4	283.8
	COP	0.871	1.435	2.128	3.019	4.159	5.672
50	Refrigerating capacity (kW)	82.6	146.0	245.5	385.3	580.1	844.0
	Power (kW)	141.6	152.6	166.0	180.3	193.8	205.0
	Current(A)	241.1	257.5	278.2	301.0	323.3	342.3
	COP	0.584	0.957	1.479	2.138	2.993	4.116
60	Refrigerating capacity (kW)	--	--	--	305.0	475.4	709.6
	Power (kW)	--	--	--	214.2	231.4	246.7
	Current(A)	--	--	--	358.1	388.3	415.4
	COP	--	--	--	1.424	2.054	2.876

RC2-830B-Z,R22							
Saturated Discharge Temp℃	Saturated Suction Temp℃	-40	-30	-20	-10	0	10
30	Refrigerating capacity (kW)	136.3	233.3	370.3	559.8	819.1	1162.6
	Power (kW)	108.1	116.9	127.6	138.4	147.6	153.5
	Current(A)	198.2	209.8	224.3	239.4	252.6	261.2
	COP	1.261	1.995	2.901	4.044	5.548	7.573
40	Refrigerating capacity (kW)	112.7	200.0	322.7	496.4	731.8	1046.8
	Power (kW)	129.9	139.9	152.2	165.0	176.6	185.2
	Current(A)	227.5	241.5	259.3	278.4	296.2	309.8
	COP	0.867	1.429	2.121	3.009	4.145	5.652
50	Refrigerating capacity (kW)	89.9	158.9	267.1	419.3	631.4	918.6
	Power (kW)	154.7	166.7	181.3	196.9	211.7	223.9
	Current(A)	262.9	281.0	303.7	328.7	353.1	373.9
	COP	0.581	0.953	1.473	2.130	2.983	4.102
60	Refrigerating capacity (kW)	--	--	--	331.8	517.3	772.2
	Power (kW)	--	--	--	234.0	252.8	269.4
	Current(A)	--	--	--	391.3	424.3	454.0
	COP	--	--	--	1.418	2.047	2.866

RC2-930B-Z,R22							
Saturated Discharge Temp℃	Saturated Suction Temp℃	-40	-30	-20	-10	0	10
30	Refrigerating capacity (kW)	153.7	263.2	417.8	631.6	924.2	1311.7
	Power (kW)	122.1	132.1	144.2	156.4	166.8	173.4
	Current(A)	223.9	237.0	253.4	270.4	285.4	295.1
	COP	1.259	1.992	2.897	4.038	5.540	7.563
40	Refrigerating capacity (kW)	127.1	225.6	364.1	560.1	825.7	1181.1
	Power (kW)	146.8	158.1	171.9	186.4	199.5	209.2
	Current(A)	256.9	272.8	292.9	314.5	334.6	350.0
	COP	0.866	1.427	2.118	3.005	4.139	5.644
50	Refrigerating capacity (kW)	101.4	179.2	301.3	473.1	712.3	1036.4
	Power (kW)	174.8	188.3	204.9	222.4	239.1	253.0
	Current(A)	297.0	317.4	343.1	371.3	399.0	422.5
	COP	0.580	0.952	1.471	2.127	2.979	4.097
60	Refrigerating capacity (kW)	--	--	--	374.4	583.7	871.3
	Power (kW)	--	--	--	264.4	285.6	304.4
	Current(A)	--	--	--	442.1	479.5	513.0
	COP	--	--	--	1.416	2.044	2.862

RC2-1020B-Z,R22							
Saturated Discharge Temp℃	Saturated Suction Temp℃	-40	-30	-20	-10	0	10
30	Refrigerating capacity (kW)	173.4	296.8	471.1	712.2	1042.1	1479.0
	Power (kW)	137.0	148.2	161.8	175.5	187.2	194.6
	Current(A)	259.9	275.4	294.7	314.8	332.3	343.6
	COP	1.266	2.002	2.911	4.058	5.567	7.599
40	Refrigerating capacity (kW)	143.4	254.5	410.7	631.6	931.0	1331.8
	Power (kW)	164.7	177.4	193.0	209.2	223.9	234.8
	Current(A)	298.9	317.6	341.1	366.1	389.2	406.6
	COP	0.871	1.434	2.128	3.019	4.159	5.672
50	Refrigerating capacity (kW)	114.4	202.2	339.9	533.6	803.3	1168.6
	Power (kW)	196.1	211.3	229.9	249.6	268.4	283.9
	Current(A)	345.9	369.5	398.7	430.3	460.6	485.8
	COP	0.584	0.957	1.479	2.138	2.993	4.116
60	Refrigerating capacity (kW)	--	--	--	422.3	658.3	982.6
	Power (kW)	--	--	--	296.7	320.5	341.6
	Current(A)	--	--	--	506.7	546.0	581.1
	COP	--	--	--	1.424	2.054	2.876

RC2-1130B-Z,R22							
Saturated Discharge Temp℃	Saturated Suction Temp℃	-40	-30	-20	-10	0	10
30	Refrigerating capacity (kW)	198.8	339.4	537.8	813.0	1189.6	1688.5
	Power (kW)	152.4	164.9	180.0	195.2	208.2	216.5
	Current(A)	281.2	299.1	321.4	344.5	364.6	377.5
	COP	1.305	2.058	2.988	4.165	5.714	7.800
40	Refrigerating capacity (kW)	164.2	291.4	469.4	721.0	1062.8	1520.4
	Power (kW)	183.2	197.3	214.6	232.6	249.0	261.2
	Current(A)	326.3	347.8	374.6	403.1	429.2	448.9
	COP	0.896	1.477	2.187	3.099	4.269	5.821
50	Refrigerating capacity (kW)	131.2	231.4	389.0	609.9	917.5	1334.1
	Power (kW)	218.1	235.0	255.7	277.6	298.5	315.8
	Current(A)	380.1	406.9	440.0	475.6	509.7	538.1
	COP	0.601	0.985	1.522	2.197	3.074	4.225
60	Refrigerating capacity (kW)	--	--	--	483.4	752.5	1122.3
	Power (kW)	--	--	--	329.9	356.4	380.0
	Current(A)	--	--	--	561.6	605.9	645.8
	COP	--	--	--	1.465	2.111	2.954

RC2-1270B-Z,R22							
Saturated Discharge Temp °C	Saturated Suction Temp °C	-40	-30	-20	-10	0	10
30	Refrigerating capacity (kW)	223.1	380.8	603.3	912.1	1334.6	1894.3
	Power (kW)	170.2	184.2	201.0	218.1	232.6	241.8
	Current(A)	314.4	333.9	358.1	383.2	404.8	418.8
	COP	1.311	2.068	3.001	4.182	5.738	7.833
40	Refrigerating capacity (kW)	184.3	327.0	526.7	808.9	1192.4	1705.7
	Power (kW)	204.7	220.4	239.8	259.9	278.1	291.8
	Current(A)	363.4	386.6	415.6	446.3	474.2	495.2
	COP	0.900	1.484	2.197	3.112	4.287	5.846
50	Refrigerating capacity (kW)	147.2	259.7	436.6	684.3	1029.5	1496.7
	Power (kW)	243.7	262.6	285.6	310.2	333.4	352.7
	Current(A)	421.6	450.3	485.8	523.7	559.8	589.8
	COP	0.604	0.989	1.529	2.206	3.087	4.243
60	Refrigerating capacity (kW)	--	--	--	542.6	844.3	1259.3
	Power (kW)	--	--	--	368.6	398.2	424.5
	Current(A)	--	--	--	614.7	661.8	704.6
	COP	--	--	--	1.472	2.120	2.967

RC2-1530B-Z,R22							
Saturated Discharge Temp °C	Saturated Suction Temp °C	-40	-30	-20	-10	0	10
30	Refrigerating capacity (kW)	259.0	441.8	699.7	1057.9	1548.0	2197.1
	Power (kW)	196.5	212.6	232.1	251.7	268.5	279.2
	Current(A)	361.5	384.1	412.2	441.2	466.3	482.5
	COP	1.318	2.078	3.015	4.202	5.766	7.870
40	Refrigerating capacity (kW)	213.8	379.5	611.0	938.2	1383.0	1978.3
	Power (kW)	236.3	254.5	276.8	300.0	321.1	336.8
	Current(A)	418.3	445.3	478.8	514.3	546.6	570.9
	COP	0.905	1.491	2.208	3.127	4.307	5.874
50	Refrigerating capacity (kW)	170.9	301.3	506.7	793.9	1194.1	1736.0
	Power (kW)	281.3	303.1	329.7	358.0	384.9	407.2
	Current(A)	485.7	519.0	560.0	603.7	645.4	680.2
	COP	0.608	0.994	1.537	2.217	3.102	4.263
60	Refrigerating capacity (kW)	--	--	--	629.6	979.5	1460.7
	Power (kW)	--	--	--	425.5	459.7	490.0
	Current(A)	--	--	--	709.0	763.6	813.4
	COP	--	--	--	1.480	2.131	2.981

Remark: The above performance data are in accordance with the latest selection software of Hanbell.
The selection software may be updated without prior notice.

RC2-100BZ ~ 140BZ Drawing

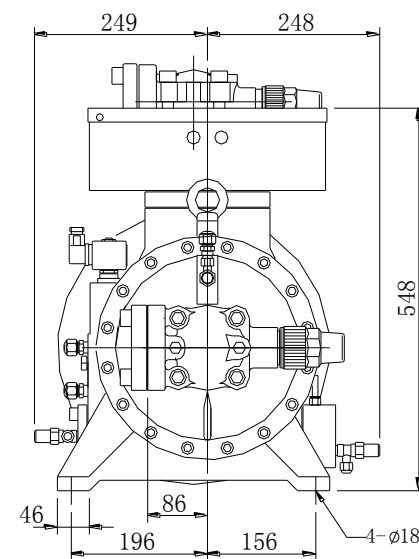
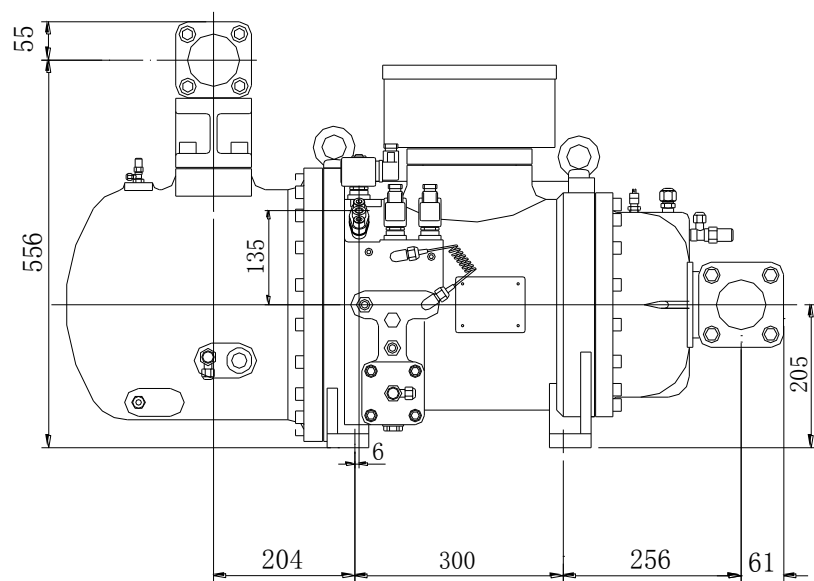
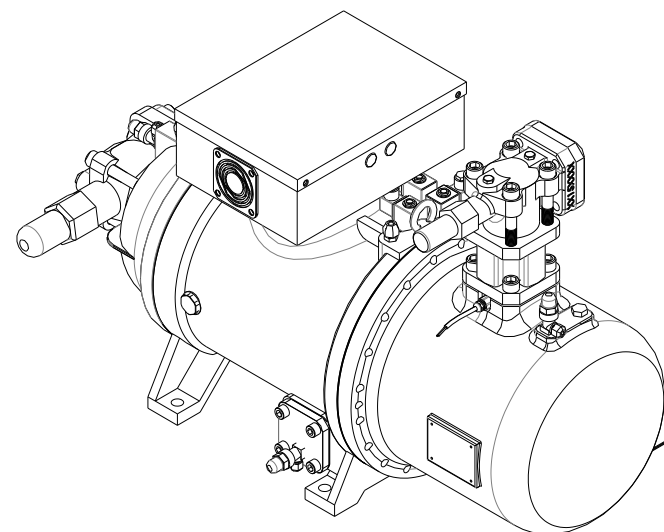
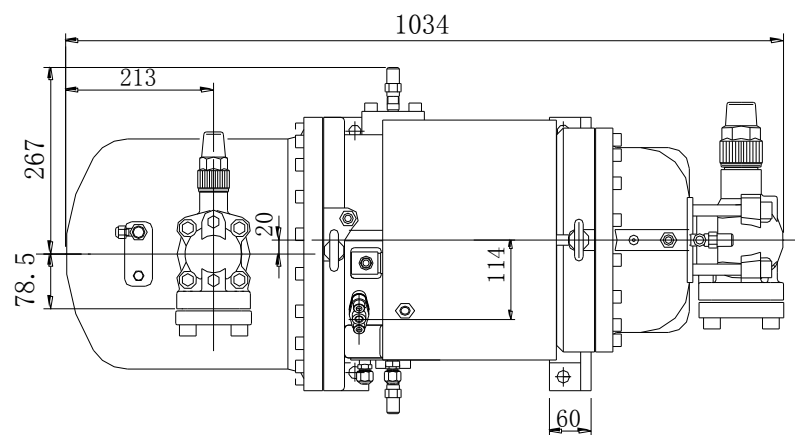

▲Dimension unit: mm

RC2-180BZ Drawing

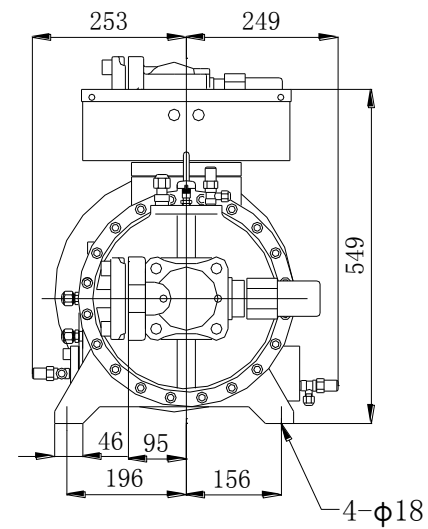
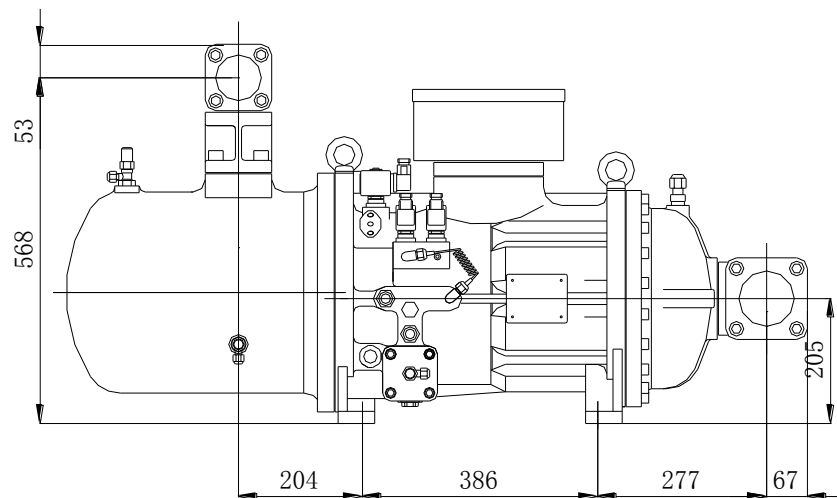
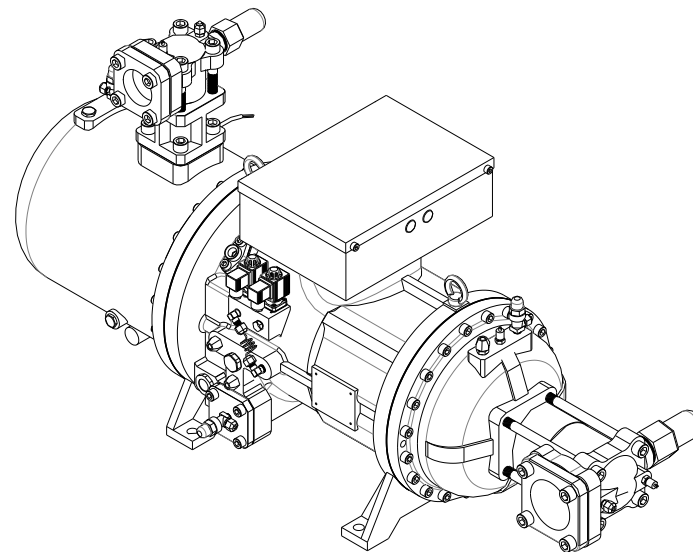
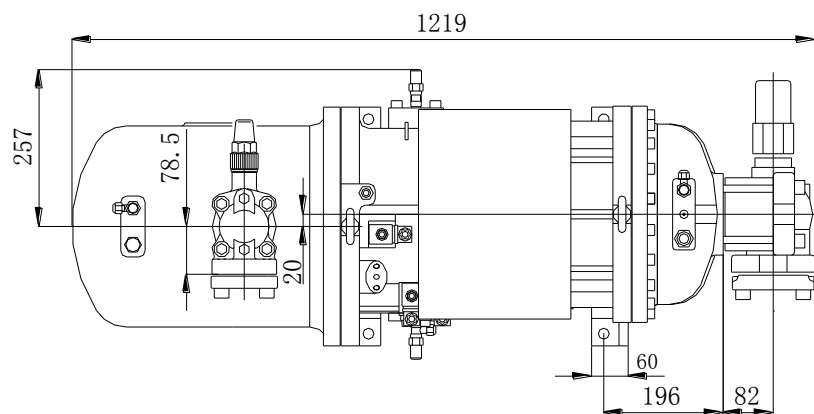

RC2-200BZ~620BZ Drawing (Horizontal suction port for 620)

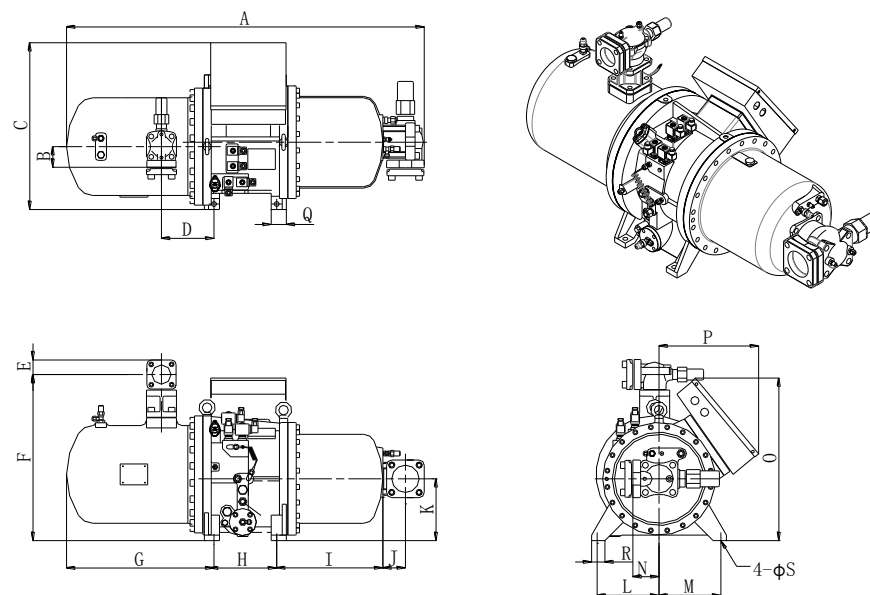

Model	RC2 -200BZ~620BZ Dimension (Horizontal suction port for 620)																		
	A	B	C	D	E	F	G	H	I	J	K	L	M	N	O	P	Q	R	S
RC2 -200B	1300	79	620	191	55	603	536	228	386	82	225	225	225	95	592	386	55	48	18
RC2 -230B&260B	1399	86	682	202	61	674	567	251	399	97	257	240	240	107	622	386	55	48	18
RC2 -300B	1521	86	682	202	61	674	610	285	444	97	257	240	240	107	622	386	55	48	18
RC2 -310B	1484	86	682	202	61	674	610	251	444	97	257	240	240	107	622	386	55	48	18
RC2 -340B&370B	1595	96	682	202	67	704	610	285	492	103	257	240	240	132	622	386	55	48	18
RC2 -410B	1540	96	755	221	67	755	613	288	433	103	276	270	230	132	652	408	70	100	22
RC2 -470B	1666	96	755	221	67	755	661	320	478	103	276	270	230	132	652	408	70	100	22
RC2 -510B	1675	107	798	231	76	789	696	288	484	103	276	270	230	132	638	450	70	100	22
RC2 -550B	1783	107	798	236	76	800	720	320	536	103	280	270	230	132	642	450	70	100	22
RC2 -580B	1707	107	798	231	76	789	696	320	484	103	276	270	230	132	638	450	70	100	22
RC2 -620B	1904	107	798	236	76	800	720	320	525	220	280	270	230	161	642	450	70	100	22

▲Dimension unit: mm

RC2 -620BZ~930BZ Drawing (Vertical suction port for 620)

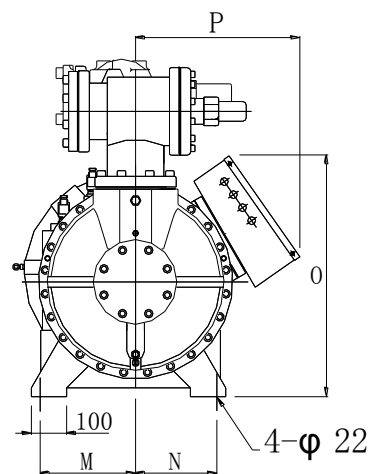
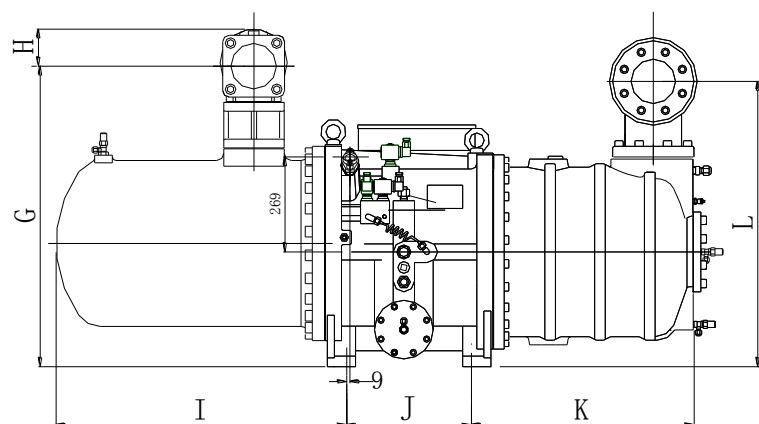
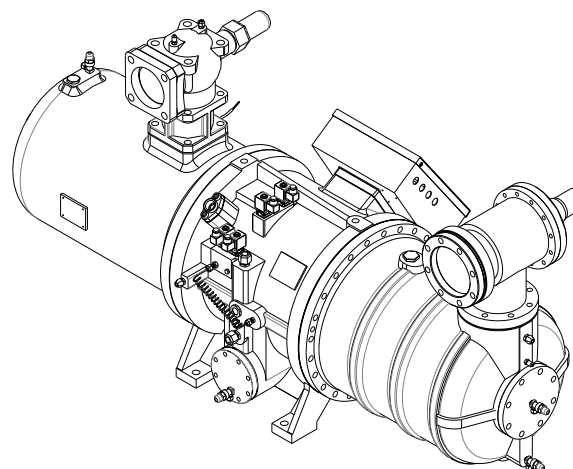
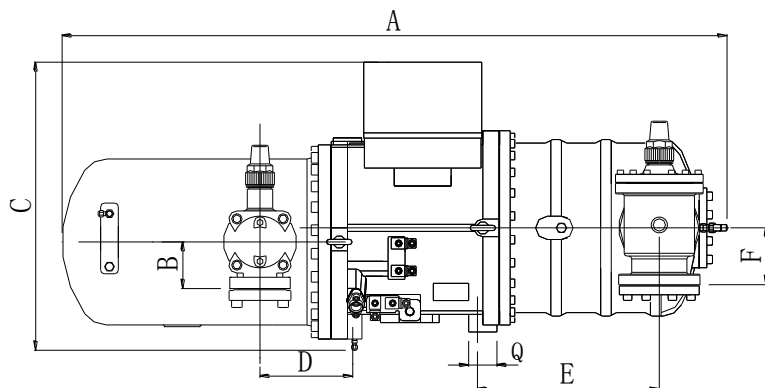

Model	RC2 -620BZ~930BZ Dimension (Vertical suction port for 620)																
	A	B	C	D	E	F	G	H	I	J	K	L	M	N	O	P	Q
RC2 -620B	1743	107	800	236	510	161	800	76	720	320	623	738	270	230	642	450	70
RC2 -710B	1954	130	812	263	585	161	851	105	822	353	698	808	270	230	682	465	80
RC2 -790B&830B	2039	130	812	263	585	161	851	105	822	418	698	808	270	230	682	465	80
RC2 -930B	2073	160	812	263	639	161	851	105	822	418	752	808	270	230	682	465	80

▲Dimension unit: mm

RC2 -1020BZ~1130BZ Drawing

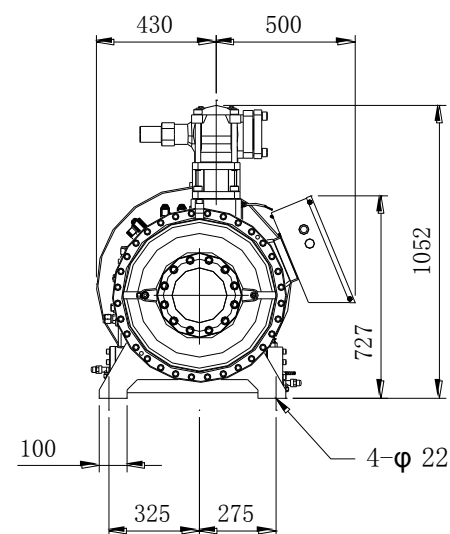
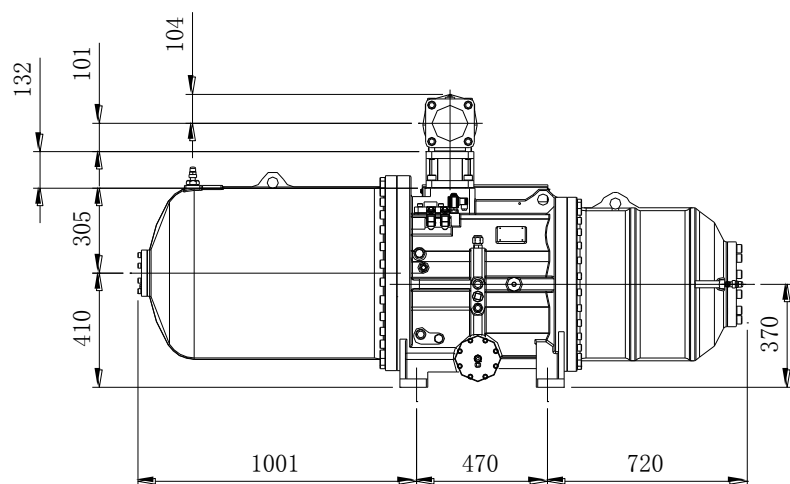
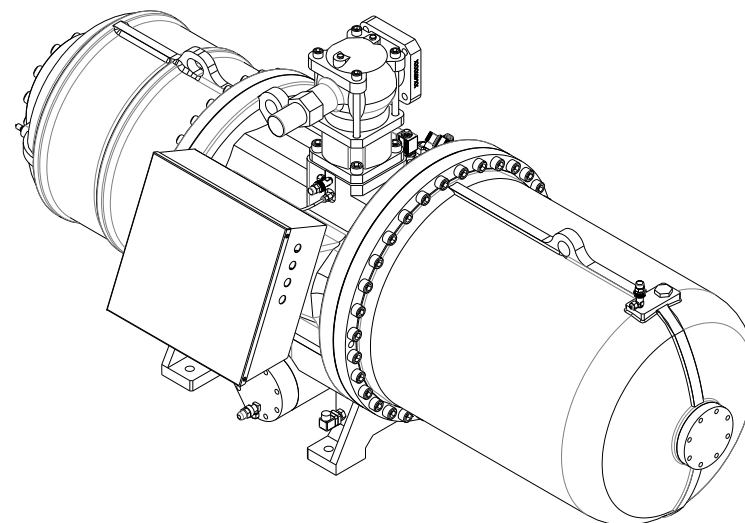
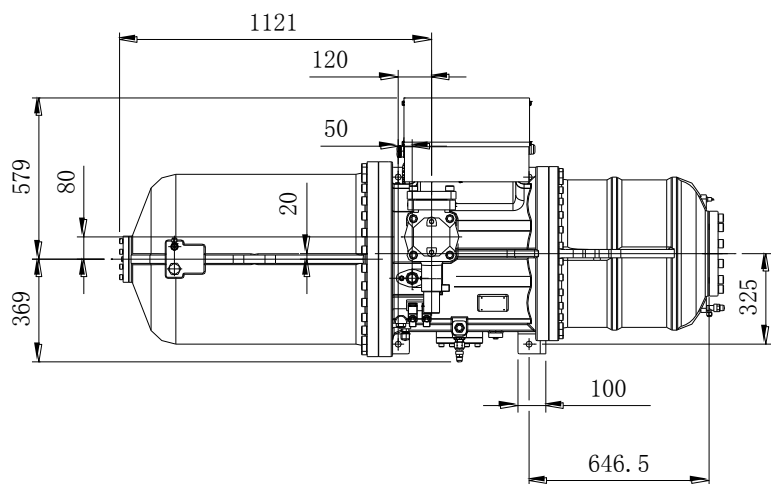

RC2 -1270BZ~1530BZ Drawing

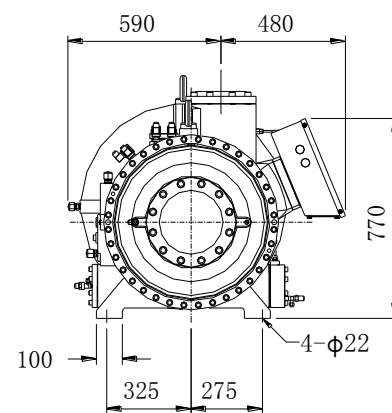
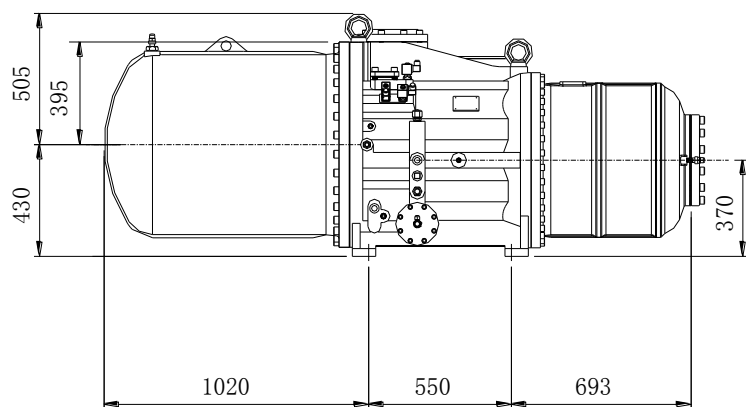
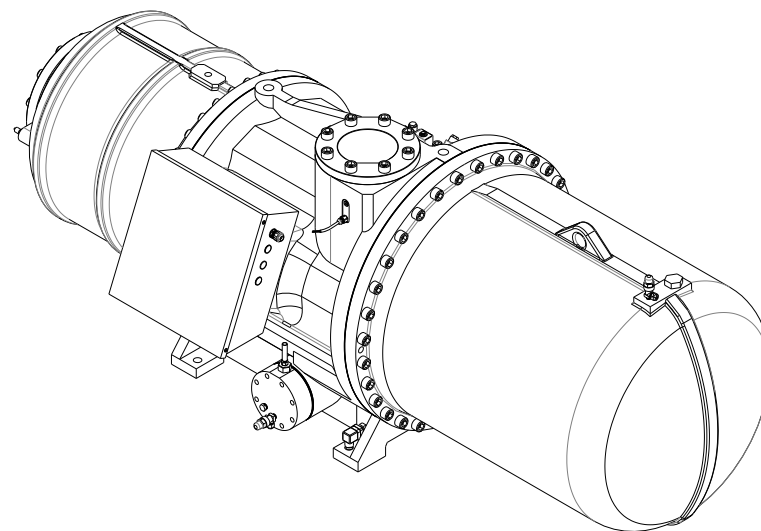
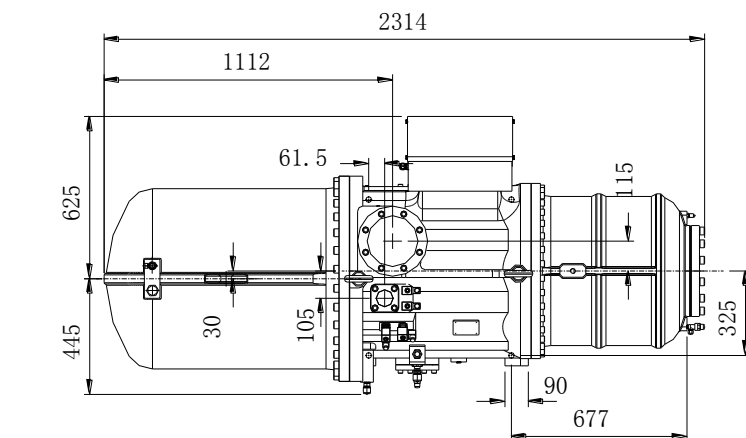

RC2-100BZ&140BZ Drawing

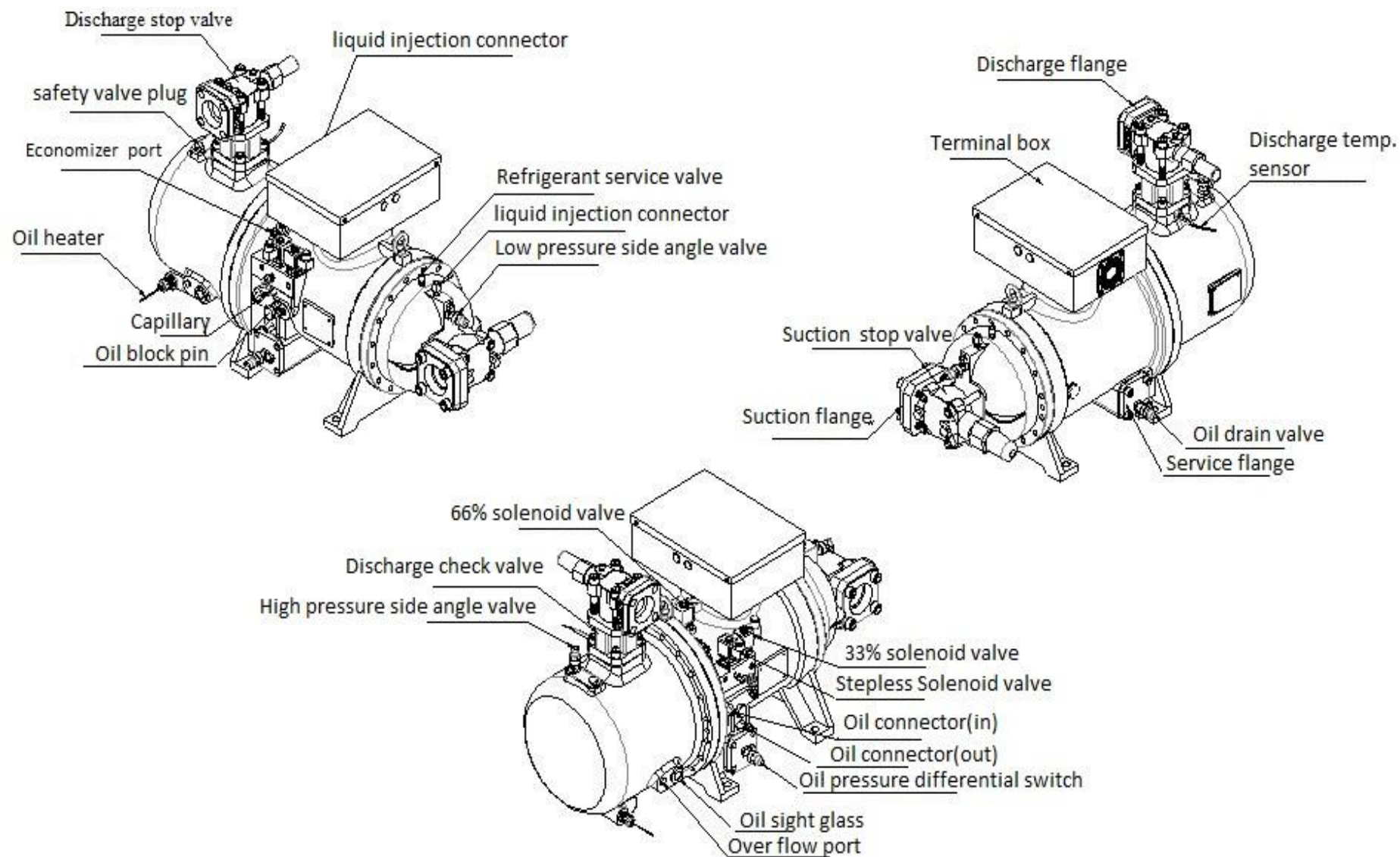

RC-180BZ Drawing

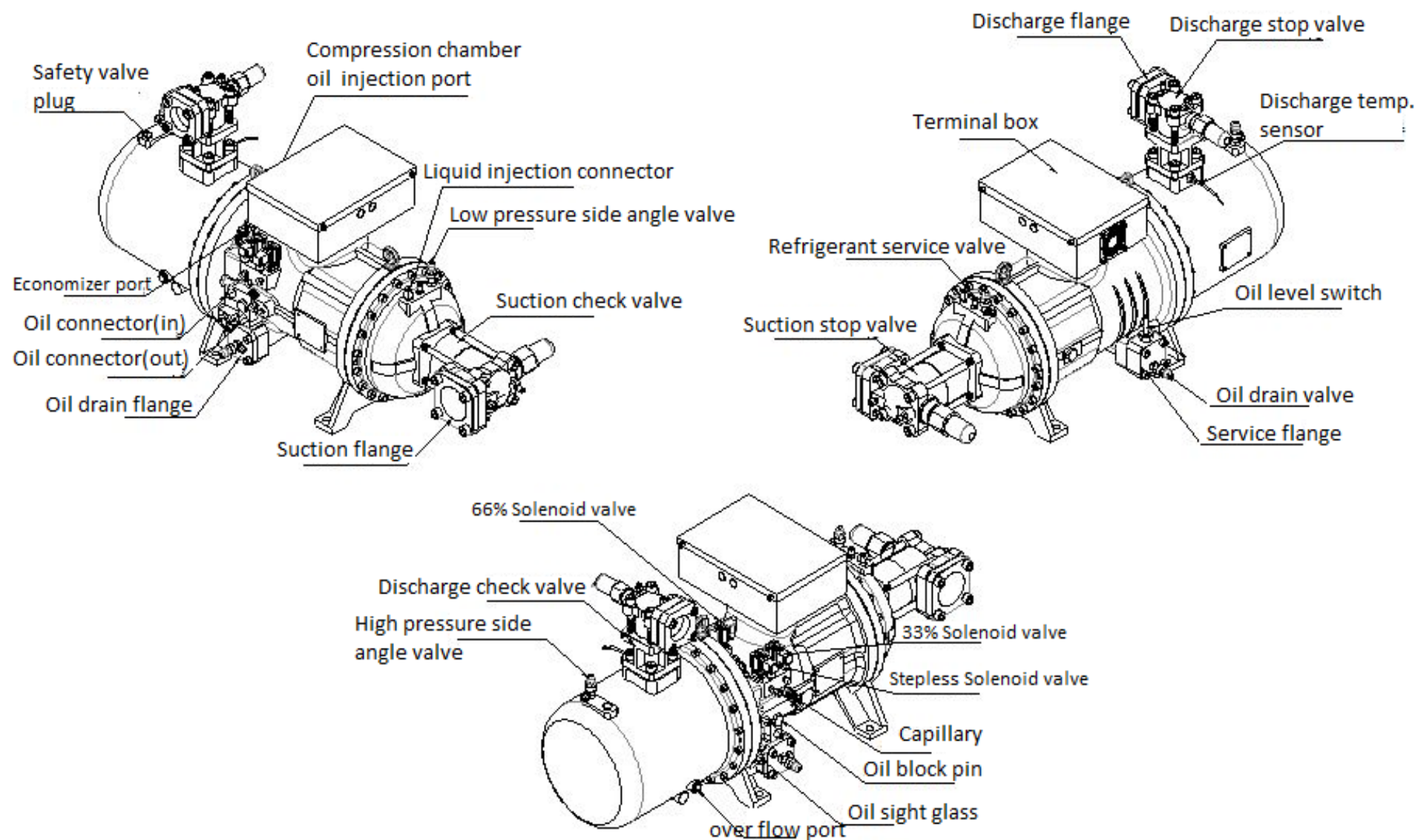

RC2-200BZ~620BZ Drawing(Horizontal suction port for 620)

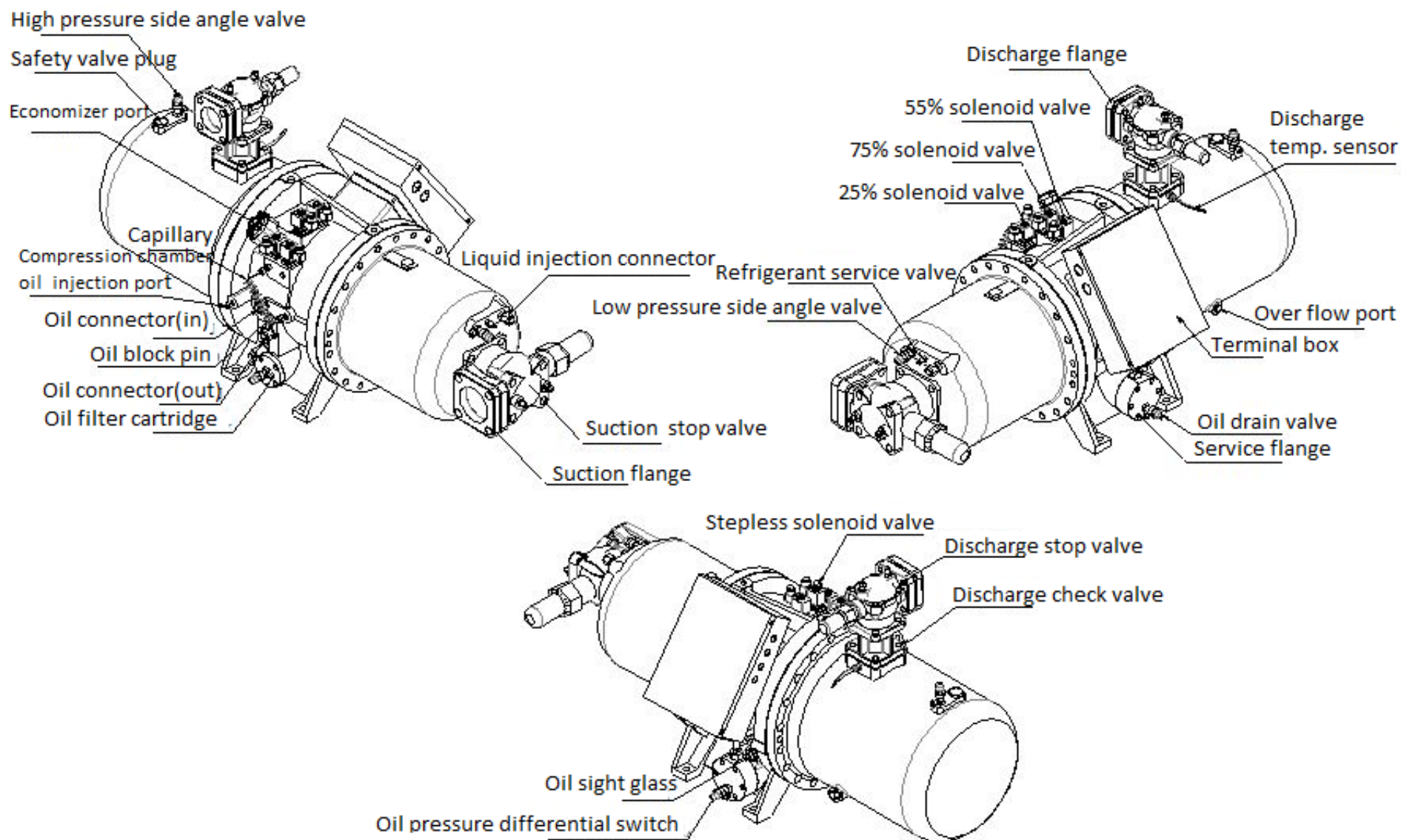

RC2-620BZ~930BZ Drawing(Vertical suction port for 620)

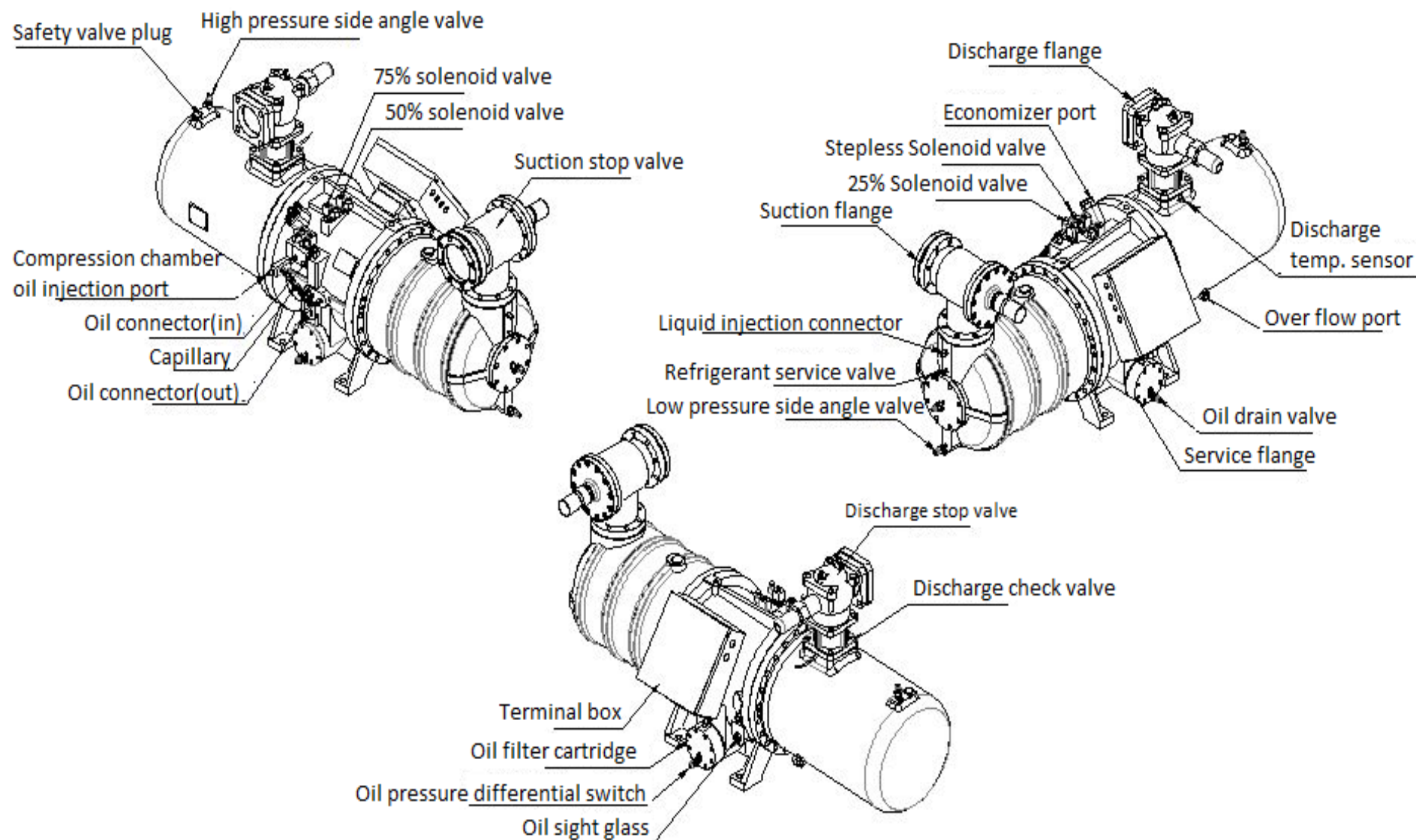

RC2-1020BZ&1130BZ Drawing

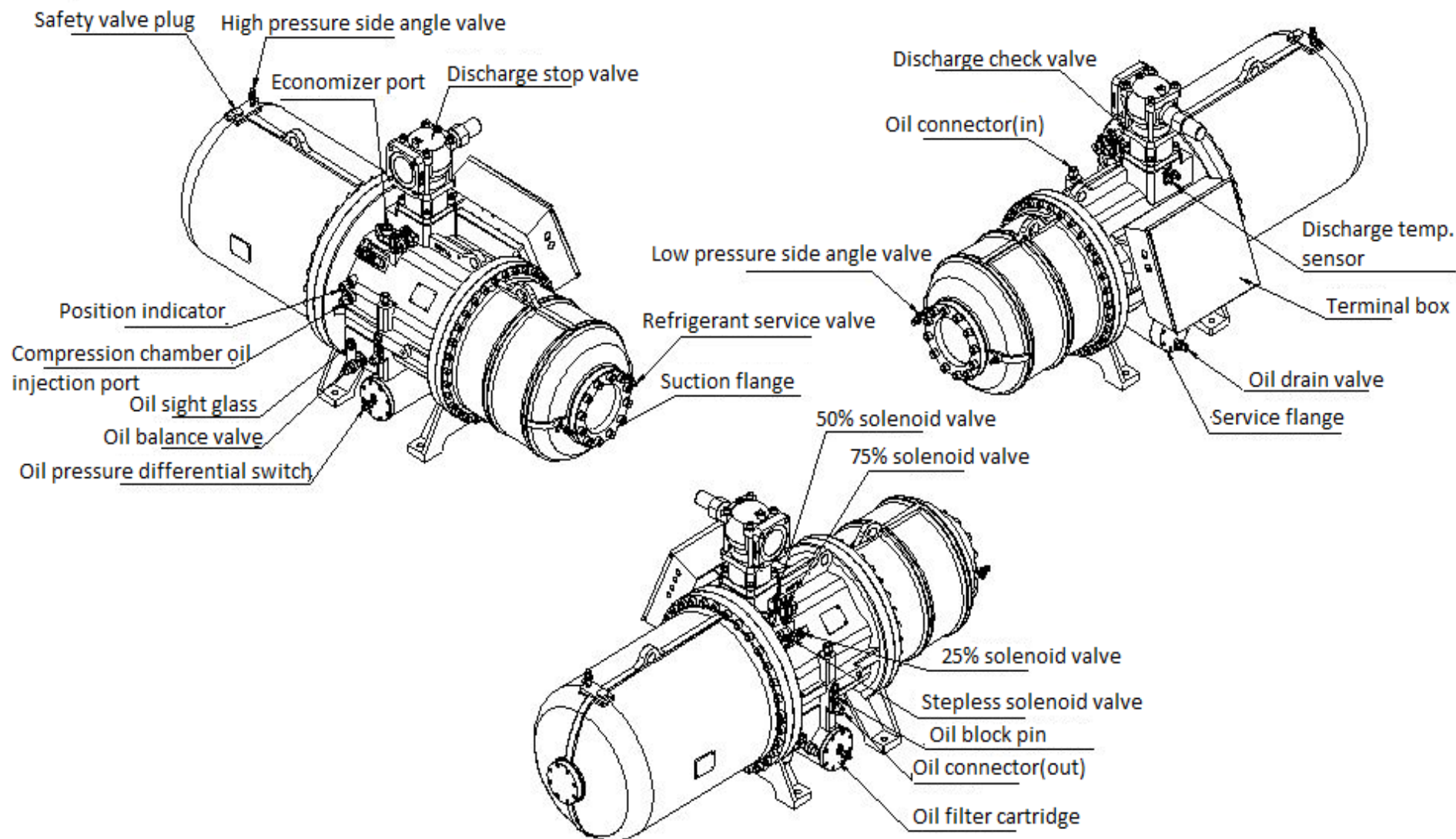

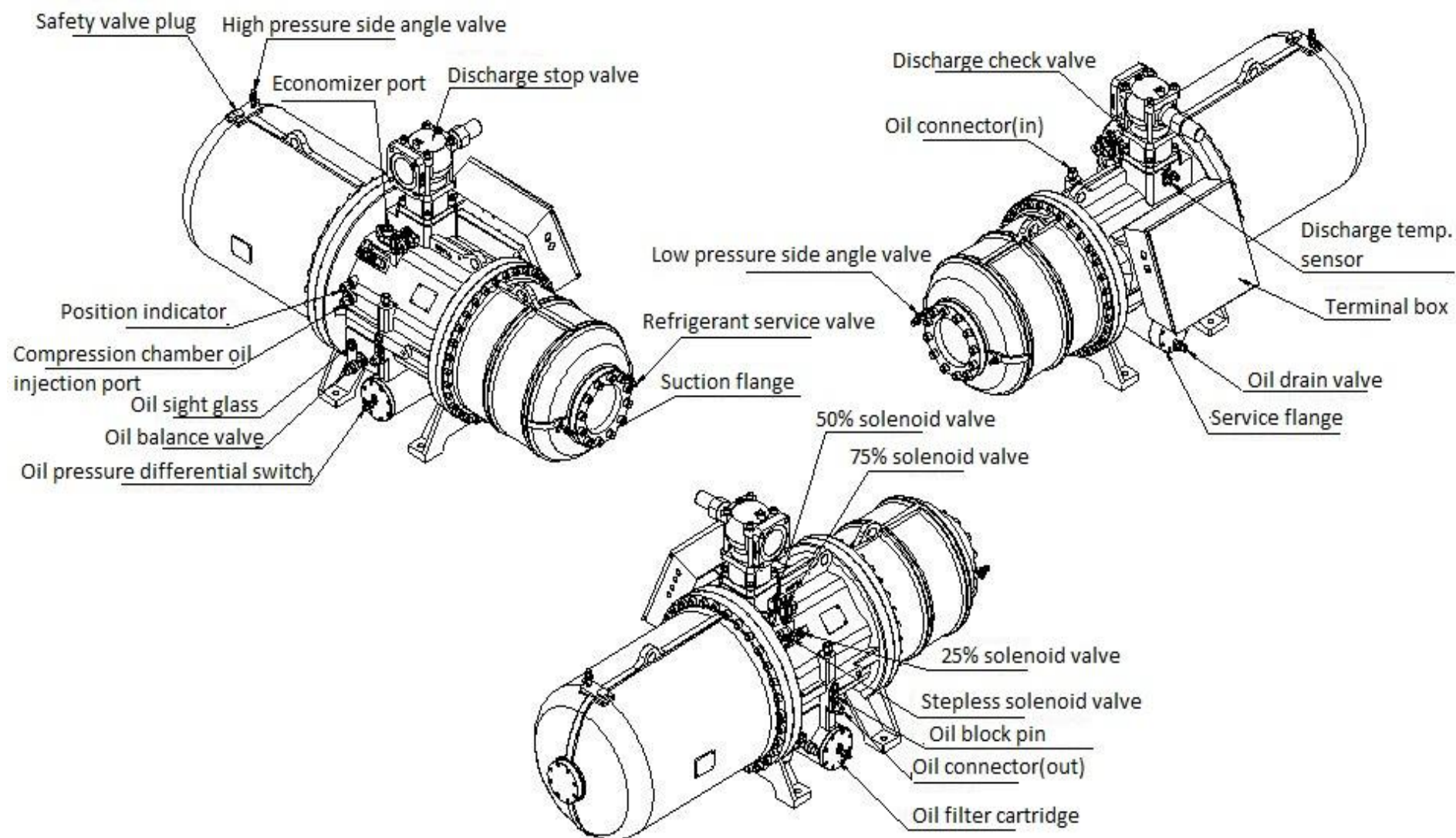
RC2-1270BZ&1530BZ Drawing

RC2-100BPZ~140BPZ Drawing

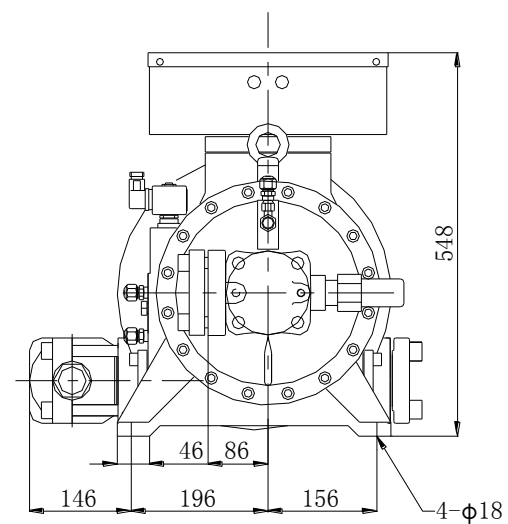
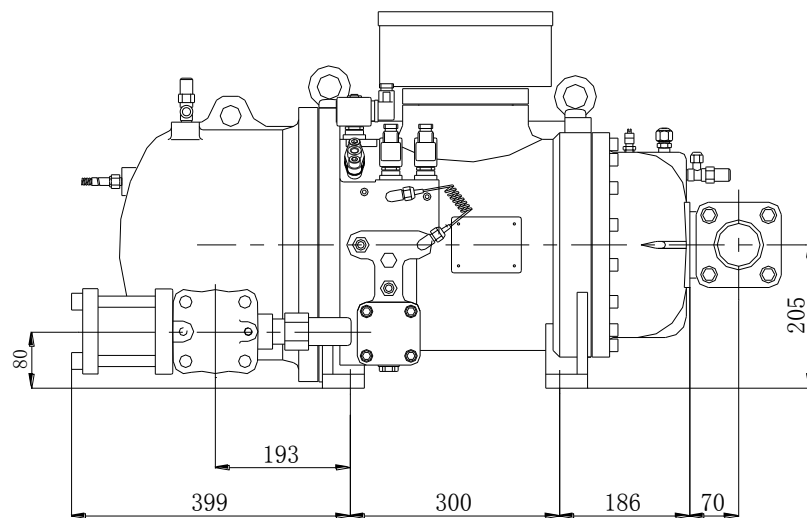
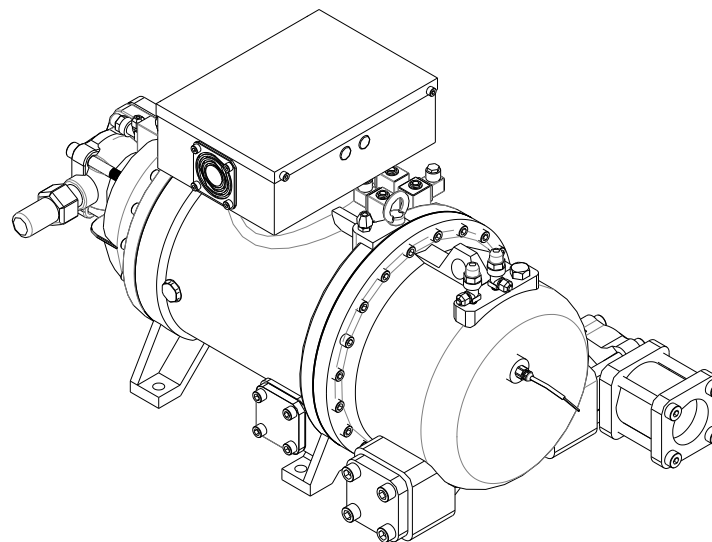
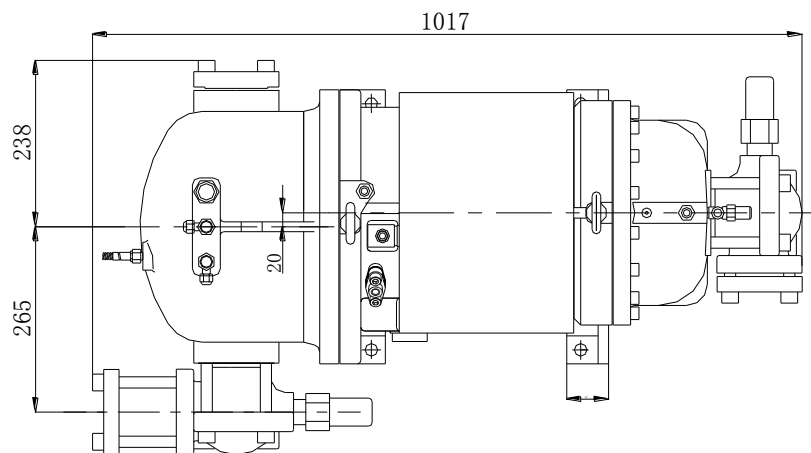

RC2-180BPZ Drawing

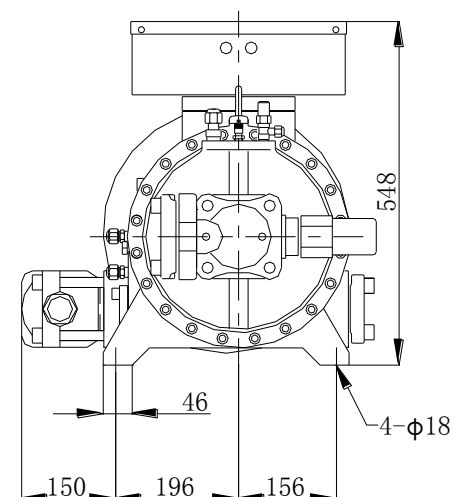
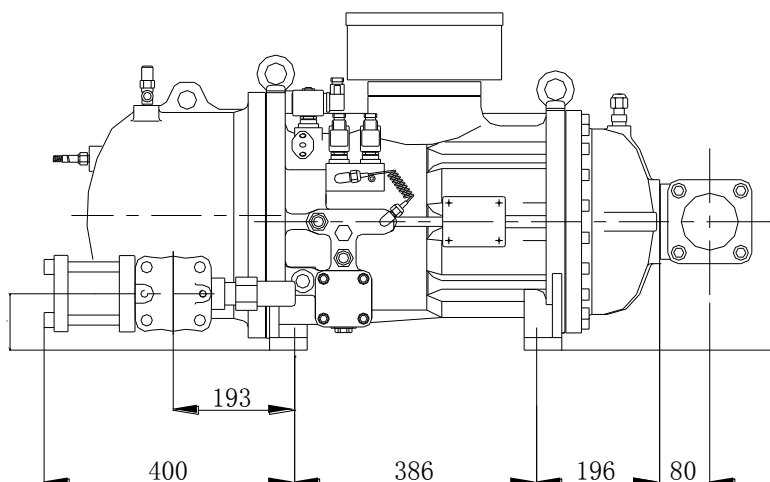
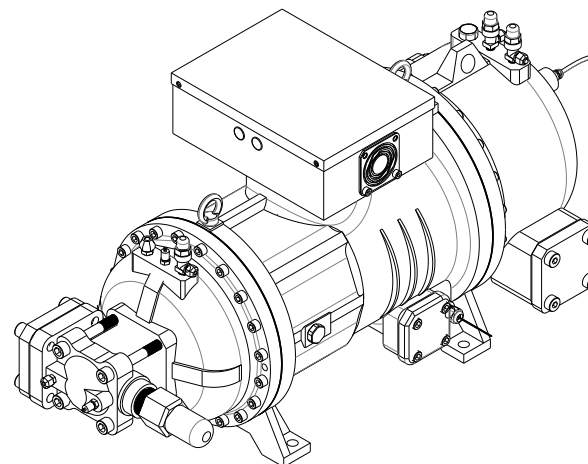
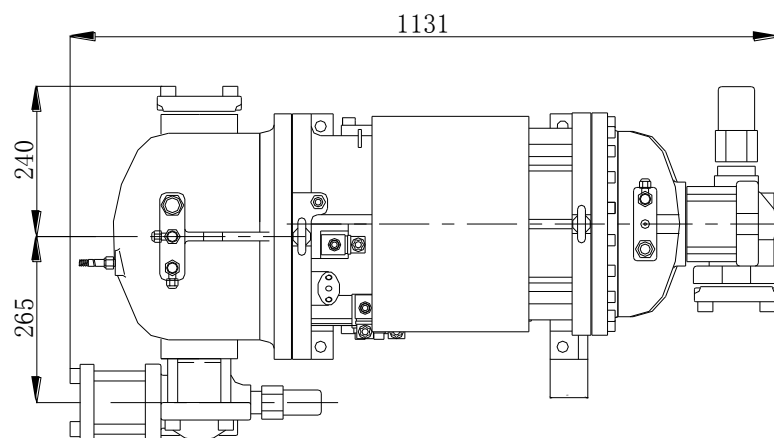

RC2-200BPZ~620BPZ Drawing (Horizontal suction port for 620)

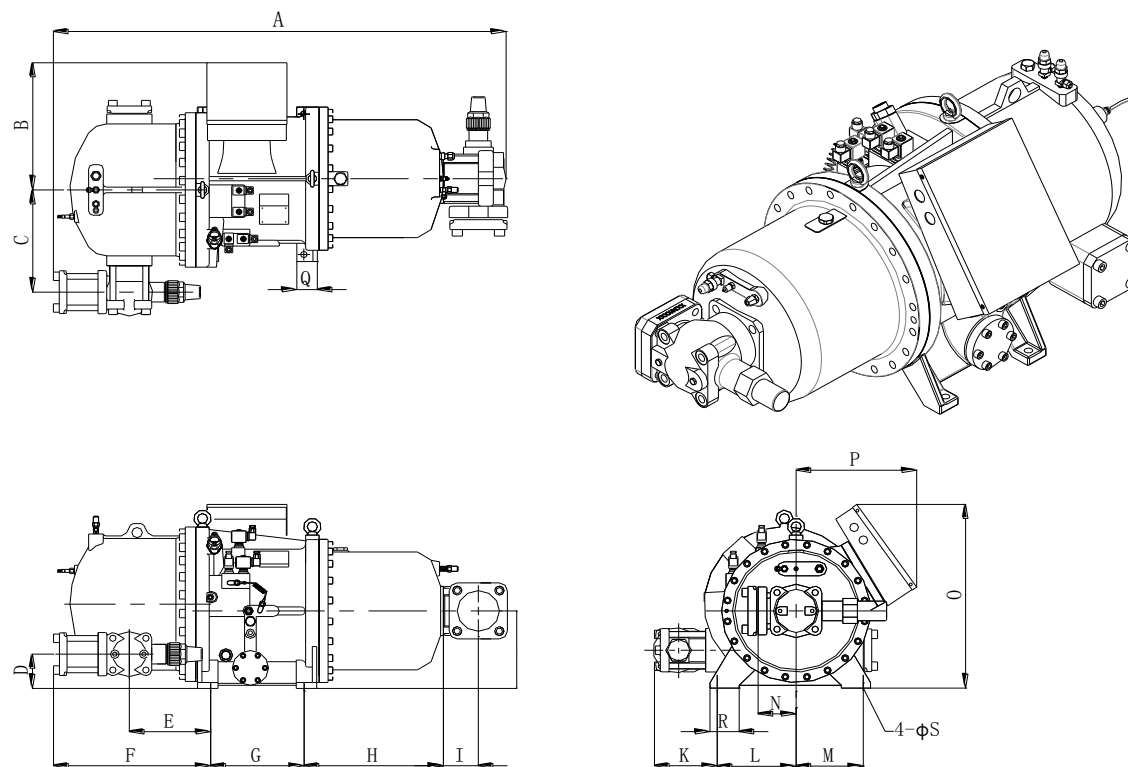

Model	RC2 -200BPZ ~620BPZ dimension of horizontal discharge(Horizontal suction port for 620)																		
	A	B	C	D	E	F	G	H	I	J	K	L	M	N	O	P	Q	R	S
RC2 -200BPZ	1188	375	283	103	218	408	228	386	82	225	135	225	225	96	592	362	51	48	18
RC2-230/260BPZ	1300	400	326	118	241	452	251	399	97	257	169	240	240	107	622	386	55	48	18
RC2 -300BPZ	1379	400	326	118	241	452	285	444	97	257	169	240	240	107	622	386	55	48	18
RC2 -310BPZ	1352	400	326	118	241	452	251	444	97	257	169	240	240	107	622	386	55	48	18
RC2 -340/370BPZ	1452	400	326	118	241	452	285	492	103	257	169	240	240	132	622	386	55	48	18
RC2 -410BPZ	1463	448	365	122	277	517	288	433	103	275	220	270	230	132	652	408	70	100	22
RC2 -470BPZ	1541	448	365	122	277	517	320	478	103	275	220	270	230	132	652	408	70	100	22
RC2 -510BPZ	1515	490	365	122	277	517	288	484	103	275	220	270	230	132	638	450	70	100	22
RC2 -550BPZ	1593	490	365	126	272	512	320	536	103	280	220	270	230	132	642	450	70	100	22
RC2 -580BPZ	1534	490	365	122	277	517	320	484	103	275	220	270	230	132	638	450	70	100	22
RC2 -620BPZ	1819	490	379	140	331	615	320	525	220	280	251	270	230	161	642	450	70	100	22

RC2 -620BPZ~930BPZ Drawing (Vertical suction port for 620)

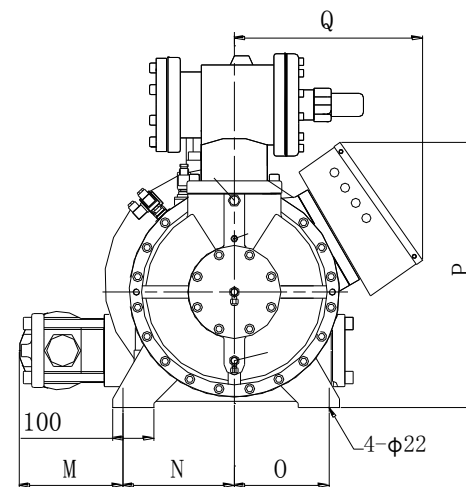
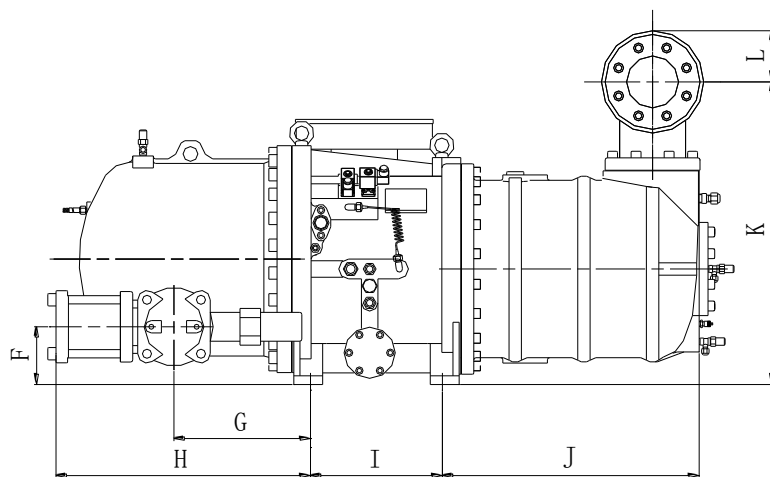
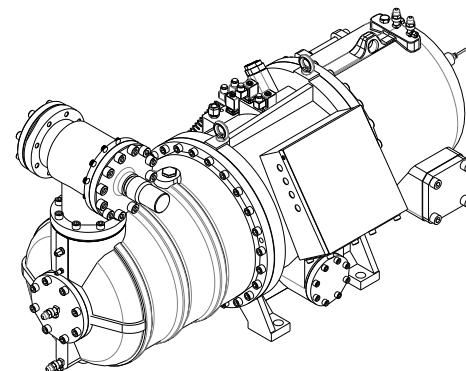
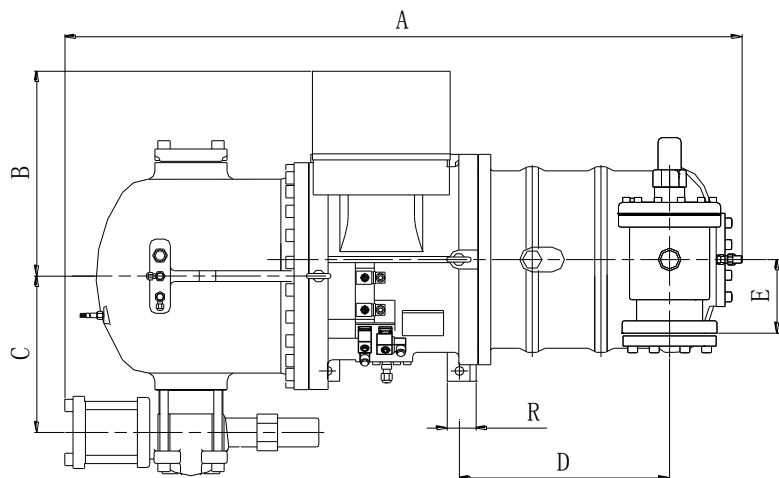

型号	RC2 -620 BPZ~930 BPZ External dimension of horizontal oil separator(vertical suction port)																	
	A	B	C	D	E	F	G	H	I	J	K	L	M	N	O	P	Q	R
RC2 -620BPZ	1657	490	379	510	161	140	331	615	320	623	738	124	251	270	230	642	450	70
RC2 -710BPZ	1763	505	379	585	161	185	346	630	353	698	808	124	250	270	230	682	465	80
RC2 -790/830BPZ	1875	509	379	585	161	185	346	630	418	698	808	124	250	270	230	682	465	80
RC2 -930BPZ	1906	509	379	639	161	185	346	630	418	752	808	124	250	270	230	682	465	80

RC2 -1020BPZ~1130BPZ Drawing

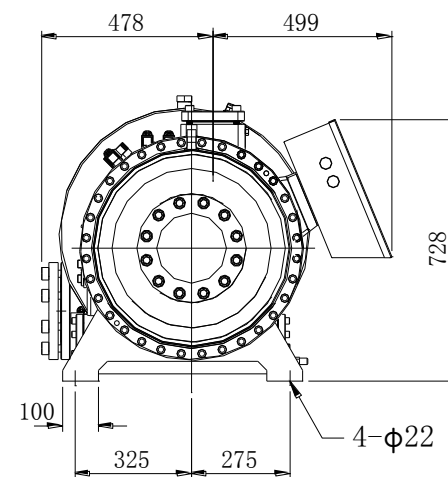
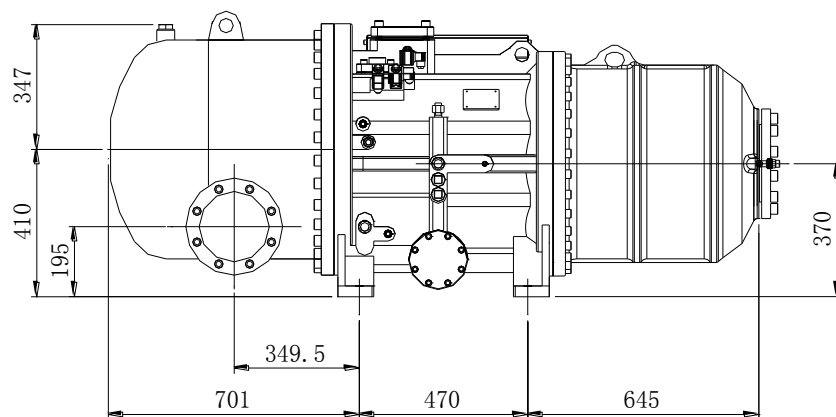
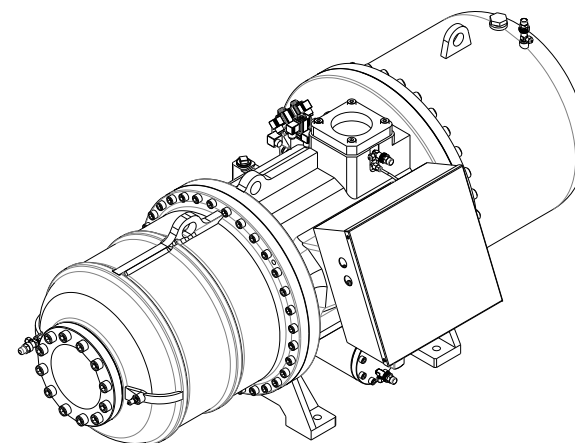
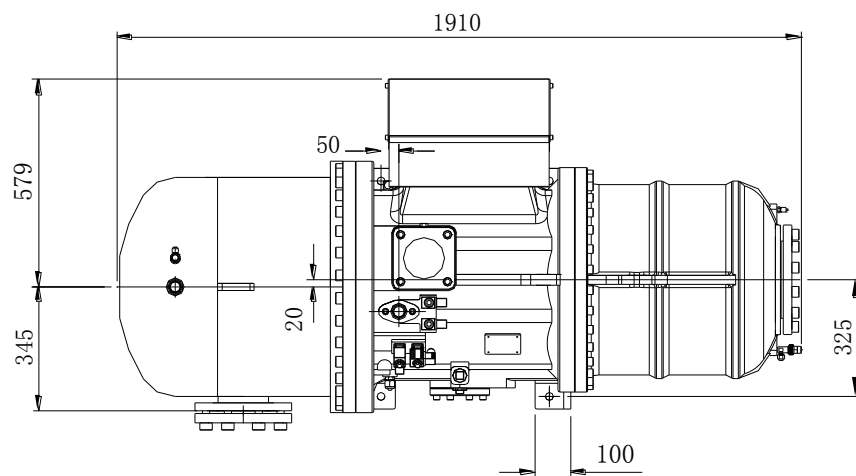

RC2 -1270BPZ~1530BPZ Drawing

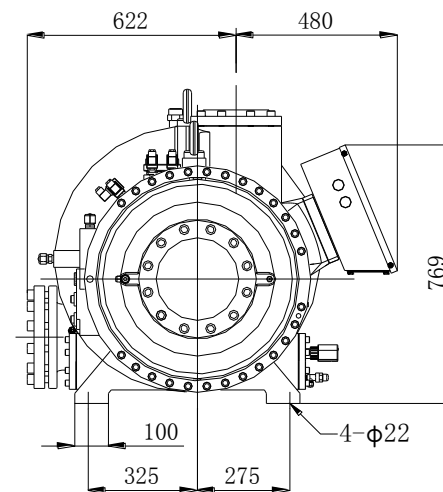
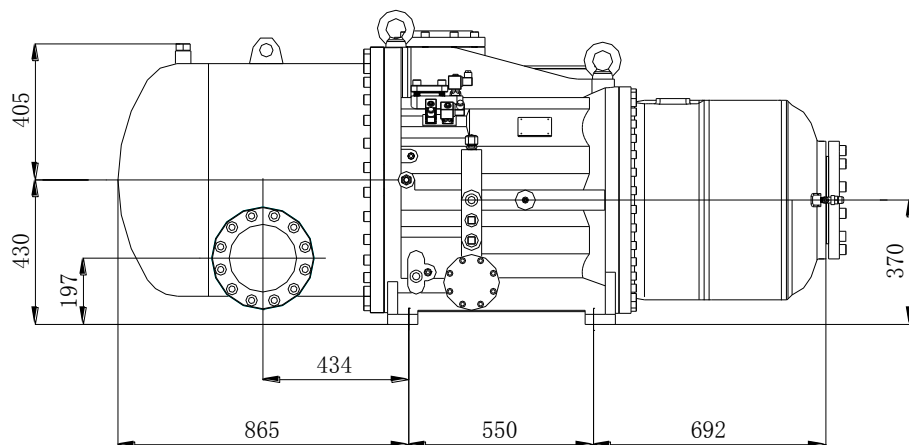
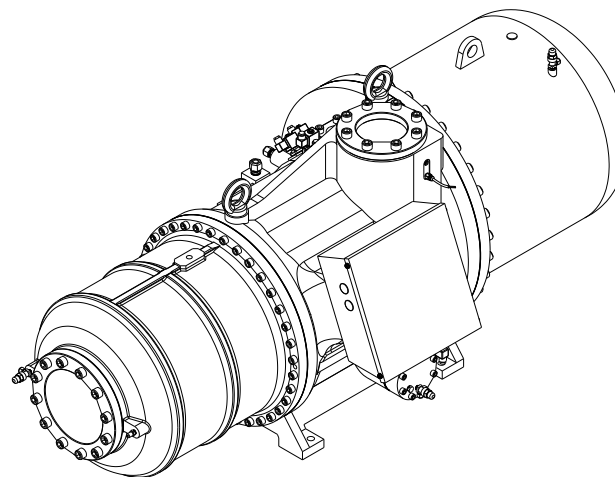
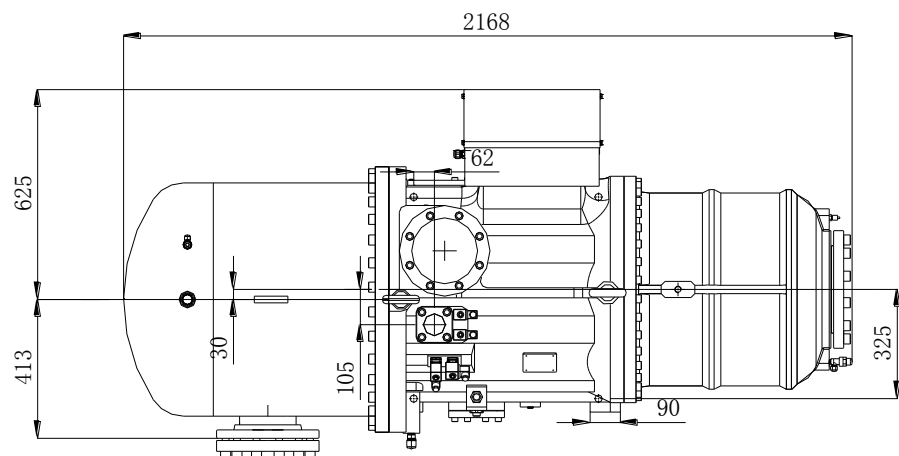

RC2-100BPZ&140BPZ Drawing

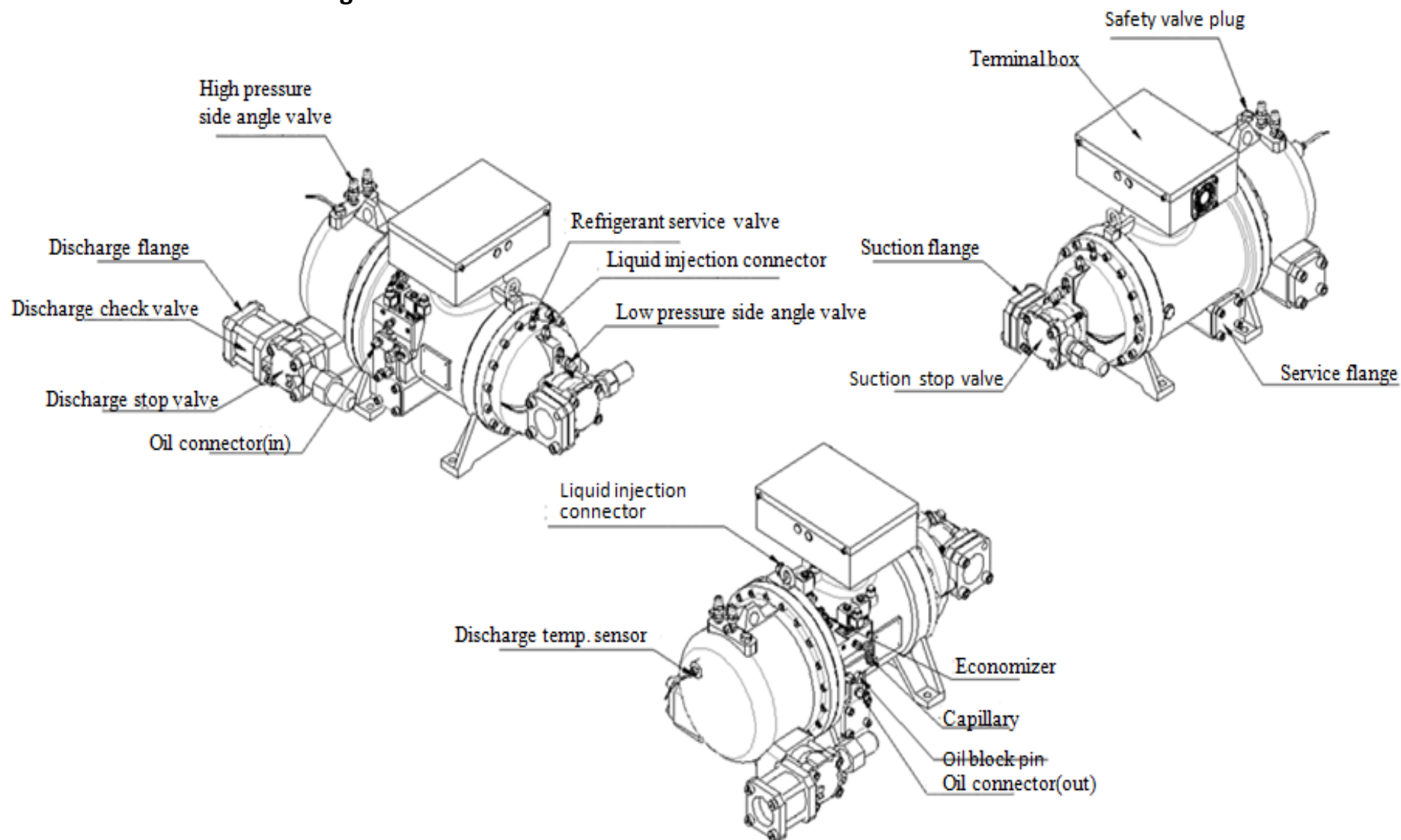

RC2-180BPZ Drawing

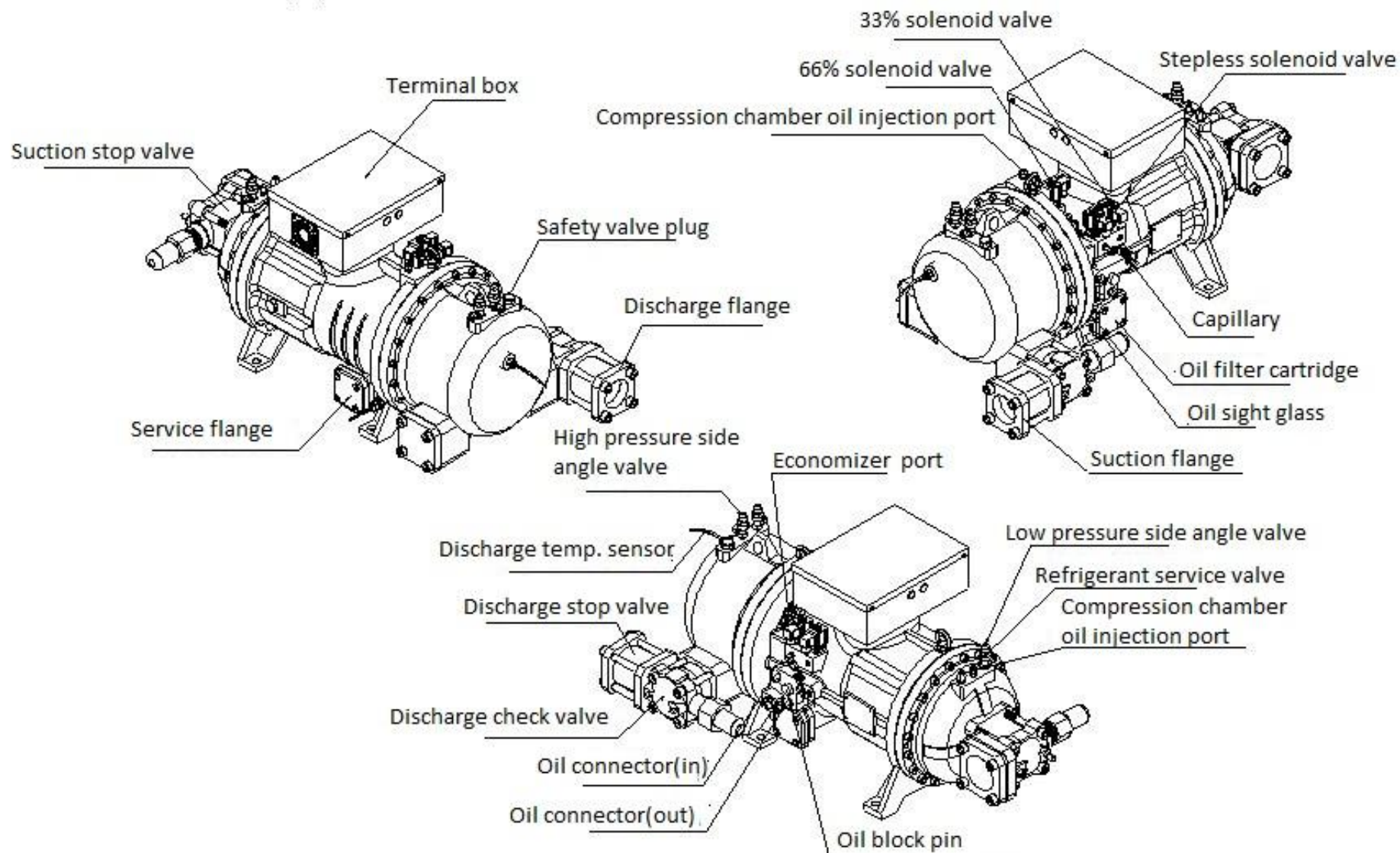

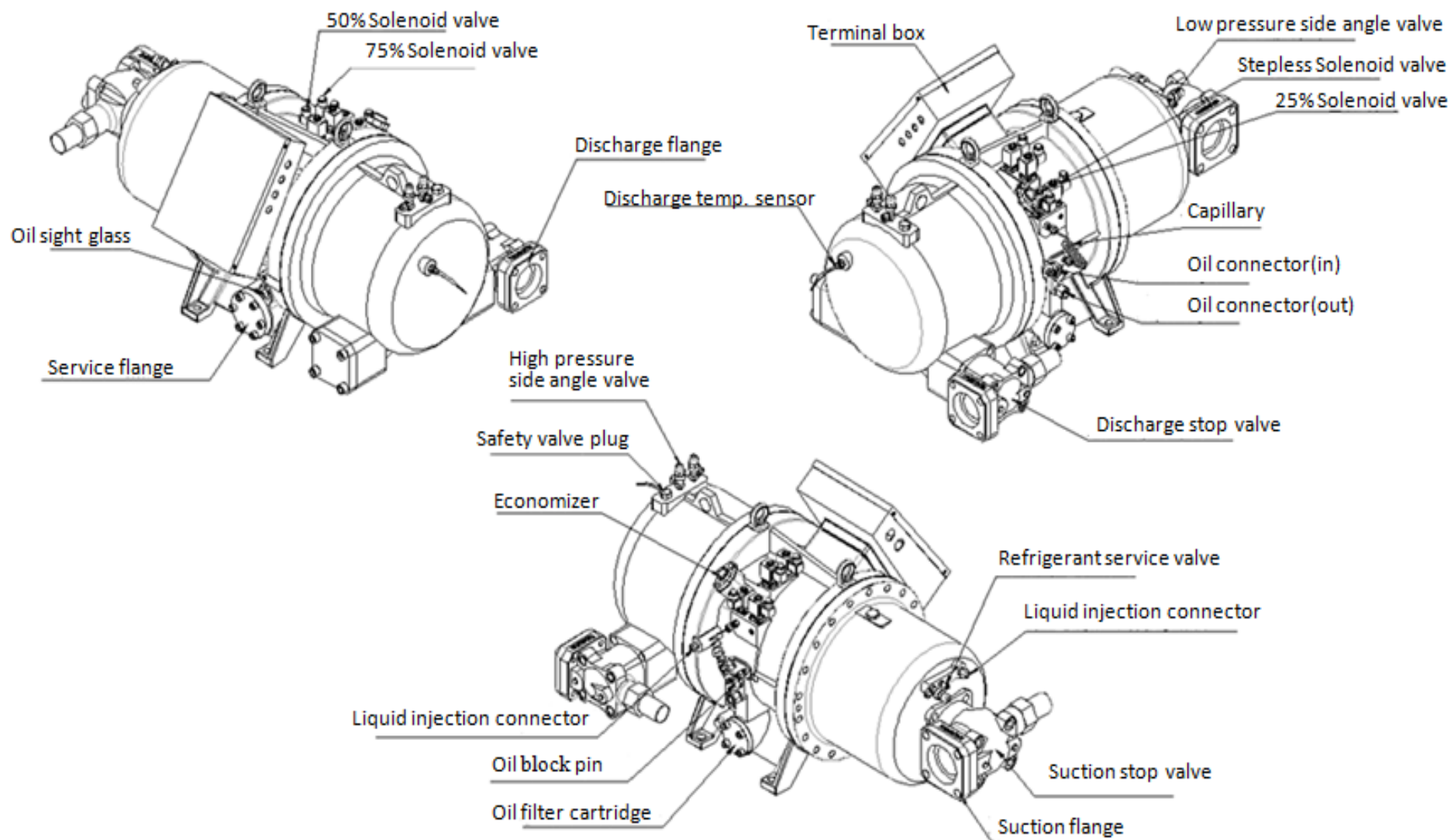
RC2-200BPZ ~620BPZ Drawing (Horizontal suction port for 620)

RC2-620BPZ ~930BPZ Drawing (Vertical suction port for 620)

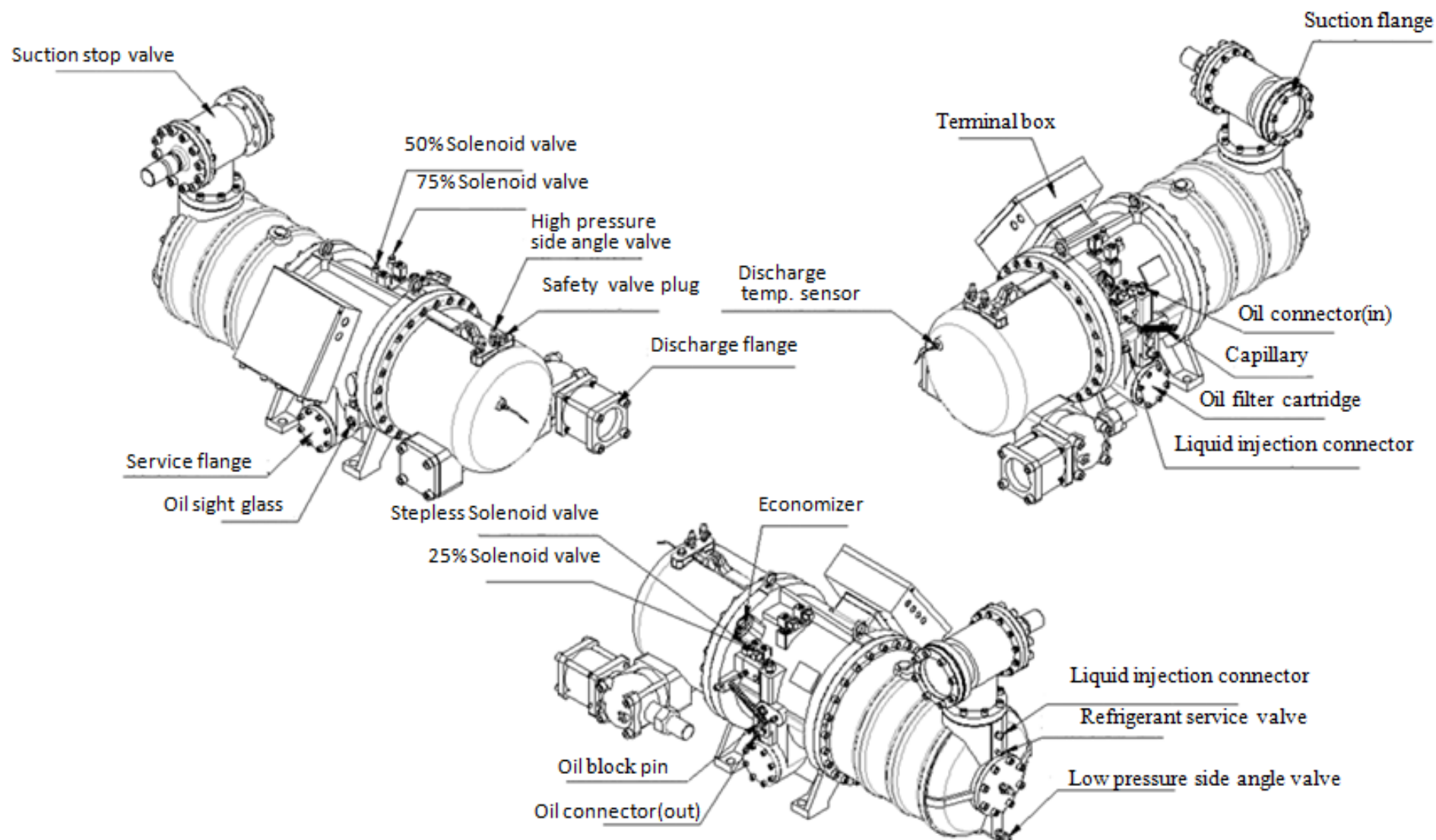

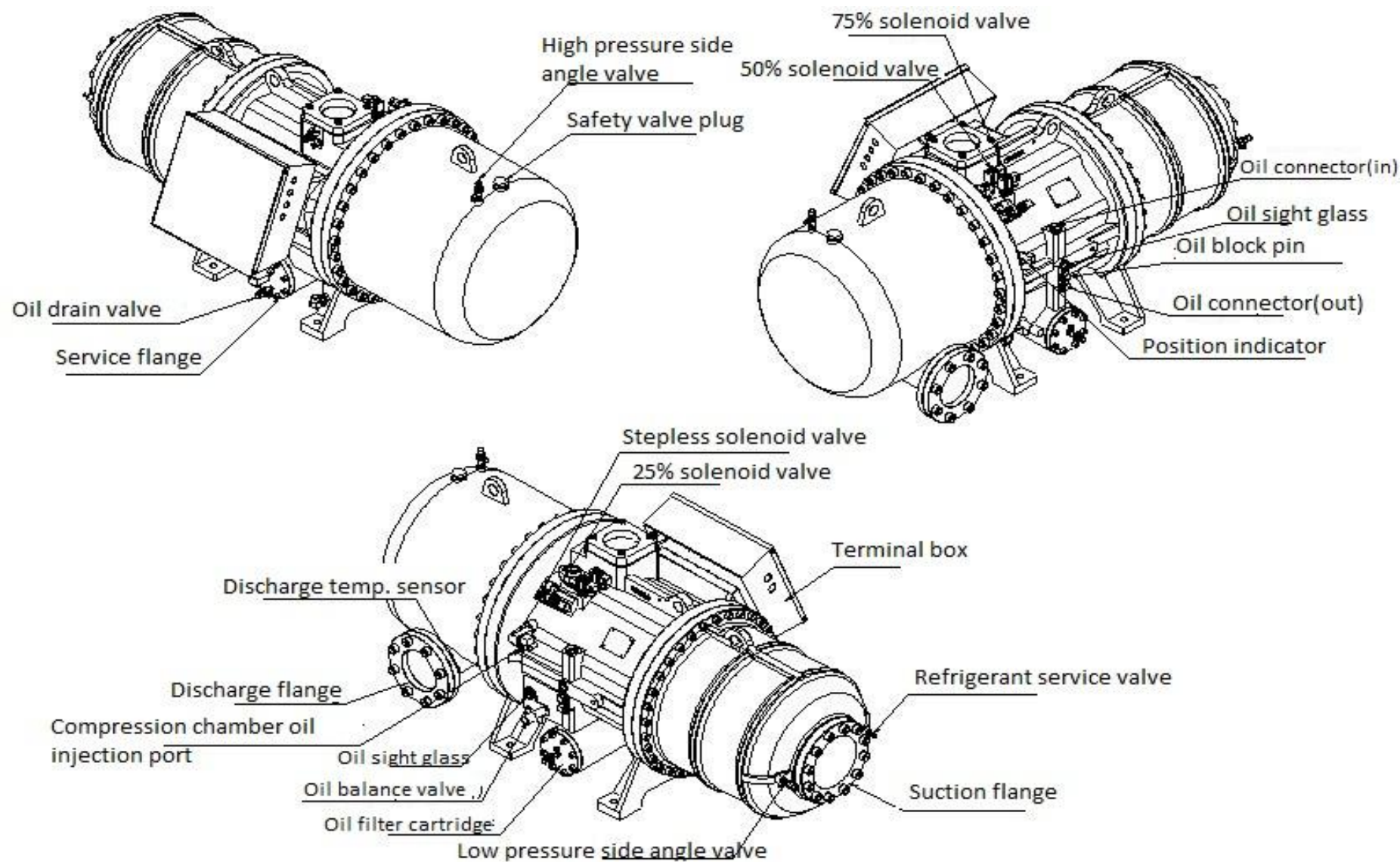
RC2-1020BPZ &1130BPZ Drawing

RC2-1270BPZ &1530BPZ Drawing

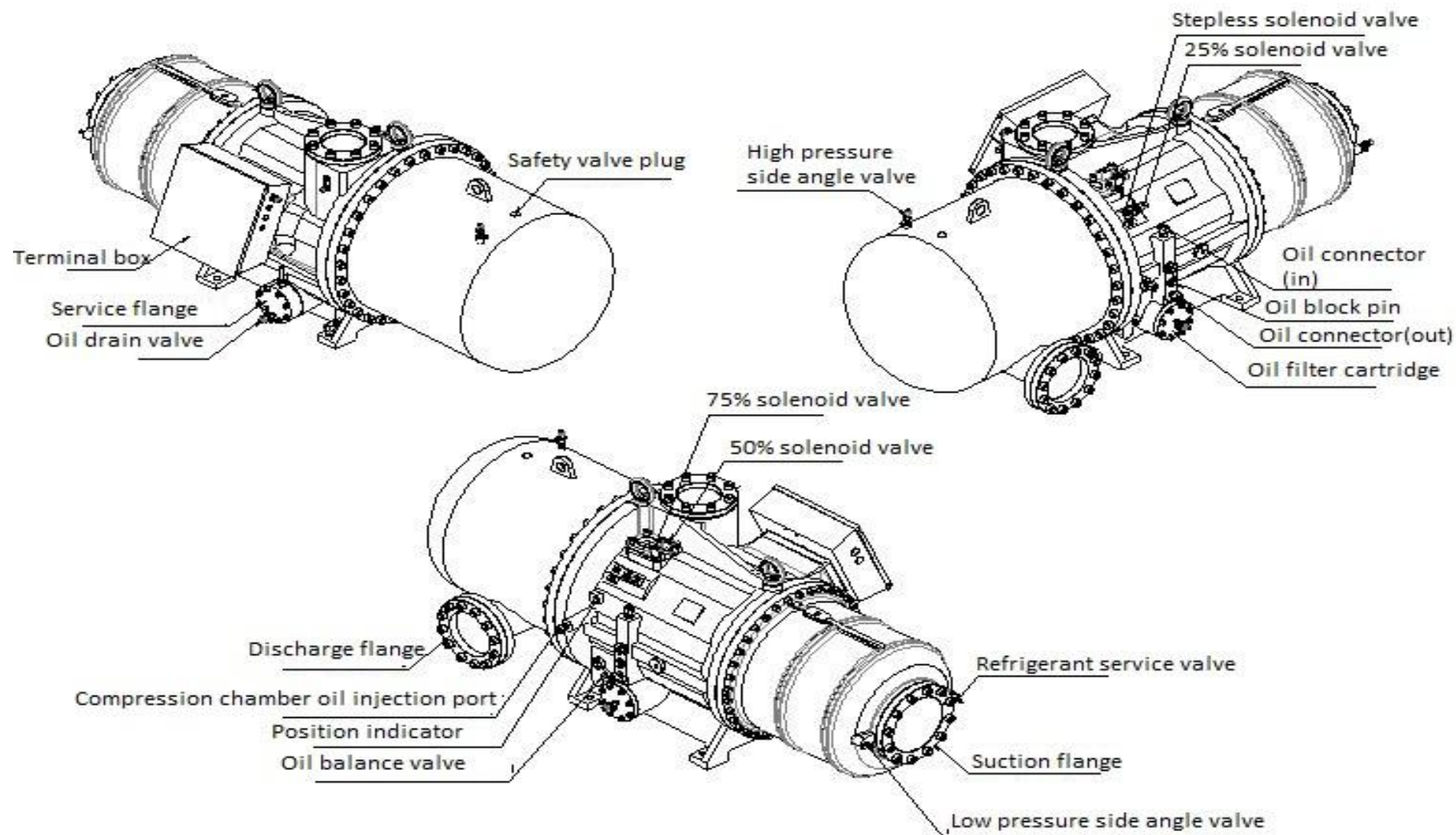

Specification of RC2 -100BZ~1530BZ (standard oil separator) connector

Mode	Discharge flange	Cooper pipe	Steel pipe	Suction flange	Cooper pipe	Steel pipe	Economizer	Main return port	Oil injection port	Liquid injection connector		
RC2 -100	1-1/2"	Φ42	Φ49.3	2"	Φ55	Φ61.3	5/8" Flare （16.1）	3/8"Flare （9.7）	3/8"Flare （9.7）	3/8"Flare （9.7）		
RC2 -140	1-1/2"			2"			5/8" Flare （16.1）	3/8"Flare （9.7）	3/8"Flare （9.7）	3/8"Flare （9.7）		
RC2 -180	1-1/2"			Φ68	Φ77.2	2-1/2"	5/8" Flare （16.1）	3/8"Flare （9.7）	3/8"Flare （9.7）	5/8"Flare （16）		
RC2 -200	1-1/2"					2-1/2"	5/8" Flare （16.1）	5/8"Flare （16）	3/8"Flare （9.7）	5/8"Flare （16）		
RC2 -230	2"	Φ55	Φ61.3	3"	Φ80.5	Φ90.2	5/8" Flare （16.1）	5/8"Flare （16）	3/8"Flare （9.7）	5/8"Flare （16）		
RC2 -260	2"			3"			5/8" Flare （16.1）	5/8"Flare （16）	3/8"Flare （9.7）	5/8"Flare （16）		
RC2 -300	2"			3"			7/8" Flare （22.4）	5/8"Flare （16）	3/8"Flare （9.7）	5/8"Flare （16）		
RC2 -310	2"			3"			7/8" Flare （22.4）	5/8"Flare （16）	3/8"Flare （9.7）	5/8"Flare （16）		
RC2 -340	2-1/2"	Φ68	Φ77.2	4"	Φ93	Φ110	7/8" Flare （22.4）	5/8"Flare （16）	3/8"Flare （9.7）	5/8"Flare （16）		
RC2 -370	2-1/2"			4"			7/8" Flare （22.4）	5/8"Flare （16）	3/8"Flare （9.7）	5/8"Flare （16）		
RC2 -410	2-1/2"			4"			7/8" Flare （22.4）	5/8"Flare （16）	3/8"Flare （9.7）	5/8"Flare （16）		
RC2 -470	2-1/2"			4"			7/8" Flare （22.4）	5/8"Flare （16）	3/8"Flare （9.7）	5/8"Flare （16）		
RC2 -510	3"	Φ80.5	Φ90.2	4"			Φ106	Φ135	7/8" Flare （22.4）	5/8"Flare （16）	3/8"Flare （9.7）	5/8"Flare （16）
RC2 -550	3"			4"					1-1/8" Flare （28.8）	5/8"Flare （16）	3/8"Flare （9.7）	5/8"Flare （16）
RC2 -580	3"			4"					1-1/8" Flare （28.8）	5/8"Flare （16）	3/8"Flare （9.7）	5/8"Flare （16）
RC2 -620	3"			5"					1-1/8" Flare （28.8）	5/8"Flare （16）	3/8"Flare （9.7）	5/8"Flare （16）
RC2 -710	4"	Φ93	Φ110	5"	Φ106	Φ135			1-1/8" Flare （28.8）	3/4"Flare （19.2）	3/8"Flare （9.7）	5/8"Flare （16）
RC2 -790	4"			5"					1-1/8" Flare （28.8）	3/4"Flare （19.2）	3/8"Flare （9.7）	5/8"Flare （16）
RC2 -830	4"			5"					1-1/8" Flare （28.8）	3/4"Flare （19.2）	3/8"Flare （9.7）	5/8"Flare （16）
RC2 -930	4"			5"					1-1/8" Flare （28.8）	3/4"Flare （19.2）	3/8"Flare （9.7）	5/8"Flare （16）
RC2-1020	4"	Φ93	Φ110	6"			钢 Φ159		1-3/8" Flare （35.2）	3/4"Flare （19.2）	5/8"Flare （16）	
RC2-1130	4"			6"					1-3/8" Flare （35.2）	3/4"Flare （19.2）	5/8"Flare （16）	
RC2-1270	5"	Φ106	Φ135	8"			钢 Φ218		2"flange	3/4"Flare （19.2）	5/8"Flare （16）	
RC2-1530	5"			8"					2"flange	3/4"Flare （19.2）	5/8"Flare （16）	

Specification of RC2 -100BZ~1530BZ (Horizontal oil separator) connector

Mode	Discharge flange	Cooper pipe	Steel pipe	Suction flange	Coope r pipe	Steel pipe	Economizer	Main return port	Oil injection port	Liquid injection
RC2 -100P	2"	Φ55	Φ61.3	2"	Φ55	Φ61.3	5/8" Flare (16.1)	3/8"Flare (9.7)	3/8"Flare (9.7)	3/8"Flare (9.7)
RC2 -140P	2"			2"			5/8" Flare (16.1)	3/8"Flare (9.7)	3/8"Flare (9.7)	3/8"Flare (9.7)
RC2 -180P	2"			Φ68	Φ77.2	2-1/2"	5/8" Flare (16.1)	3/8"Flare (9.7)	3/8"Flare (9.7)	5/8"Flare (16)
RC2 -200P	2"					2-1/2"	5/8" Flare (16.1)	5/8"Flare (16)	3/8"Flare (9.7)	5/8"Flare (16)
RC2 -230P	2-1/2"	Φ68	Φ77.2	3"	Φ80.5	Φ90.2	5/8" Flare (16.1)	5/8"Flare (16)	3/8"Flare (9.7)	5/8"Flare (16)
RC2 -260P	2-1/2"			3"			5/8" Flare (16.1)	5/8"Flare (16)	3/8"Flare (9.7)	5/8"Flare (16)
RC2 -300P	2-1/2"			3"			7/8" Flare (22.4)	5/8"Flare (16)	3/8"Flare (9.7)	5/8"Flare (16)
RC2 -310P	2-1/2"			3"			7/8" Flare (22.4)	5/8"Flare (16)	3/8"Flare (9.7)	5/8"Flare (16)
RC2 -340P	2-1/2"			Φ93	Φ110	7/8" Flare (22.4)	5/8"Flare (16)	3/8"Flare (9.7)	5/8"Flare (16)	
RC2 -370P	2-1/2"					7/8" Flare (22.4)	5/8"Flare (16)	3/8"Flare (9.7)	5/8"Flare (16)	
RC2 -410P	3"	Φ80.5	Φ90.2	4"	Φ93	Φ110	7/8" Flare (22.4)	5/8"Flare (16)	3/8"Flare (9.7)	5/8"Flare (16)
RC2 -470P	3"			4"			7/8" Flare (22.4)	5/8"Flare (16)	3/8"Flare (9.7)	5/8"Flare (16)
RC2 -510P	3"			4"			7/8" Flare (22.4)	5/8"Flare (16)	3/8"Flare (9.7)	5/8"Flare (16)
RC2 -550P	3"			4"			1-1/8" Flare (28.8)	5/8"Flare (16)	3/8"Flare (9.7)	5/8"Flare (16)
RC2 -580P	3"			4"			1-1/8" Flare (28.8)	5/8"Flare (16)	3/8"Flare (9.7)	5/8"Flare (16)
RC2 -620P	4"			Φ93			Φ110	5"	Φ106	Φ135
RC2 -710P	4"	5"	1-1/8" Flare (28.8)		3/4"Flare (19.2)	3/8"Flare (9.7)		5/8"Flare (16)		
RC2 -790P	4"	5"	1-1/8" Flare (28.8)		3/4"Flare (19.2)	3/8"Flare (9.7)		5/8"Flare (16)		
RC2 -830P	4"	5"	1-1/8" Flare (28.8)		3/4"Flare (19.2)	3/8"Flare (9.7)		5/8"Flare (16)		
RC2 -930P	4"	5"	1-1/8" Flare (28.8)		3/4"Flare (19.2)	3/8"Flare (9.7)		5/8"Flare (16)		
RC2 -1020P	5"	Φ106	Φ135	6"	Steel Φ159		1-3/8" Flare (35.2)	3/4"Flare (19.2)	5/8"Flare (16)	
RC2 -1130P	5"			6"			1-3/8" Flare (35.2)	3/4"Flare (19.2)	5/8"Flare (16)	
RC2 -1270P	6"	Steel Φ159		8"	Steel Φ218		2"flange	3/4"Flare (19.2)	5/8"Flare (16)	
RC2 -1530P	6"			8"			2"flange	3/4"Flare (19.2)	5/8"Flare (16)	

Application Limits

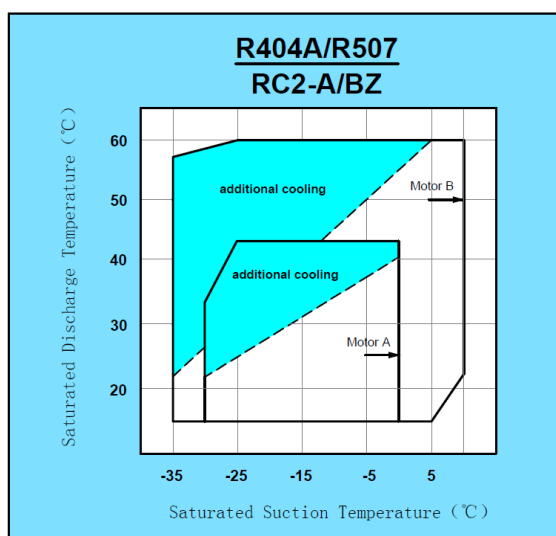
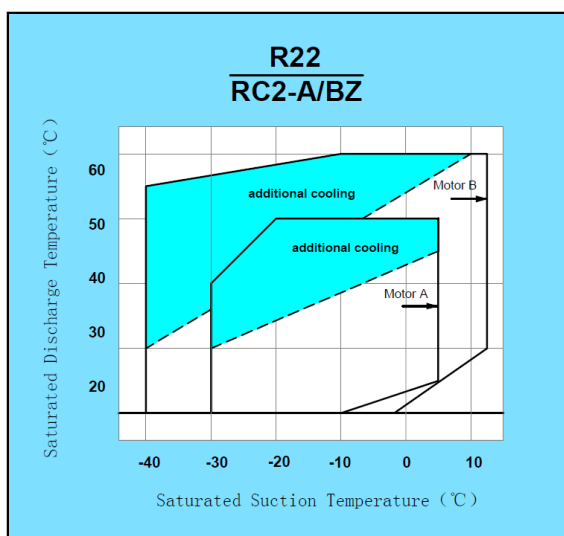

Official website



Official WeChat



Electronic Brochures



上海漢鐘精機股份有限公司
SHANGHAI HANBELL PRECISE MACHINERY CO., LTD.

No.8289, Tingfeng Road, Fengjing Area, Jinshan District, Shanghai, China

TEL: 021-57350280 FAX: 021-51368588

Service Line: 4007702158

P.C.: 201501

http: //www.hanbell.com.cn

SHANGHAI HANBELL PRECISE MACHINERY CO.,LTD.

JINAN BRANCH

No.4 Building, Liando U Valley International Enterprise Port, No. 2222, South Section of Yuqing Road, Changqing District, Jinan, Shandong Prov.

TEL: 0531-85060075 FAX: 0531-85060071

SHANGHAI HANBELL PRECISE MACHINERY CO.,LTD.

NANJING BRANCH

No.95, Gaohu Road, Jiangning District, Nanjing City

TEL: 025-52078091/1/3 FAX: 025-52078090

SHANGHAI HANBELL PRECISE MACHINERY CO.,LTD.

GUANGZHOU BRANCH

No.15 Wenkeng Road Lianwang Industrial Park, Guangzhou, Guangdong Prov.

TEL: 020-34721075 FAX: 020-3472325

SHANGHAI HANBELL PRECISE MACHINERY CO.,LTD.

CHONGQING BRANCH

Building A10, Dongben Industrial Park, No.18, Yu Ma Road, chayuan New District, Chongqing, China

TEL: 023-62611068 FAX: 023-62611069