



RG Series

RG Series Screw Compressor



Product Description

Hanbell RG series is one multifunctional open-type screw compressor with high-efficient screw rotor which is compatible with several special gases such as ammonia, fluorine. The compressor has adjustable VI selection between 2.6 and 5.6 and can use floating energy-saving holes with higher efficiency and higher energy efficiency ratio. The balanced piston design makes compressor more reliable in use. RG series compressor can meet different application requirements of customer.

Nomenclature

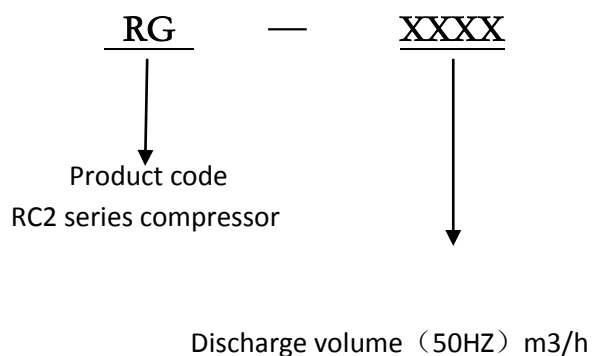

Product Features

Suitable for ammonia and other refrigerants

Various refrigerants including hydrocarbons can be compressed, R22 、 R717 、 R134a 、 R502 、 R507、 R170(Ethane)、 R290(Propane)、 R1150(Ethylene)、 R1270 (Propylene) 、 RE170 (Dimethyl ether)

High-efficient patent flute profile

Rotor with Hanbell patent rotor profile, 5:6 gear ratio, high volume efficiency, low leakage, long life-time

High quality shaft seal

We adopt well-known British brands John Crane

Durable and stable bearings

We adopt SKF bearing, a well-known Swedish brand in the industry, which can meet the demand of super-long life-time.

Stepless and adjustable energy slide valve

It can realize the stepless adjustment from 25% to 100% or four-stage adjustment (partial models), thus compressor can supply cooling energy according to the requirement and save the electric charge.

Stepless adjustable inner volume ratio slide valve

It can realize stepless manual adjustment from 2.6 to 5.6; RG1150~2850 inner volume ratio can be adjusted automatically; inner volume ratio slide valve of partial models are optional, which can meet the requirement under different working condition and always operate efficiently and smoothly

RG Production Specification

Model No.		RG-200	RG-410	RG-620	RG-830	RG1150	RG1270	RG1800	RG2280	RG2850
Discharge volume (50Hz)	m³/h	190	402	619	816	1146	1264	1761	2270	2851
Max	Rpm	4500					3600			
Min	Rpm	1500								
Adjustment range		25%～100%								
VI range		2.6～5.1				2.6～5.6				
Weight	kg	232	320	475	513	1000	1166	1600	1720	1900

Performance Form (Without ECO)

RG200, R22								
Saturated Discharge Temp. (°C)	Saturated Suction Temp. (°C)	-50	-40	-30	-20	-10	0	10
30	Cooling capacity (kW)	19.9	35.1	56.2	86.2	128.1	184.7	259.2
	Power (kW)	21.1	24.1	27.3	30.5	33.5	36.3	38.5
	COP	0.944	1.458	2.062	2.829	3.819	5.092	6.727
35	Cooling capacity (kW)	18.2	33.0	53.2	81.9	122.0	176.6	248.5
	Power (kW)	22.5	26.0	29.7	33.1	36.3	39.0	41.1
	COP	0.811	1.266	1.793	2.471	3.361	4.527	6.053
40	Cooling capacity (kW)	16.3	30.6	49.9	77.3	115.7	168.1	237.6
	Power (kW)	23.9	28.2	32.3	36.1	39.5	42.2	44.1
	COP	0.682	1.085	1.545	2.140	2.931	3.985	5.385
45	Cooling capacity (kW)	--	28.0	46.4	72.4	109.1	159.4	226.2
	Power (kW)	--	30.5	35.2	39.5	43.1	45.9	47.7
	COP	--	0.916	1.316	1.835	2.533	3.473	4.738
50	Cooling capacity (kW)	--	--	42.6	67.3	102.2	150.3	214.6
	Power (kW)	--	--	38.5	43.2	47.2	50.2	52.0
	COP	--	--	1.107	1.557	2.167	2.997	4.126

RG200, R717								
Saturated Discharge Temp. (°C)	Saturated Suction Temp. (°C)	-50	-40	-30	-20	-10	0	10
30	Cooling capacity (kW)	15.9	29.7	50.7	82.2	127.2	188.6	269.5
	Power (kW)	21.5	23.8	26.9	30.3	33.4	35.6	36.4
	COP	0.743	1.248	1.886	2.713	3.807	5.295	7.411
35	Cooling capacity (kW)	14.7	28.2	48.6	79.2	122.8	182.6	261.5
	Power (kW)	23.7	26.0	29.3	33.1	36.7	39.6	41.2
	COP	0.623	1.084	1.659	2.393	3.347	4.612	6.351
40	Cooling capacity (kW)	13.3	26.5	46.3	75.9	118.3	176.4	253.5
	Power (kW)	26.1	28.4	31.9	36.0	40.1	43.7	46.1
	COP	0.510	0.931	1.451	2.108	2.947	4.039	5.498
45	Cooling capacity (kW)	--	24.5	43.8	72.4	113.5	170.1	245.2
	Power (kW)	--	31.1	34.7	39.1	43.7	47.9	51.2
	COP	--	0.789	1.260	1.850	2.596	3.549	4.793
50	Cooling capacity (kW)	--	--	41.0	68.7	108.5	163.5	236.7
	Power (kW)	--	--	37.8	42.5	47.5	52.3	56.3
	COP	--	--	1.083	1.616	2.283	3.124	4.201

★ Please download HANBELL selection program to select the oil cooling data according to conditions

RG410, R22								
Saturated Discharge Temp. (°C)	Saturated Suction Temp. (°C)	-50	-40	-30	-20	-10	0	10
30	Cooling capacity (kW)	42.4	74.7	119.5	183.2	272.1	392.5	550.7
	Power (kW)	43.9	50.1	56.7	63.4	69.7	75.4	80.1
	COP	0.965	1.490	2.107	2.891	3.902	5.203	6.873
35	Cooling capacity (kW)	38.7	70.0	113.0	174.0	259.3	375.2	528.1
	Power (kW)	46.7	54.2	61.7	68.9	75.5	81.1	85.4
	COP	0.829	1.293	1.832	2.525	3.434	4.625	6.185
40	Cooling capacity (kW)	34.7	64.9	106.0	164.2	245.9	357.3	504.8
	Power (kW)	49.7	58.6	67.1	75.1	82.1	87.8	91.7
	COP	0.697	1.109	1.579	2.186	2.995	4.071	5.502
45	Cooling capacity (kW)	—	59.4	98.5	153.9	231.8	338.6	480.7
	Power (kW)	—	63.5	73.2	82.1	89.6	95.4	99.3
	COP	—	0.936	1.345	1.875	2.588	3.548	4.841
50	Cooling capacity (kW)	—	—	90.5	143.0	217.2	319.4	455.9
	Power (kW)	—	—	80.1	89.9	98.1	104.3	108.2
	COP	—	—	1.131	1.590	2.214	3.062	4.215

RG410, R717								
Saturated Discharge Temp. (°C)	Saturated Suction Temp. (°C)	-50	-40	-30	-20	-10	0	10
30	Cooling capacity (kW)	34.0	63.2	108.1	175.2	271.0	401.8	574.2
	Power (kW)	44.8	49.6	56.2	63.3	69.7	74.3	75.9
	COP	0.758	1.274	1.925	2.770	3.886	5.405	7.566
35	Cooling capacity (kW)	31.4	60.0	103.6	168.7	261.7	389.1	557.3
	Power (kW)	49.4	54.2	61.2	69.0	76.6	82.6	86.0
	COP	0.636	1.107	1.694	2.443	3.417	4.709	6.483
40	Cooling capacity (kW)	28.4	56.4	98.7	161.8	252.0	376.0	540.1
	Power (kW)	54.4	59.3	66.6	75.2	83.8	91.2	96.2
	COP	0.521	0.951	1.482	2.152	3.009	4.123	5.612
45	Cooling capacity (kW)	—	52.3	93.3	154.4	241.9	362.5	522.5
	Power (kW)	—	64.9	72.5	81.7	91.3	100.0	106.8
	COP	—	0.805	1.286	1.889	2.650	3.623	4.894
50	Cooling capacity (kW)	—	—	87.3	146.4	231.3	348.5	504.4
	Power (kW)	—	—	78.9	88.7	99.2	109.3	117.6
	COP	—	—	1.106	1.650	2.331	3.189	4.288

★ Please download HANBELL selection program to select the oil cooling data according to conditions

RG620, R22								
Saturated Discharge Temp. (°C)	Saturated Suction Temp. (°C)	-50	-40	-30	-20	-10	0	10
30	Cooling capacity (kW)	64.8	114.2	182.8	280.3	416.3	600.5	842.5
	Power (kW)	65.9	75.2	85.1	95.1	104.6	113.1	120.2
	COP	0.984	1.519	2.149	2.948	3.980	5.307	7.010
35	Cooling capacity (kW)	59.2	107.1	172.9	266.2	396.7	574.1	807.9
	Power (kW)	70.1	81.2	92.5	103.4	113.3	121.7	128.1
	COP	0.845	1.319	1.869	2.575	3.502	4.717	6.308
40	Cooling capacity (kW)	53.0	99.3	162.2	251.2	376.1	546.6	772.2
	Power (kW)	74.6	87.8	100.7	112.6	123.1	131.6	137.6
	COP	0.711	1.131	1.610	2.230	3.055	4.152	5.611
45	Cooling capacity (kW)	—	90.9	150.7	235.4	354.6	518.1	735.4
	Power (kW)	—	95.2	109.9	123.1	134.4	143.2	148.9
	COP	—	0.955	1.372	1.912	2.639	3.619	4.937
50	Cooling capacity (kW)	—	—	138.5	218.8	332.2	488.6	697.5
	Power (kW)	—	—	120.1	134.9	147.1	156.4	162.2
	COP	—	—	1.153	1.622	2.258	3.123	4.299

RG620, R717								
Saturated Discharge Temp. (°C)	Saturated Suction Temp. (°C)	-50	-40	-30	-20	-10	0	10
30	Cooling capacity (kW)	52.3	97.3	166.4	269.7	417.0	618.4	883.7
	Power (kW)	66.8	73.9	83.7	94.3	103.9	110.8	113.1
	COP	0.783	1.316	1.989	2.861	4.014	5.583	7.814
35	Cooling capacity (kW)	48.3	92.4	159.5	259.6	402.7	598.7	857.7
	Power (kW)	73.6	80.8	91.2	102.9	114.1	123.1	128.1
	COP	0.657	1.143	1.749	2.524	3.529	4.863	6.696
40	Cooling capacity (kW)	43.6	86.8	151.9	248.9	387.9	578.6	831.2
	Power (kW)	81.1	88.4	99.3	112.0	124.8	135.9	143.4
	COP	0.538	0.982	1.530	2.223	3.108	4.259	5.797
45	Cooling capacity (kW)	—	80.4	143.6	237.6	372.3	557.9	804.1
	Power (kW)	—	96.7	108.1	121.8	136.0	149.1	159.1
	COP	—	0.832	1.329	1.951	2.737	3.742	5.054
50	Cooling capacity (kW)	—	—	134.4	225.3	356.0	536.3	776.2
	Power (kW)	—	—	117.6	132.2	147.9	162.8	175.2
	COP	—	—	1.142	1.704	2.407	3.294	4.429

★ Please download HANBELL selection program to select the oil cooling data according to conditions

RG830, R22								
Saturated Discharge Temp. (°C)	Saturated Suction Temp. (°C)	-50	-40	-30	-20	-10	0	10
30	Cooling capacity (kW)	88.1	155.2	248.4	380.8	565.5	815.7	1144.6
	Power (kW)	86.4	98.6	111.6	124.7	137.2	148.4	157.6
	COP	1.019	1.574	2.226	3.054	4.122	5.497	7.262
35	Cooling capacity (kW)	80.5	145.5	234.9	361.6	538.9	779.9	1097.6
	Power (kW)	91.9	106.5	121.3	135.6	148.5	159.6	168.0
	COP	0.876	1.366	1.936	2.668	3.628	4.887	6.534
40	Cooling capacity (kW)	72.1	134.9	220.3	341.3	511.0	742.6	1049.1
	Power (kW)	97.8	115.2	132.1	147.7	161.5	172.6	180.5
	COP	0.737	1.171	1.668	2.31	3.164	4.301	5.813
45	Cooling capacity (kW)	---	123.5	204.7	319.8	481.8	703.8	999.1
	Power (kW)	---	124.8	144.1	161.4	176.2	187.8	195.3
	COP	---	0.989	1.421	1.981	2.734	3.749	5.115
50	Cooling capacity (kW)	---	---	188.2	297.2	451.3	663.8	947.6
	Power (kW)	---	---	157.5	176.9	193.0	205.2	212.8
	COP	---	---	1.195	1.680	2.339	3.235	4.454

RG830, R717								
Saturated Discharge Temp. (°C)	Saturated Suction Temp. (°C)	-50	-40	-30	-20	-10	0	10
30	Cooling capacity (kW)	71.1	132.3	226.3	366.6	566.9	840.7	1201.4
	Power (kW)	87.5	96.8	109.6	123.4	136.0	145.0	148.1
	COP	0.813	1.366	2.065	2.970	4.168	5.797	8.114
35	Cooling capacity (kW)	65.7	125.6	216.8	352.9	547.5	814.0	1166.1
	Power (kW)	96.3	105.8	119.4	134.7	149.4	161.2	167.7
	COP	0.682	1.187	1.816	2.621	3.664	5.050	6.953
40	Cooling capacity (kW)	59.3	118.0	206.5	338.4	527.3	786.7	1130.1
	Power (kW)	106.2	115.7	130.0	146.6	163.4	177.9	187.8
	COP	0.559	1.020	1.589	2.308	3.227	4.422	6.019
45	Cooling capacity (kW)	---	109.4	195.2	323.0	506.2	758.4	1093.2
	Power (kW)	---	126.6	141.5	159.4	178.1	195.2	208.3
	COP	---	0.864	1.380	2.026	2.842	3.886	5.248
50	Cooling capacity (kW)	---	---	182.7	306.3	483.9	729.1	1055.3
	Power (kW)	---	---	154.0	173.1	193.6	213.2	229.4
	COP	---	---	1.186	1.770	2.500	3.420	4.599

★ Please download HANBELL selection program to select the oil cooling data according to conditions

RG1150, R22								
Saturated Discharge Temp. (°C)	Saturated Suction Temp. (°C)	-50	-40	-30	-20	-10	0	10
30	Cooling capacity (kW)	129.0	227.3	363.8	557.8	828.4	1194.8	1676.5
	Power (kW)	143.9	164.3	185.9	207.8	228.6	247.3	262.6
	COP	0.896	1.383	1.957	2.684	3.624	4.832	6.383
35	Cooling capacity (kW)	116.6	211.0	340.5	524.3	781.2	1130.5	1591.1
	Power (kW)	151.5	175.7	200.1	223.6	245.0	263.4	277.0
	COP	0.770	1.201	1.702	2.344	3.189	4.292	5.743
40	Cooling capacity (kW)	103.4	193.6	316.1	489.5	733.0	1065.2	1505.0
	Power (kW)	159.7	188.1	215.6	241.2	263.6	281.9	294.7
	COP	0.647	1.029	1.466	2.029	2.780	3.779	5.107
45	Cooling capacity (kW)	---	175.2	290.6	453.9	683.9	999.0	1418.1
	Power (kW)	---	201.7	232.8	260.8	284.7	303.4	315.6
	COP	---	0.869	1.248	1.740	2.402	3.293	4.493
50	Cooling capacity (kW)	---	---	264.2	417.4	633.8	932.1	1330.6
	Power (kW)	---	---	251.8	282.8	308.6	328.0	340.2
	COP	---	---	1.049	1.476	2.054	2.842	3.911

RG1150, R717								
Saturated Discharge Temp. (°C)	Saturated Suction Temp. (°C)	-50	-40	-30	-20	-10	0	10
30	Cooling capacity (kW)	113.4	210.9	360.6	584.4	903.7	1340.2	1915.3
	Power (kW)	132.8	146.9	166.3	187.3	206.4	220.1	224.7
	COP	0.854	1.435	2.168	3.120	4.378	6.089	8.523
35	Cooling capacity (kW)	103.6	198.0	342.0	556.8	863.8	1284.3	1839.7
	Power (kW)	144.7	159.0	179.3	202.4	224.5	242.2	252.0
	COP	0.716	1.246	1.907	2.751	3.847	5.304	7.302
40	Cooling capacity (kW)	92.6	184.2	322.4	528.4	823.3	1228.3	1764.4
	Power (kW)	157.9	172.1	193.2	218.1	243.0	264.5	279.2
	COP	0.587	1.070	1.669	2.423	3.388	4.643	6.320
45	Cooling capacity (kW)	---	168.9	301.6	499.0	782.0	1171.6	1688.9
	Power (kW)	---	186.3	208.2	234.6	262.2	287.2	306.6
	COP	---	0.907	1.448	2.127	2.983	4.079	5.508
50	Cooling capacity (kW)	---	---	279.2	468.2	739.6	1114.3	1613.0
	Power (kW)	---	---	224.3	252.1	282.0	310.5	334.2
	COP	---	---	1.245	1.857	2.623	3.589	4.826

★ Please download HANBELL selection program to select the oil cooling data according to conditions

RG1270, R22								
Saturated Discharge Temp. (°C)	Saturated Suction Temp. (°C)	-50	-40	-30	-20	-10	0	10
30	Cooling capacity (kW)	133.0	234.3	375.1	575.0	854.0	1231.8	1728.3
	Power (kW)	145.4	166.0	187.8	209.9	230.9	249.8	265.3
	COP	0.914	1.412	1.997	2.740	3.699	4.932	6.515
35	Cooling capacity (kW)	121.5	219.8	354.7	546.1	813.8	1177.6	1657.4
	Power (kW)	154.6	179.3	204.2	228.2	250.0	268.8	282.7
	COP	0.786	1.226	1.737	2.393	3.255	4.384	5.862
40	Cooling capacity (kW)	108.8	203.8	332.7	515.3	771.6	1121.3	1584.2
	Power (kW)	164.6	193.9	222.3	248.7	271.8	290.6	303.8
	COP	0.661	1.051	1.497	2.072	2.839	3.859	5.215
45	Cooling capacity (kW)	--	186.4	309.1	482.9	727.5	1062.8	1508.6
	Power (kW)	--	210.1	242.5	271.7	296.6	316.0	328.8
	COP	--	0.887	1.275	1.777	2.453	3.93	4.589
50	Cooling capacity (kW)	--	--	284.1	448.8	681.5	1002.3	1430.8
	Power (kW)	--	--	265.1	297.7	324.8	345.3	358.1
	COP	--	--	1.072	1.507	2.098	2.902	3.966

RG1270, R717								
Saturated Discharge Temp. (°C)	Saturated Suction Temp. (°C)	-50	-40	-30	-20	-10	0	10
30	Cooling capacity (kW)	116.9	217.4	371.8	602.5	931.7	1381.6	1974.5
	Power (kW)	134.1	148.4	168.0	189.2	208.5	222.3	227.0
	COP	0.872	1.465	2.214	3.184	4.468	6.214	8.698
35	Cooling capacity (kW)	107.9	206.3	356.3	580.0	899.8	1337.8	1916.4
	Power (kW)	147.7	162.2	183.0	206.5	229.1	247.1	257.1
	COP	0.731	1.272	1.947	2.809	3.928	5.413	7.454
40	Cooling capacity (kW)	97.5	193.9	339.4	556.2	866.6	1292.9	1857.3
	Power (kW)	162.8	177.4	199.2	224.8	250.5	272.7	287.8
	COP	0.559	1.093	1.703	2.474	3.459	4.741	6.452
45	Cooling capacity (kW)	--	179.7	320.8	530.8	831.9	1246.4	1796.7
	Power (kW)	--	194.1	216.9	244.4	273.1	299.2	319.4
	COP	--	0.926	1.479	2.172	3.047	4.165	5.626
50	Cooling capacity (kW)	--	--	300.2	503.4	795.3	1198.2	1734.4
	Power (kW)	--	--	236.1	265.4	296.8	326.8	351.8
	COP	--	--	1.272	1.897	2.680	3.666	4.930

★ Please download HANBELL selection program to select the oil cooling data according to conditions

RG1800, R22								
Saturated Discharge Temp. (°C)	Saturated Suction Temp. (°C)	-50	-40	-30	-20	-10	0	10
30	Cooling capacity (kW)	188.5	332.0	531.5	814.8	1210.1	1745.5	2449.0
	Power (kW)	203.6	232.4	262.9	293.9	323.3	349.7	371.4
	COP	0.926	1.429	2.022	2.773	3.743	4.991	6.594
35	Cooling capacity (kW)	172.2	311.5	502.6	773.8	1153.2	1668.7	2348.5
	Power (kW)	216.4	251.0	285.9	319.5	350.0	376.3	395.8
	COP	0.795	1.241	1.758	2.422	3.295	4.434	5.934
40	Cooling capacity (kW)	154.2	288.8	471.4	730.2	1093.4	1588.9	2244.8
	Power (kW)	230.4	271.5	311.2	348.2	380.5	406.8	425.3
	COP	0.669	1.064	1.515	2.097	2.873	3.905	5.278
45	Cooling capacity (kW)	---	264.1	438.0	684.3	1030.9	1506.0	2137.7
	Power (kW)	---	294.1	339.5	380.4	415.2	442.4	460.3
	COP	---	0.898	1.290	1.799	2.483	3.404	4.644
50	Cooling capacity (kW)	---	---	402.6	635.9	965.7	1420.3	2027.4
	Power (kW)	---	---	371.1	416.8	454.7	483.4	501.3
	COP	---	---	1.085	1.526	2.124	2.938	4.044

RG1800, R717								
Saturated Discharge Temp. (°C)	Saturated Suction Temp. (°C)	-50	-40	-30	-20	-10	0	10
30	Cooling capacity (kW)	165.6	308.1	526.8	853.7	1320.2	1957.7	2797.9
	Power (kW)	187.7	207.8	235.2	264.9	291.9	311.2	317.8
	COP	0.882	1.483	2.240	3.223	4.523	6.290	8.804
35	Cooling capacity (kW)	152.9	292.3	504.9	821.9	1275.0	1895.7	2715.5
	Power (kW)	206.8	227.1	256.2	289.1	320.7	345.9	359.9
	COP	0.739	1.287	1.971	2.843	3.975	5.480	7.544
40	Cooling capacity (kW)	138.2	274.8	480.9	788.1	1228.0	1832.0	2631.8
	Power (kW)	227.9	248.4	278.9	314.7	350.7	381.8	402.9
	COP	0.606	1.106	1.725	2.504	3.501	4.799	6.532
45	Cooling capacity (kW)	---	254.6	454.6	752.1	1178.8	1766.1	2545.9
	Power (kW)	---	271.7	303.7	342.2	382.3	418.9	447.2
	COP	---	0.937	1.497	2.198	3.083	4.216	5.694
50	Cooling capacity (kW)	---	---	425.4	713.3	1126.9	1697.8	2457.6
	Power (kW)	---	---	330.5	371.6	415.5	457.5	492.5
	COP	---	---	1.287	1.920	2.712	3.711	4.990

★ Please download HANBELL selection program to select the oil cooling data according to conditions

RG2280, R22								
Saturated Discharge Temp. (°C)	Saturated Suction Temp. (°C)	-50	-40	-30	-20	-10	0	10
30	Cooling capacity (kW)	239.3	421.6	675.0	1034.8	1536.8	2216.7	3110.2
	Power (kW)	256.5	292.8	331.3	370.3	407.3	440.6	468.0
	COP	0.933	1.440	2.038	2.795	3.773	5.031	6.646
35	Cooling capacity (kW)	218.7	395.5	638.3	982.8	1464.5	2119.2	2982.6
	Power (kW)	272.7	316.3	360.2	402.5	441.0	474.2	498.7
	COP	0.802	1.251	1.772	2.441	3.321	4.469	5.981
40	Cooling capacity (kW)	195.8	366.8	598.7	927.3	1388.6	2017.9	2850.9
	Power (kW)	290.4	342.0	392.1	438.7	479.5	512.6	535.9
	COP	0.674	1.072	1.527	2.114	2.896	3.936	5.320
45	Cooling capacity (kW)	---	335.4	556.3	869.0	1309.2	1912.6	2714.9
	Power (kW)	---	370.6	427.8	479.3	523.2	557.4	580.0
	COP	---	0.905	1.300	1.813	2.502	3.431	4.681
50	Cooling capacity (kW)	---	---	511.3	807.7	1226.4	1803.7	2574.9
	Power (kW)	---	---	467.6	525.1	572.9	609.1	631.7
	COP	---	---	1.093	1.538	2.141	2.961	4.076

RG2280, R717								
Saturated Discharge Temp. (°C)	Saturated Suction Temp. (°C)	-50	-40	-30	-20	-10	0	10
30	Cooling capacity (kW)	210.4	391.2	669.1	1084.3	1676.7	2486.3	3553.3
	Power (kW)	236.6	261.8	296.4	333.7	367.8	392.1	400.4
	COP	0.889	1.495	2.258	3.249	4.559	6.340	8.874
35	Cooling capacity (kW)	194.2	371.3	641.2	1043.8	1619.3	2407.5	3448.7
	Power (kW)	260.5	286.1	322.8	364.3	404.1	435.9	453.5
	COP	0.745	1.298	1.986	2.865	4.007	5.523	7.604
40	Cooling capacity (kW)	175.5	348.9	610.8	1000.9	1559.5	2326.7	3342.4
	Power (kW)	287.2	312.9	351.4	396.5	441.9	481.0	507.7
	COP	0.611	1.115	1.738	2.524	3.529	4.837	6.584
45	Cooling capacity (kW)	---	323.4	577.3	955.2	1497.1	2243.0	3233.3
	Power (kW)	---	342.4	382.6	431.1	481.7	527.8	563.4
	COP	---	0.944	1.509	2.216	3.108	4.250	5.739
50	Cooling capacity (kW)	---	---	540.2	905.9	1431.2	2156.3	3121.2
	Power (kW)	---	---	416.5	468.2	523.6	576.5	620.6
	COP	---	---	1.297	1.935	2.734	3.740	5.030

RG28500, R22								
Saturated Discharge Temp. (°C)	Saturated Suction Temp. (°C)	-50	-40	-30	-20	-10	0	10
30	Cooling capacity (kW)	299.2	527.1	843.8	1293.5	1921.1	2770.9	3887.8
	Power (kW)	312.9	357.2	404.2	451.7	496.9	537.6	570.9
	COP	0.956	1.475	2.088	2.863	3.866	5.154	6.809
35	Cooling capacity (kW)	273.3	494.4	797.9	1228.4	1830.6	2649.0	3728.3
	Power (kW)	332.7	385.9	439.5	491.1	538.0	578.5	608.4
	COP	0.821	1.281	1.816	2.501	3.403	4.579	6.128
40	Cooling capacity (kW)	244.7	458.4	748.4	1159.2	1735.7	2522.4	3563.6
	Power (kW)	354.2	417.3	478.4	535.2	584.9	625.4	653.8
	COP	0.691	1.099	1.564	2.166	2.967	4.033	5.451
45	Cooling capacity (kW)	---	419.3	695.3	1086.3	1636.5	2390.8	3393.6
	Power (kW)	---	452.2	521.9	584.7	638.3	680.1	707.6
	COP	---	0.927	1.332	1.858	2.564	3.516	4.796
50	Cooling capacity (kW)	---	---	639.1	1009.6	1533.0	2254.7	3218.6
	Power (kW)	---	---	570.5	640.7	699.0	743.1	770.7
	COP	---	---	1.120	1.576	2.193	3.034	4.176

RG2850, R717								
Saturated Discharge Temp. (°C)	Saturated Suction Temp. (°C)	-50	-40	-30	-20	-10	0	10
30	Cooling capacity (kW)	263.0	489.0	836.4	1355.3	2095.8	3107.9	4441.6
	Power (kW)	288.6	319.4	361.5	407.2	448.7	478.4	488.5
	COP	0.911	1.531	2.313	3.329	4.671	6.496	9.092
35	Cooling capacity (kW)	242.7	464.1	801.5	1304.7	2024.1	3009.4	4310.9
	Power (kW)	317.9	349.1	393.8	444.4	493.0	531.8	553.3
	COP	0.764	1.329	2.035	2.936	4.105	5.659	7.791
40	Cooling capacity (kW)	219.3	436.2	763.5	1251.2	1949.4	2908.4	4178.0
	Power (kW)	350.4	381.8	428.7	483.8	539.1	586.9	619.4
	COP	0.626	1.142	1.781	2.586	3.616	4.956	6.746
45	Cooling capacity (kW)	---	404.2	721.6	1194.0	1871.3	2803.8	4041.7
	Power (kW)	---	417.7	466.8	526.0	587.7	643.9	687.4
	COP	---	0.968	1.546	2.270	3.184	4.354	5.880
50	Cooling capacity (kW)	---	---	675.3	1132.4	1789.0	2695.3	3901.5
	Power (kW)	---	---	508.1	571.2	638.7	703.3	757.1
	COP	---	---	1.329	1.983	2.801	3.832	5.153

RG200 Drawing

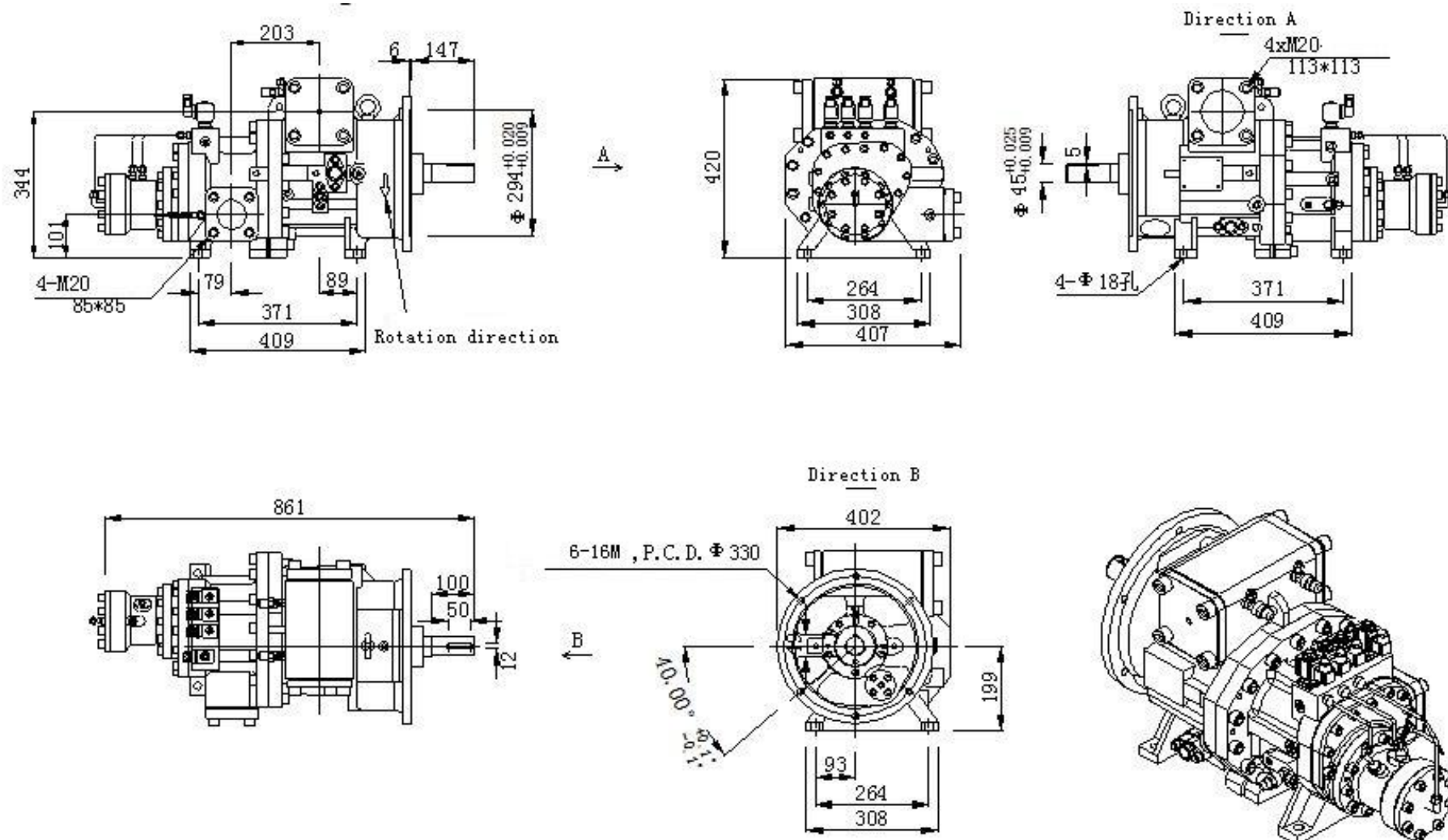

RG410 Drawing

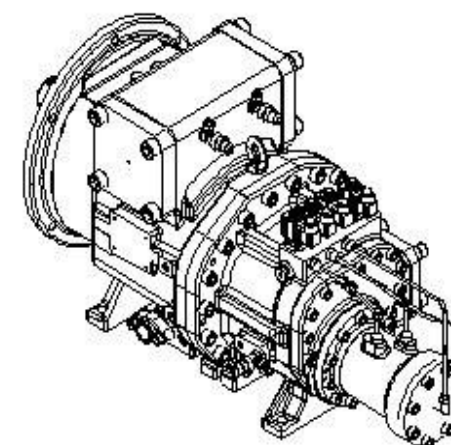
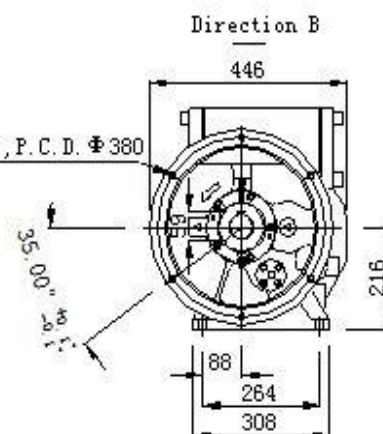
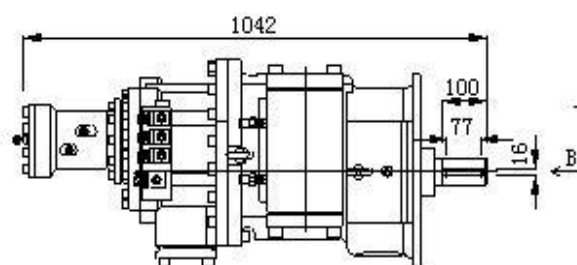
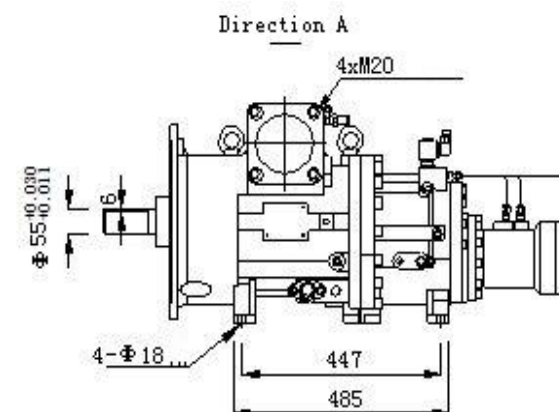
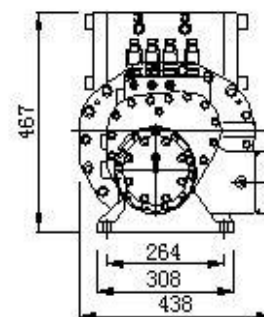
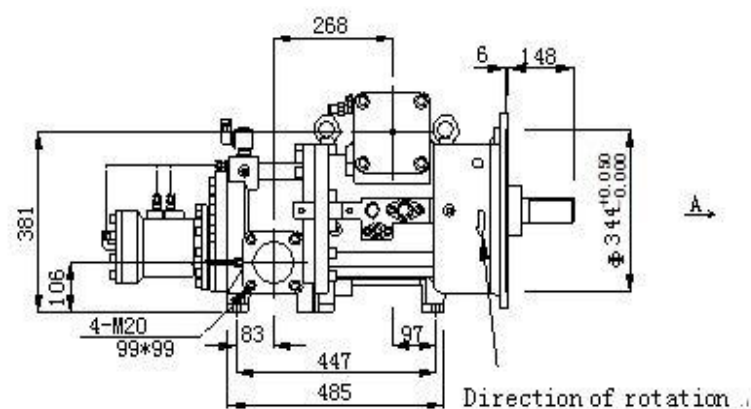

RG620 Drawing

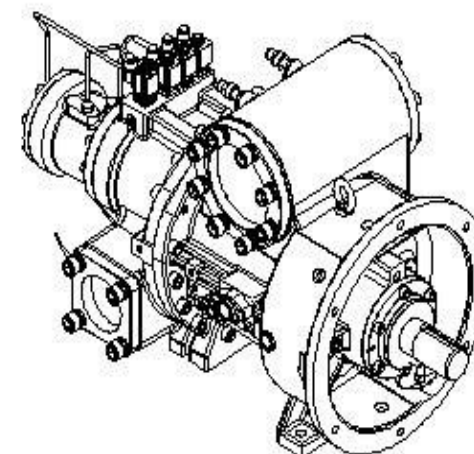
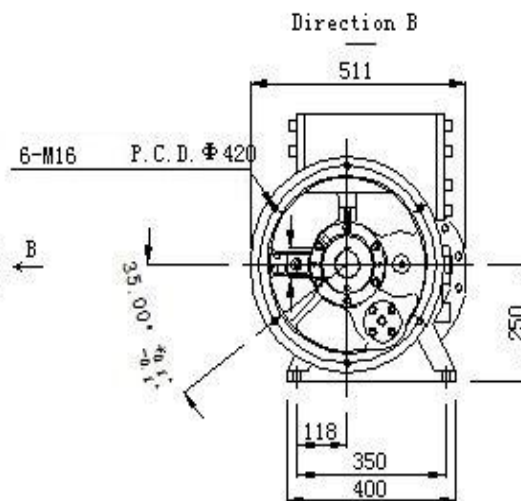
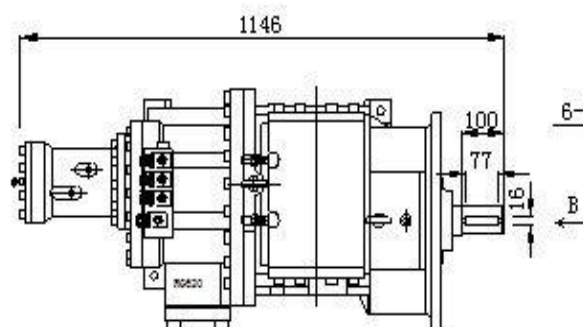
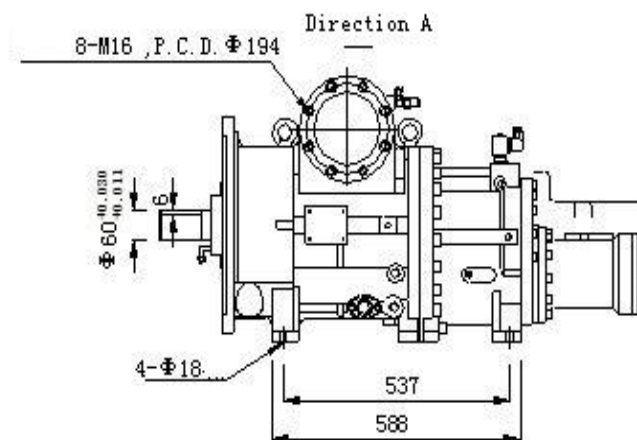
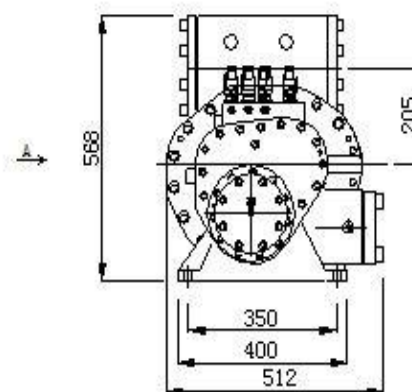
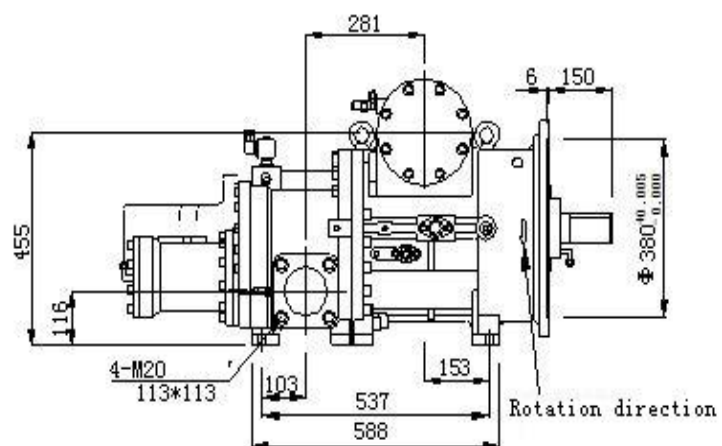

RG830 Drawing

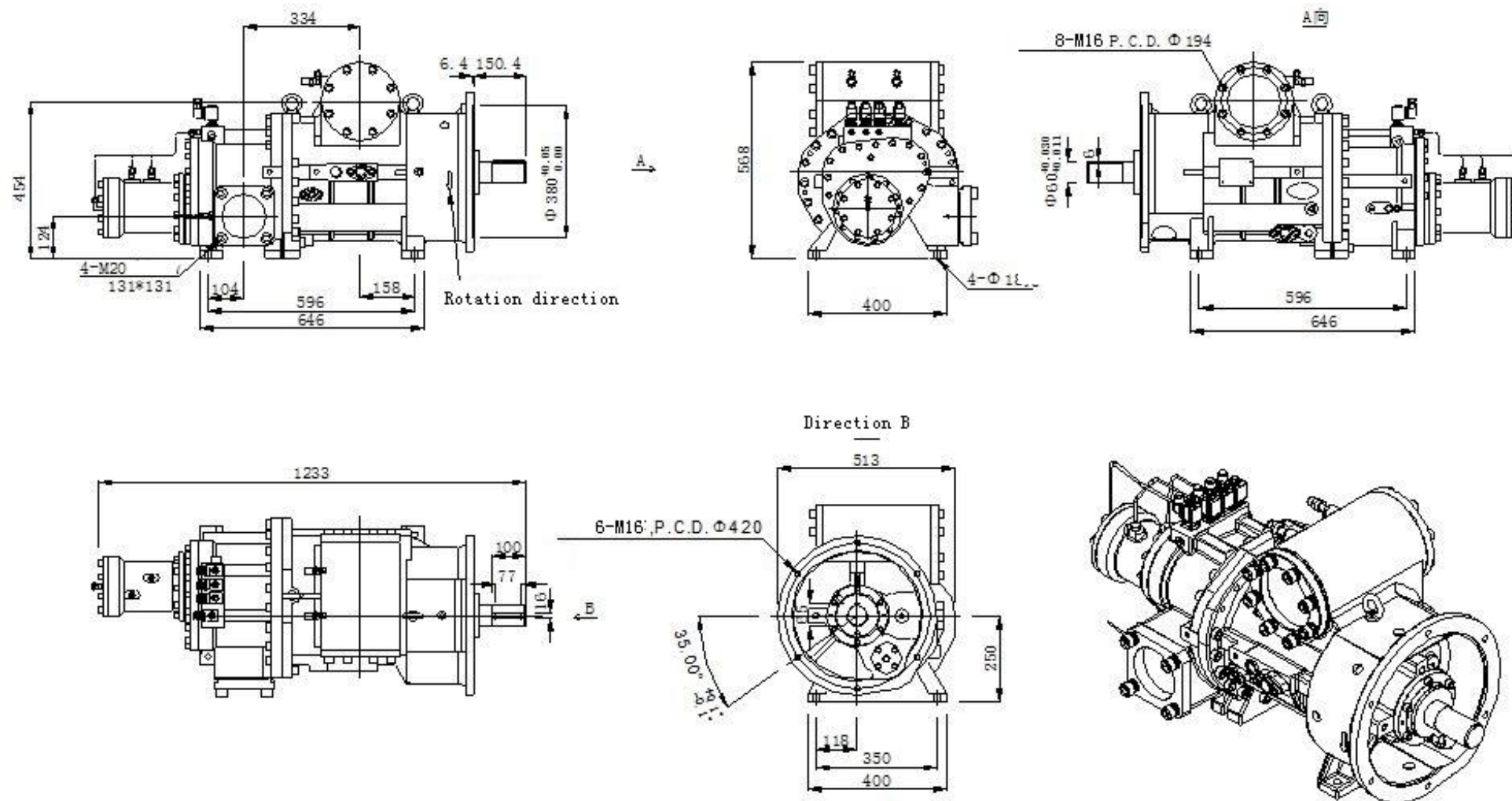

RG1150 Drawing

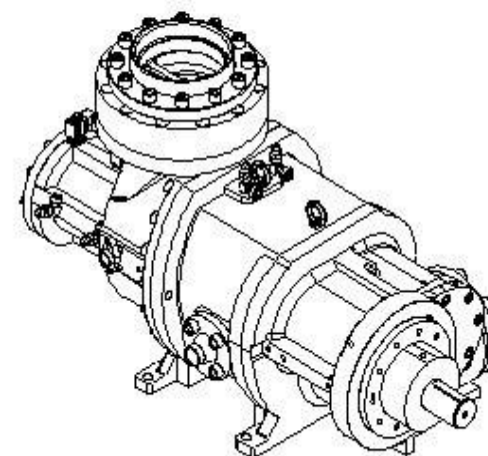
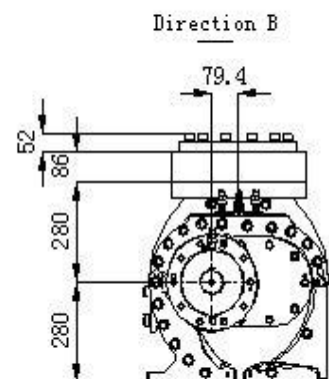
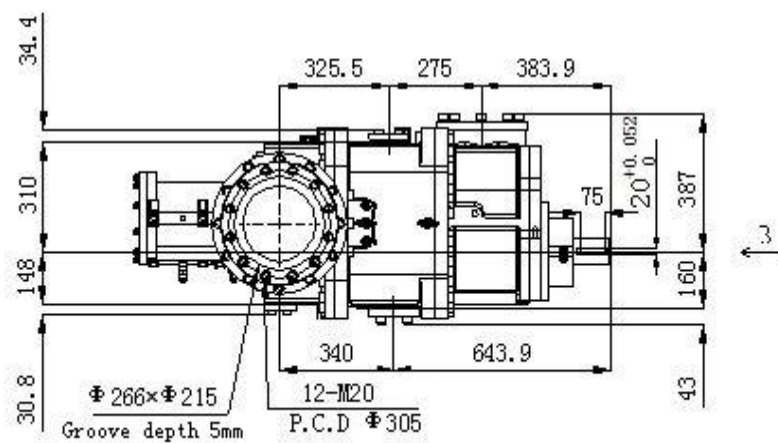
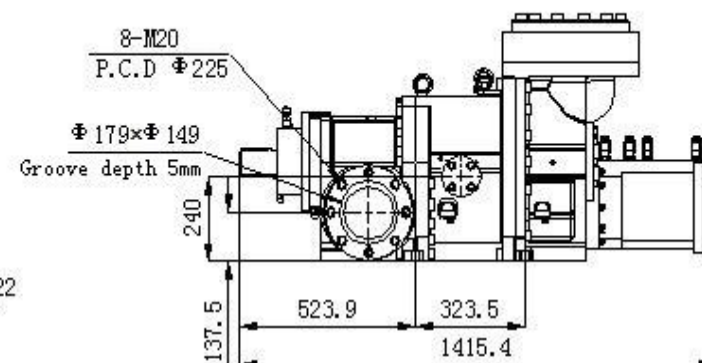
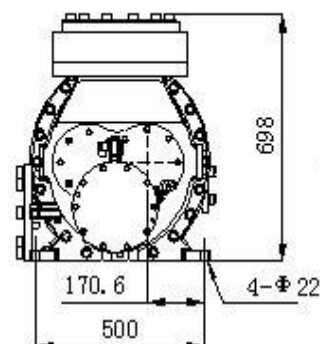
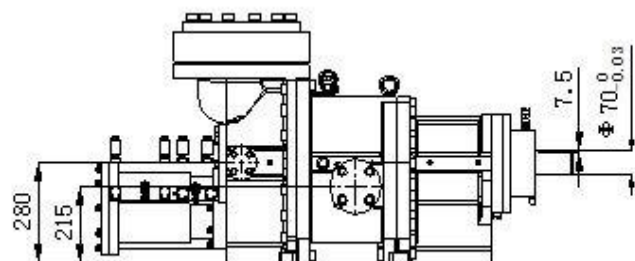

RG1270 Drawing

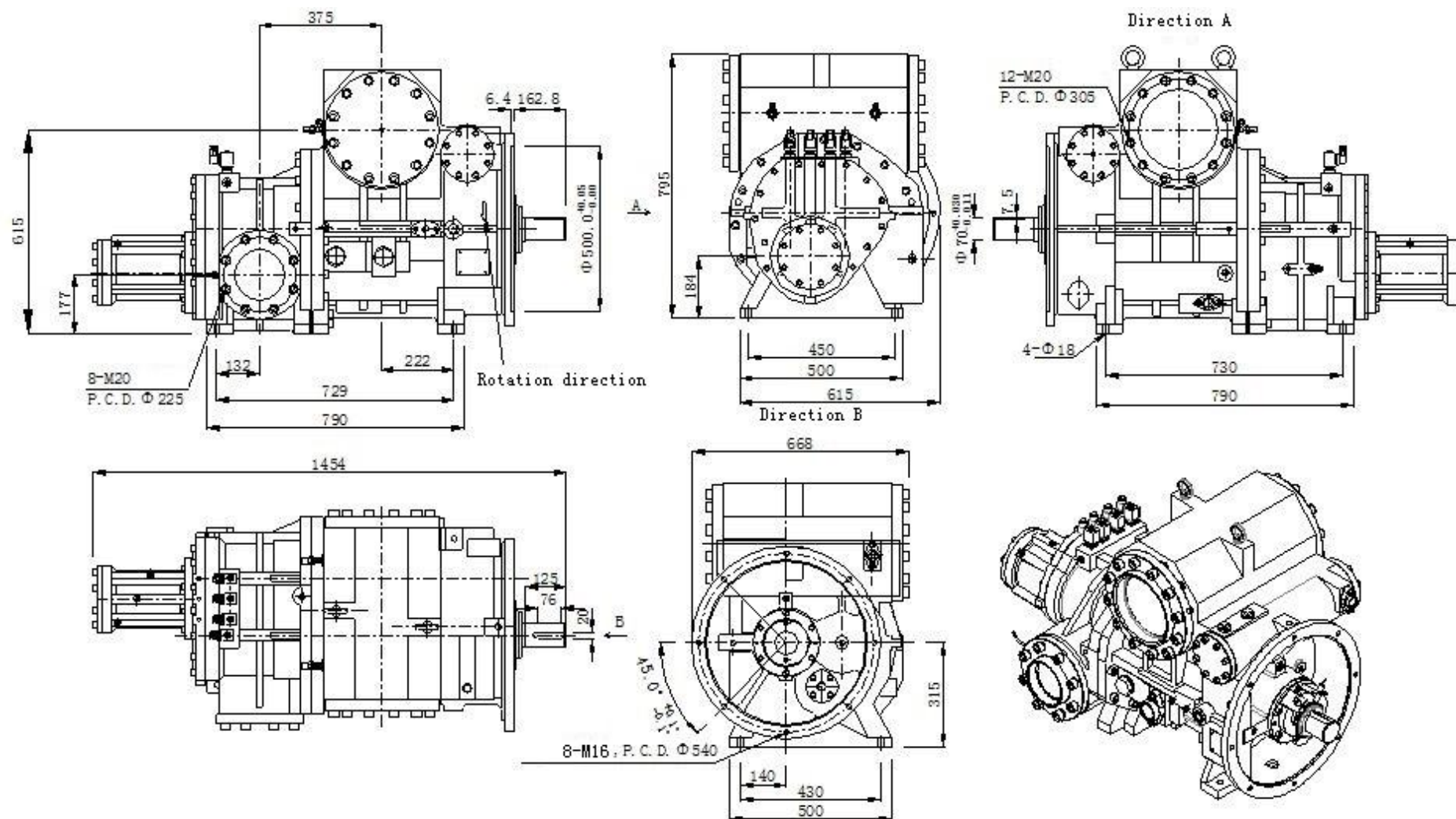

RG1800 Drawing

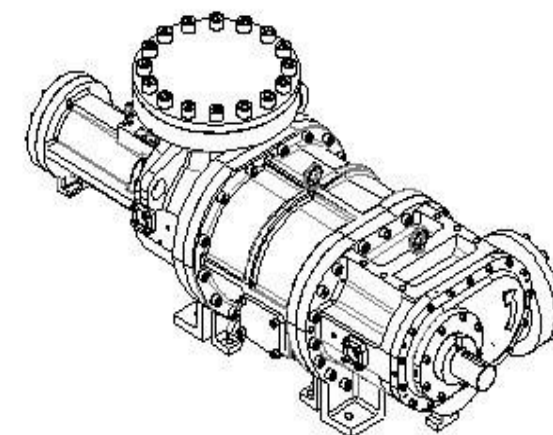
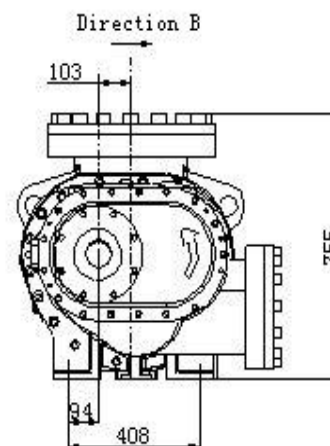
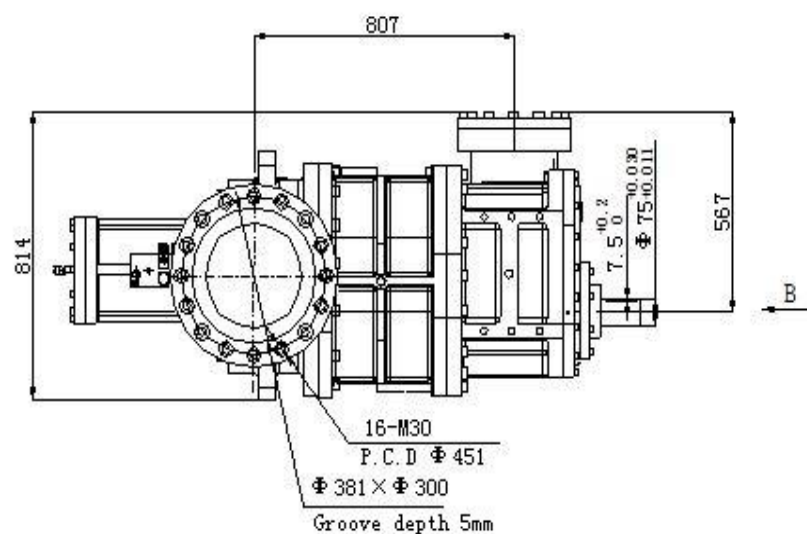
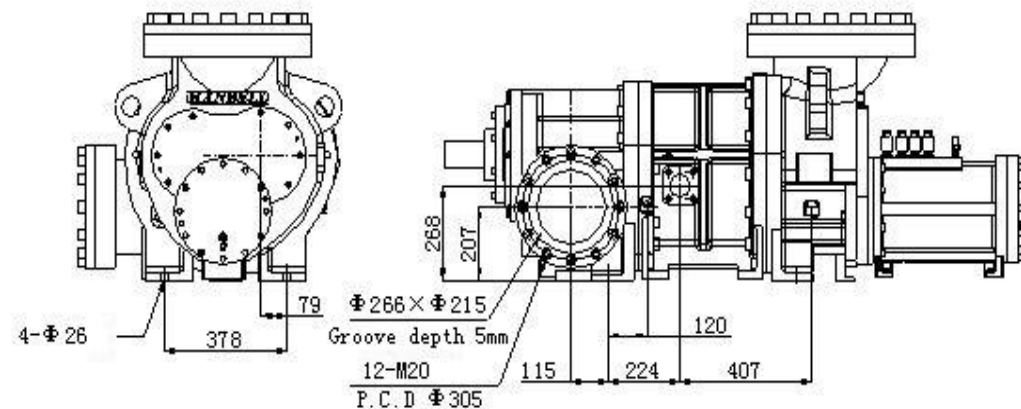
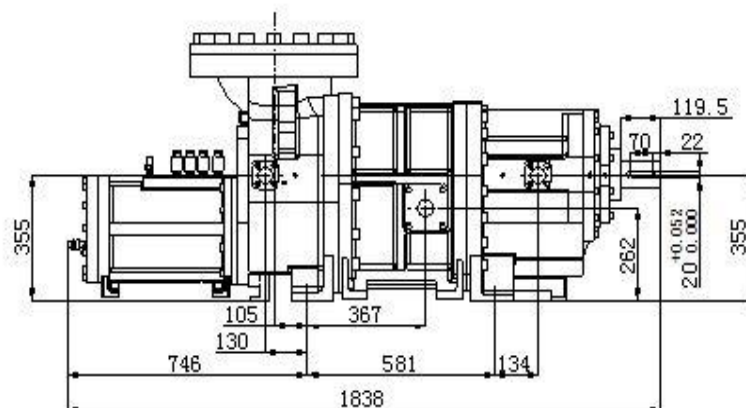

RG2280 Drawing

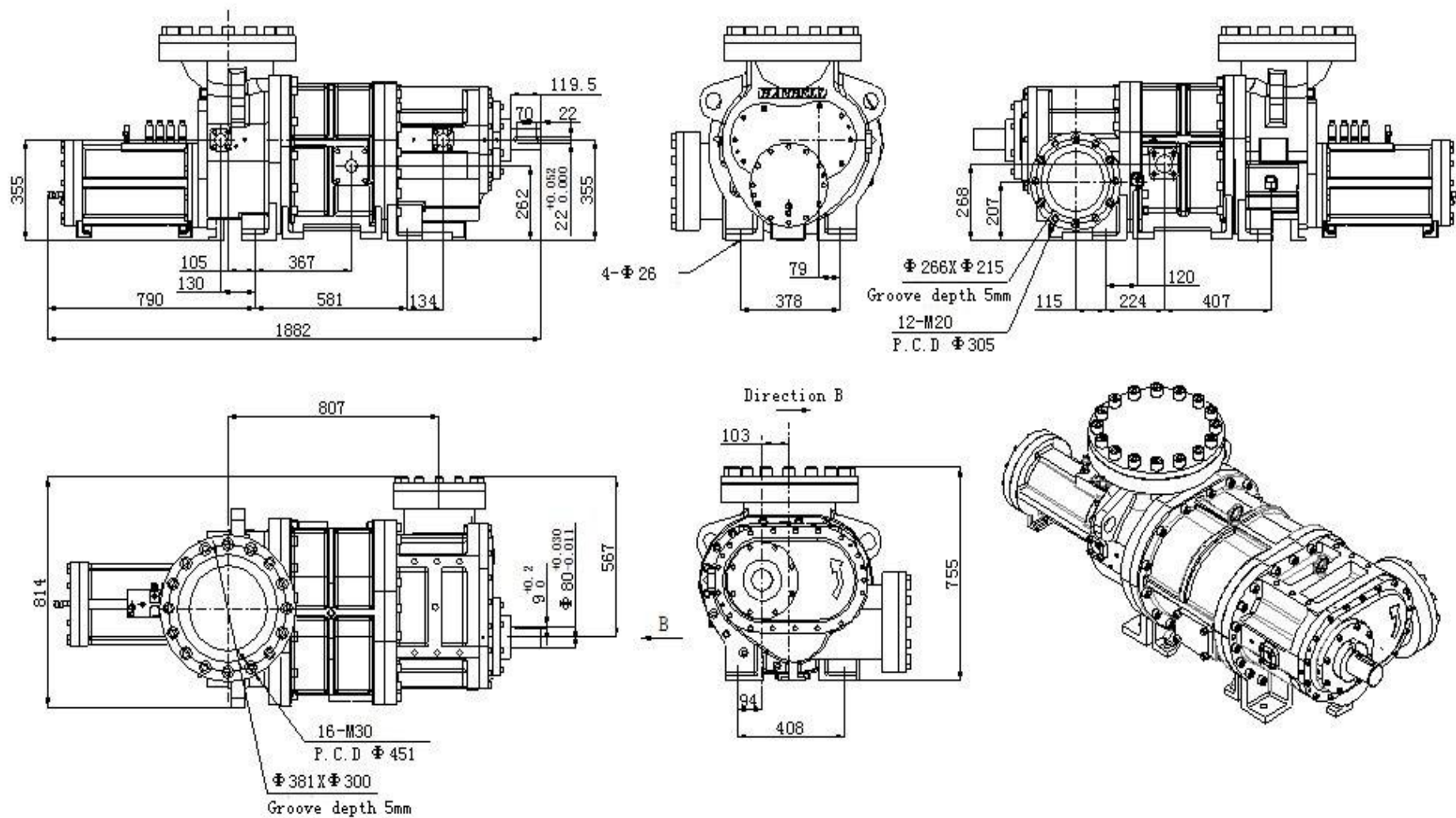

RG2850 Drawing

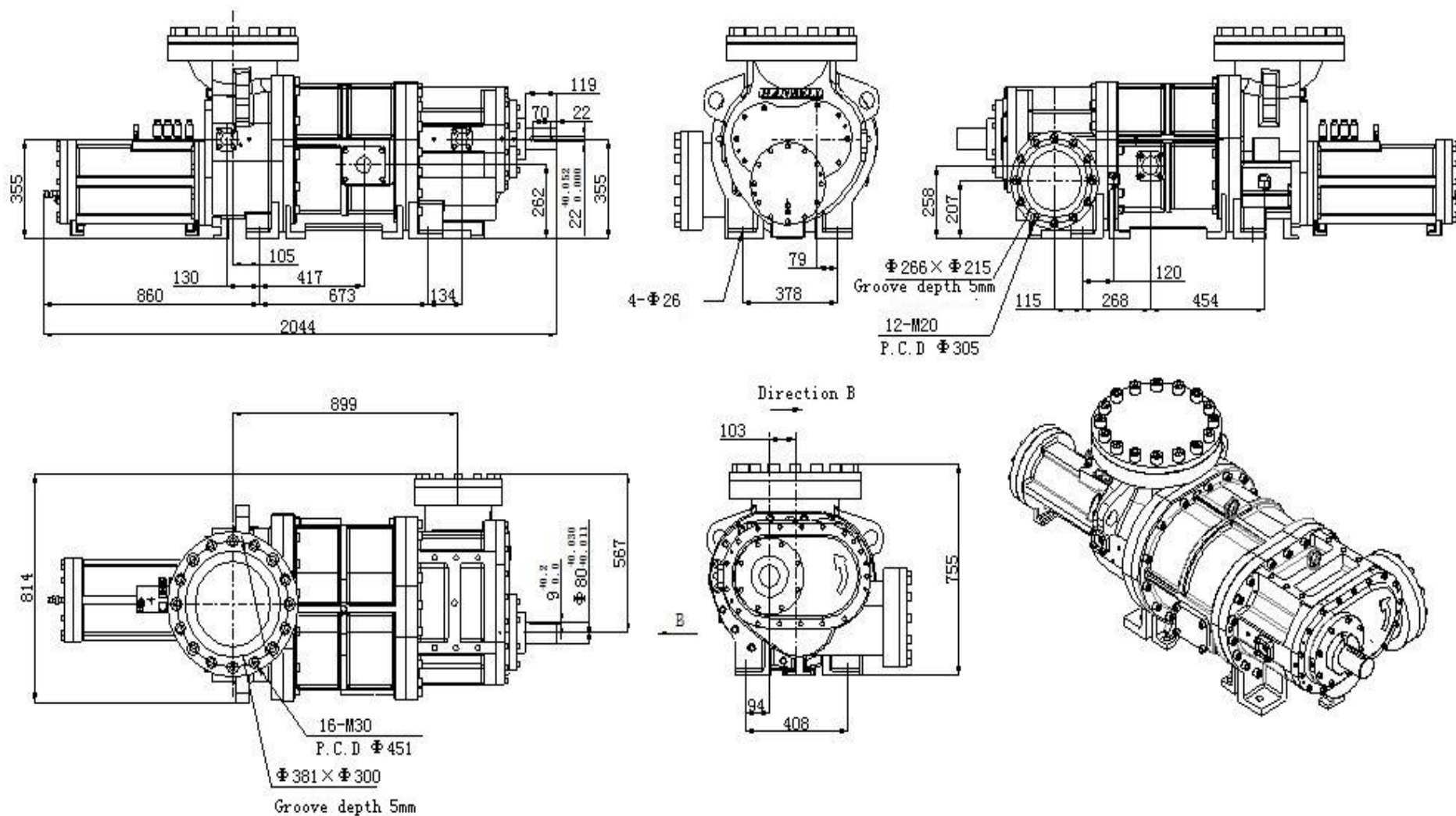

RG200 Drawing

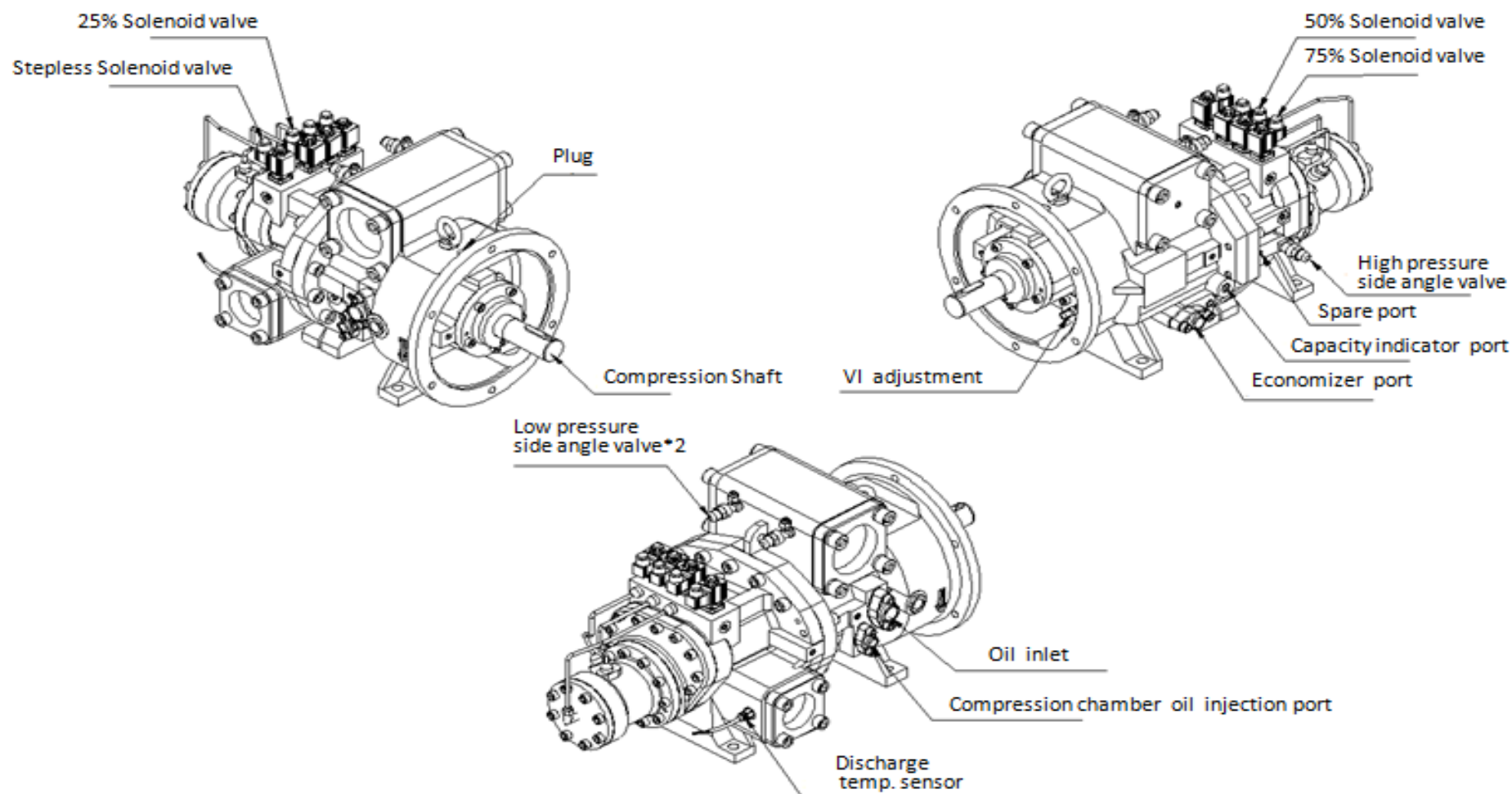

RG410 Drawing

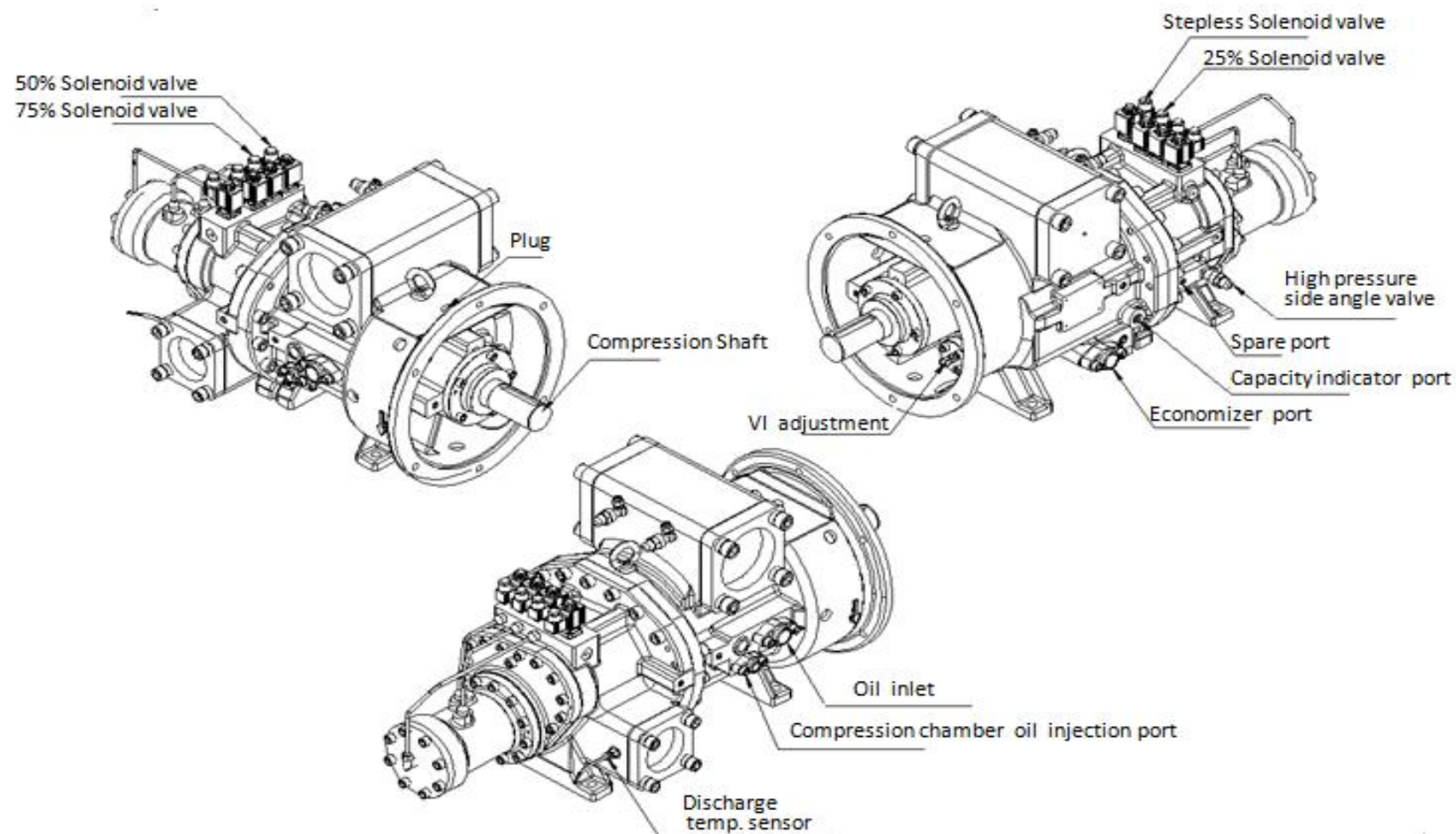

RG620 Drawing

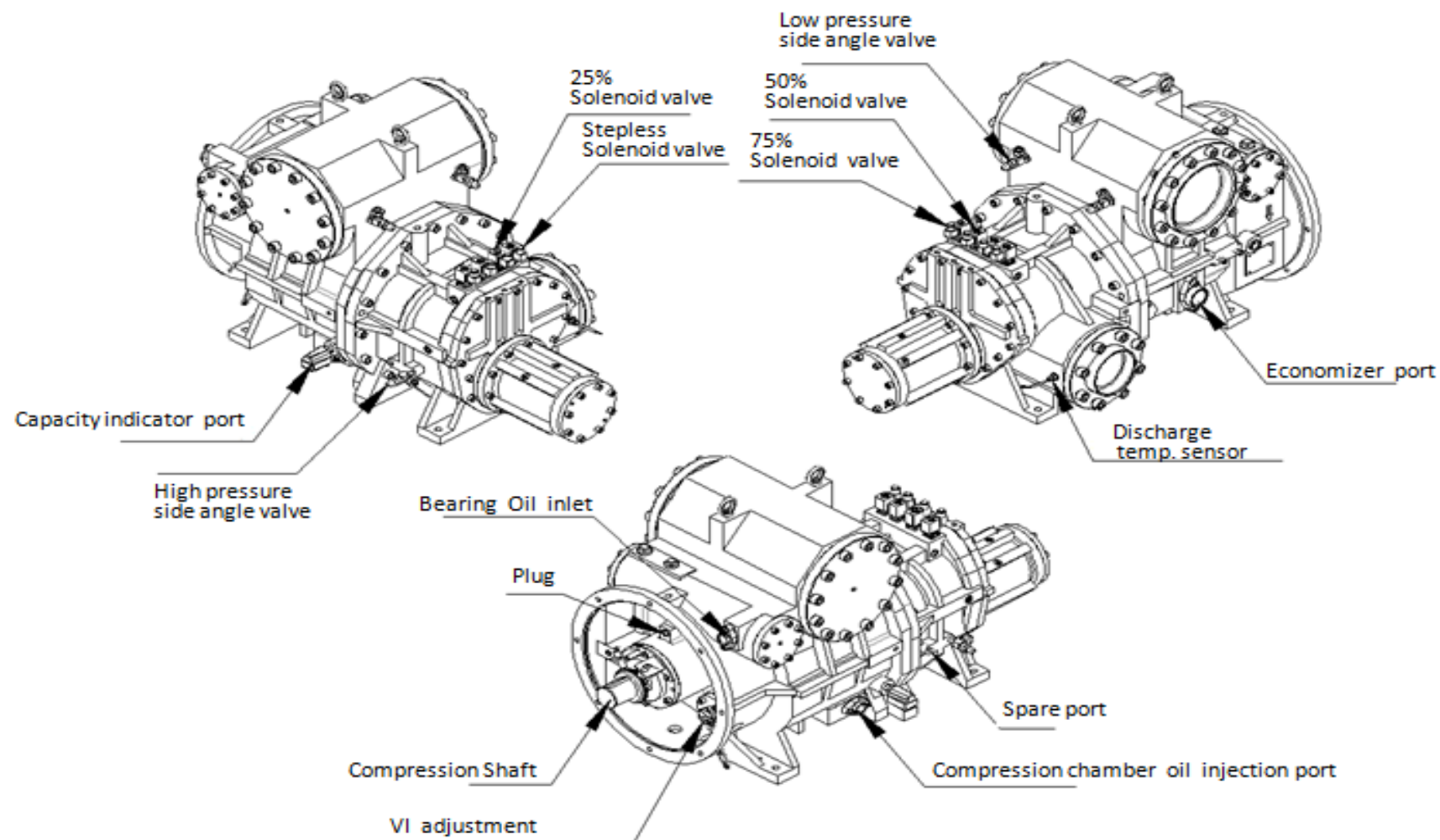

RG830 Drawing

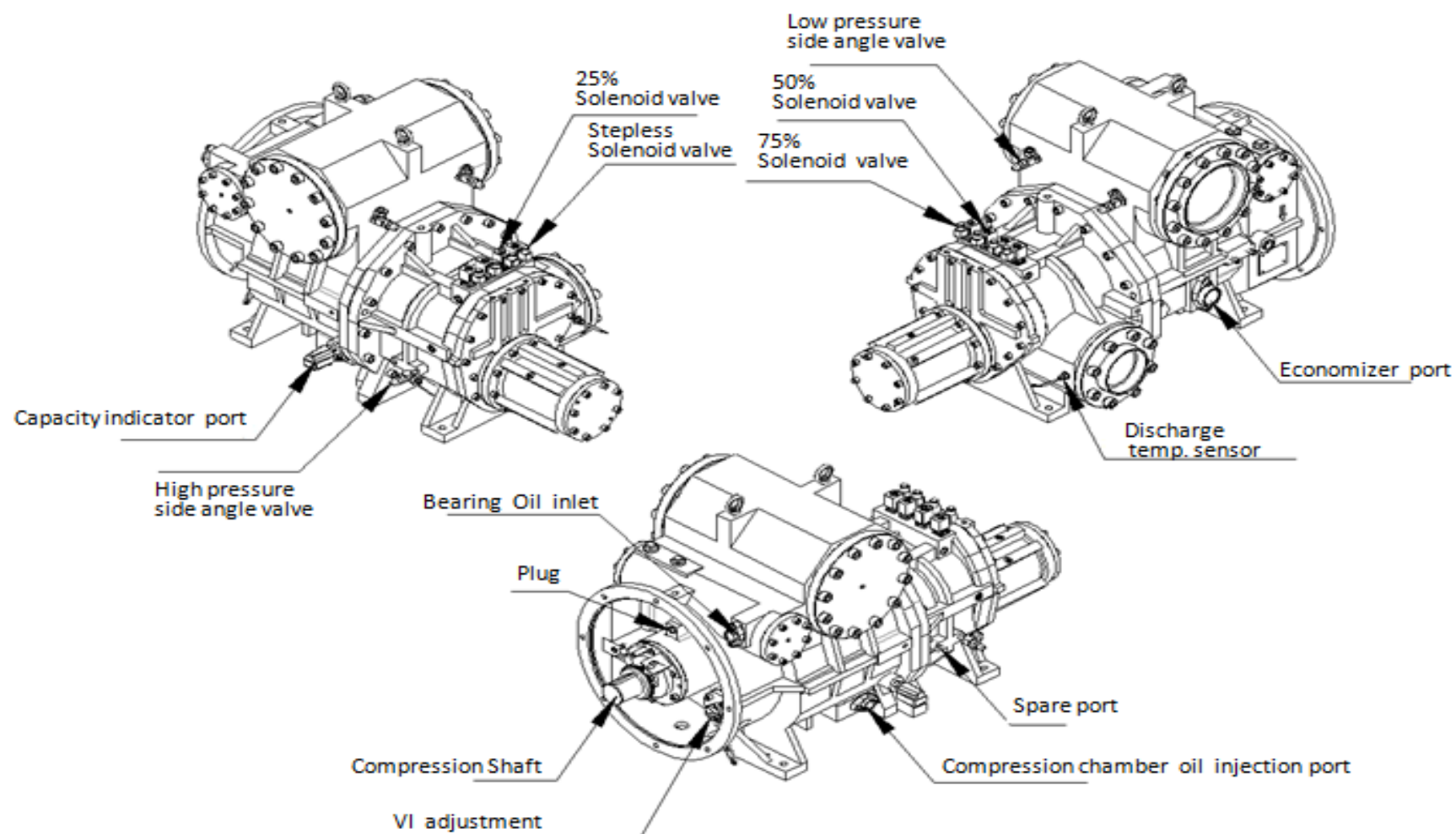

RG1150 Drawing

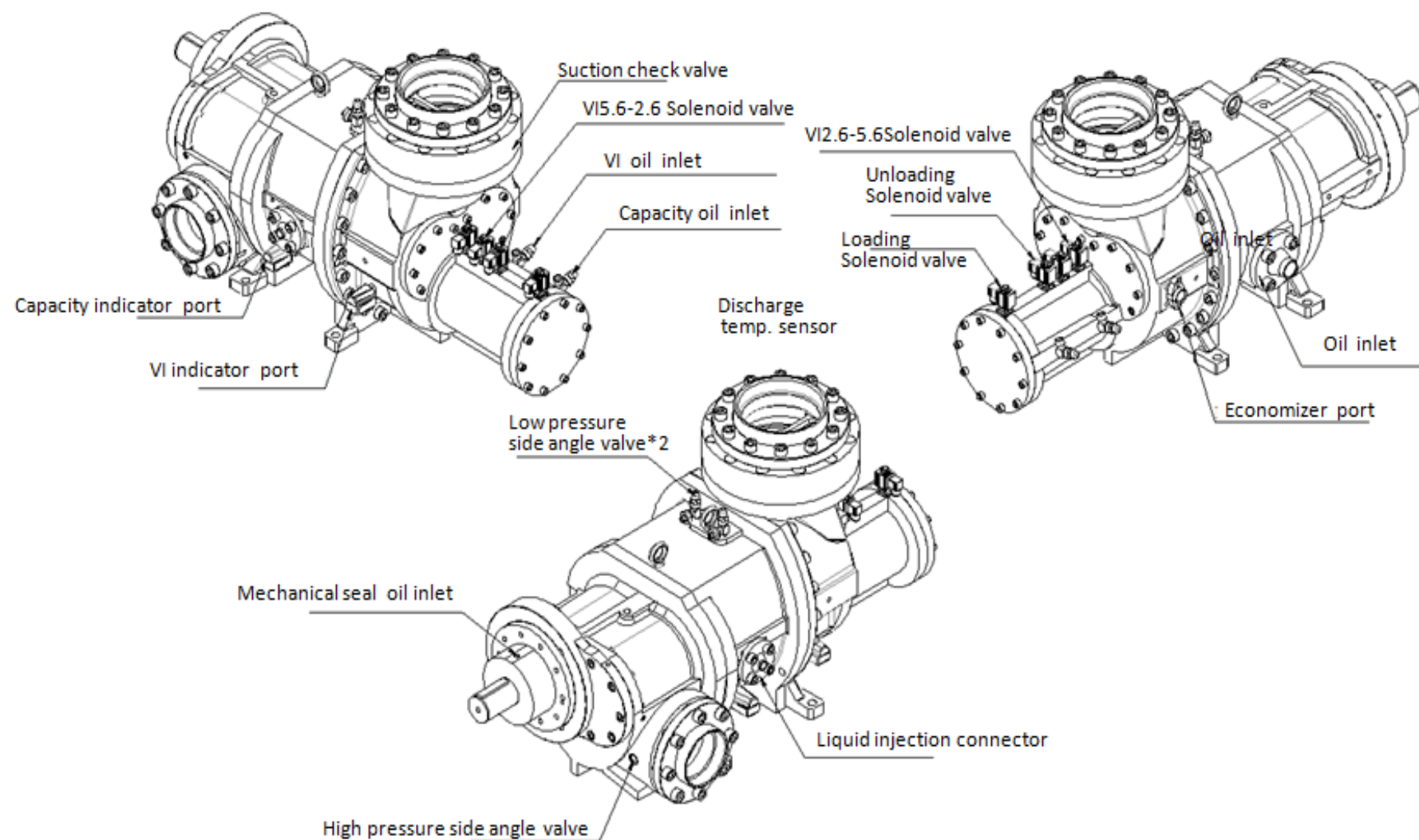

RG1270 Drawing

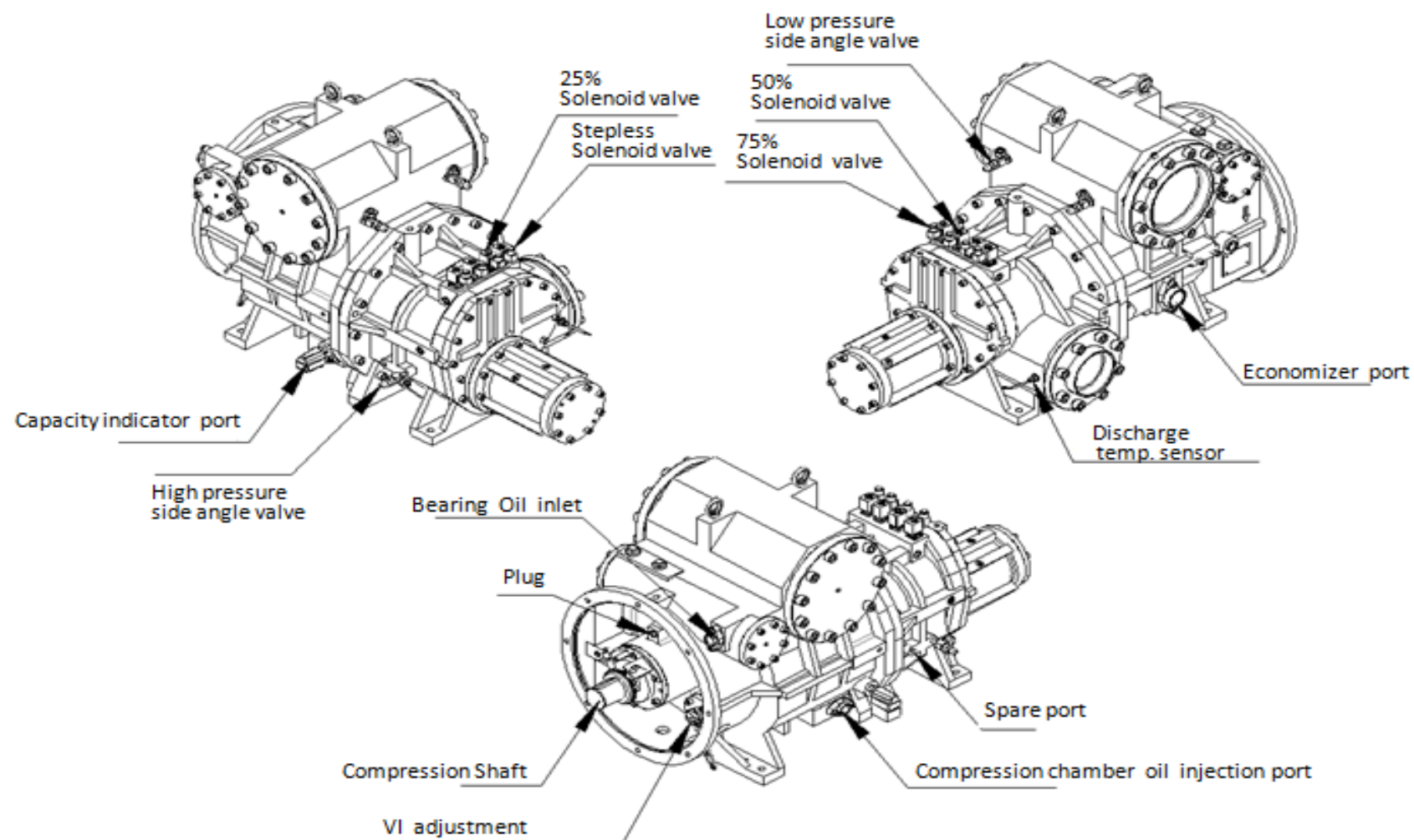

RG1800-2850 Drawing

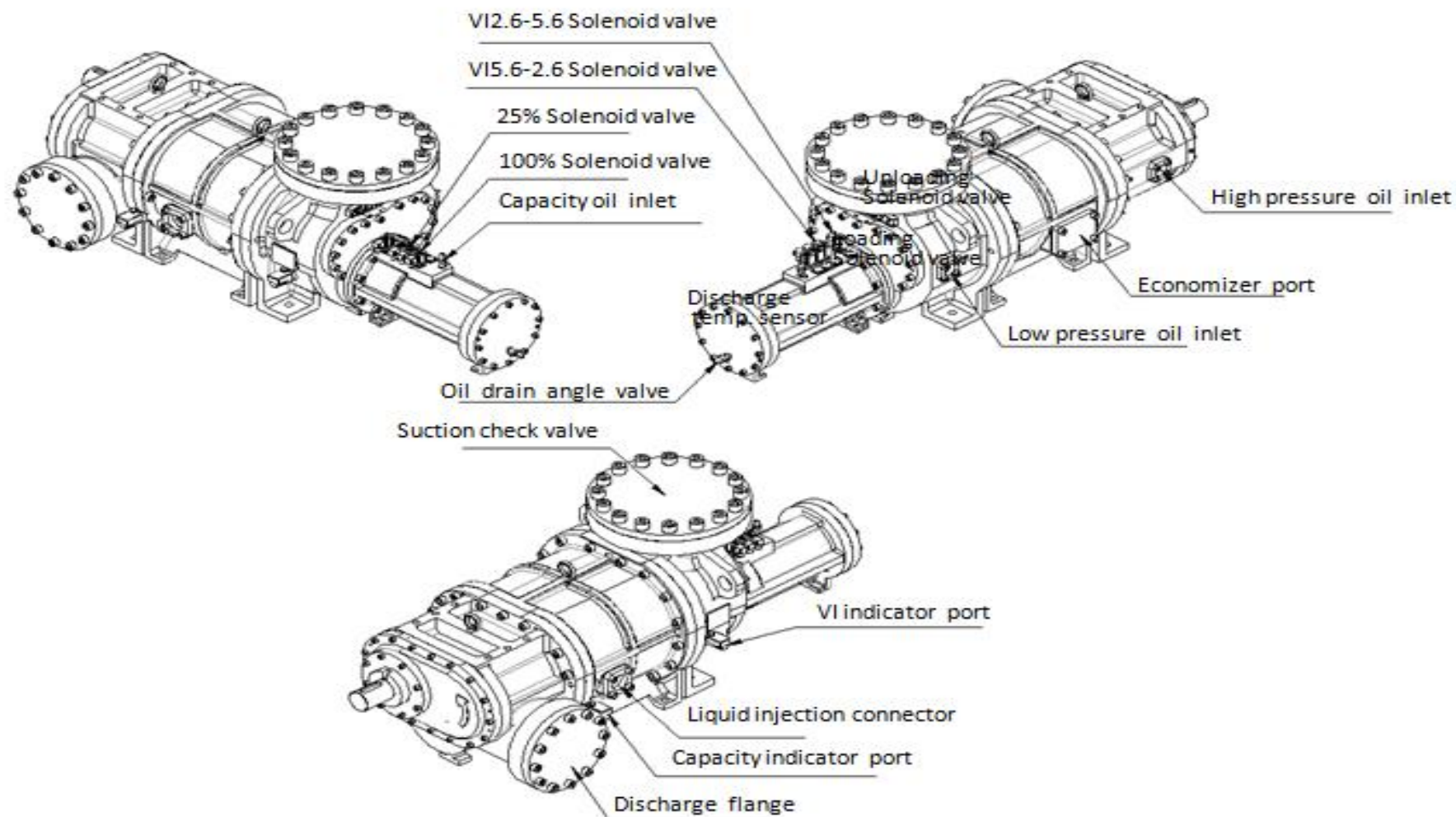

Specification of RG suction/discharge connector

Model	Discharge flange	Steel pipe	Copper pipe	Suction flange	Steel pipe	Copper pipe
RG-200	2" flange	Φ55	Φ61.3	3" flange	Φ80.5	Φ90.2
RG-410	2 1/2" flange	Φ68	Φ77.2	4" flange	Φ93	Φ110
RG-620	3" flange	Φ80.5	Φ90.2	5" flange	Φ106	Φ135
RG-830	4" flange	Φ93	Φ110	5" flange	Φ106	Φ135
RG1150	6" flange	Φ159		8" flange	Φ218	
RG-1270	6" flange	Φ159		8" flange	Φ218	
RG1800~2850	8" flange	Φ218		12" flange	Φ323	

Application Limits

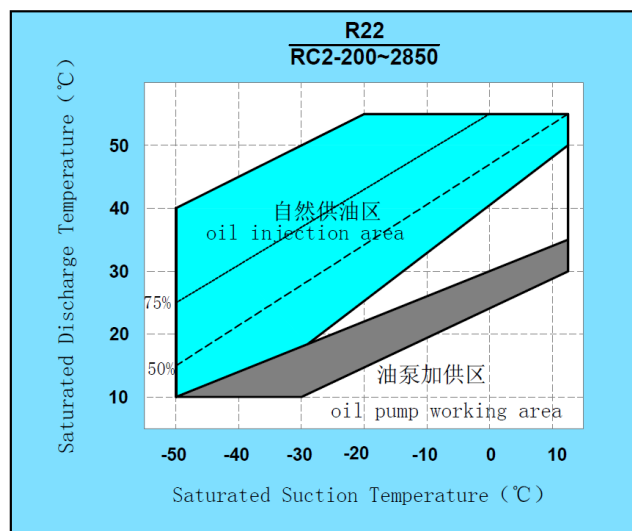
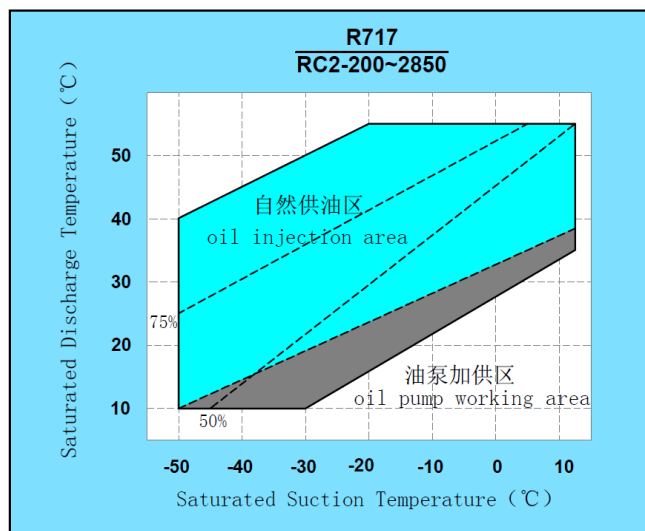

Official website



Official WeChat



Electronic Brochures



上海漢鐘精機股份有限公司

SHANGHAI HANBELL PRECISE MACHINERY CO., LTD.

No.8289, Tingfeng Road, Fengjing Area, Jinshan District, Shanghai, China

TEL: 021-57350280 FAX: 021-51368588

Service Line: 4007702158

P.C.: 201501

<http://www.hanbell.com.cn>

SHANGHAI HANBELL PRECISE MACHINERY CO.,LTD.

JINAN BRANCH

No.4 Building, Liando U Valley International Enterprise Port, No. 2222, South Section of Yuqing Road, Changqing District, Jinan, Shandong Prov.

TEL: 0531-85060075 FAX: 0531-85060071

SHANGHAI HANBELL PRECISE MACHINERY CO.,LTD.

NANJING BRANCH

No.95, Gaohu Road, Jiangning District, Nanjing City

TEL: 025-52078091/1/3 FAX: 025-52078090

SHANGHAI HANBELL PRECISE MACHINERY CO.,LTD.

GUANGZHOU BRANCH

No.15 Wenkeng Road Lianwang Industrial Park, Guangzhou, Guangdong Prov.

TEL: 020-34721075 FAX: 020-3472325

SHANGHAI HANBELL PRECISE MACHINERY CO.,LTD.

CHONGQING BRANCH

Building A10, Dongben Industrial Park, No.18, Yu Ma Road, chayuan New District, Chongqing, China

TEL: 023-62611068 FAX: 023-62611069